



# YOSHIMURA

RESEARCH&DEVELOPMENT OF AMERICA, INC.

5420 DANIELS STREET STE A, CHINO CALIF. 91710 · (800) 634-9166 · (909) 628-4722 · FACSIMILE (909)591-2198

[www.yoshimura-rd.com](http://www.yoshimura-rd.com)

## YOSHIMURA CASE SAVER KIT

**YAMAHA**  
**FZ-07**

**030HA137000**

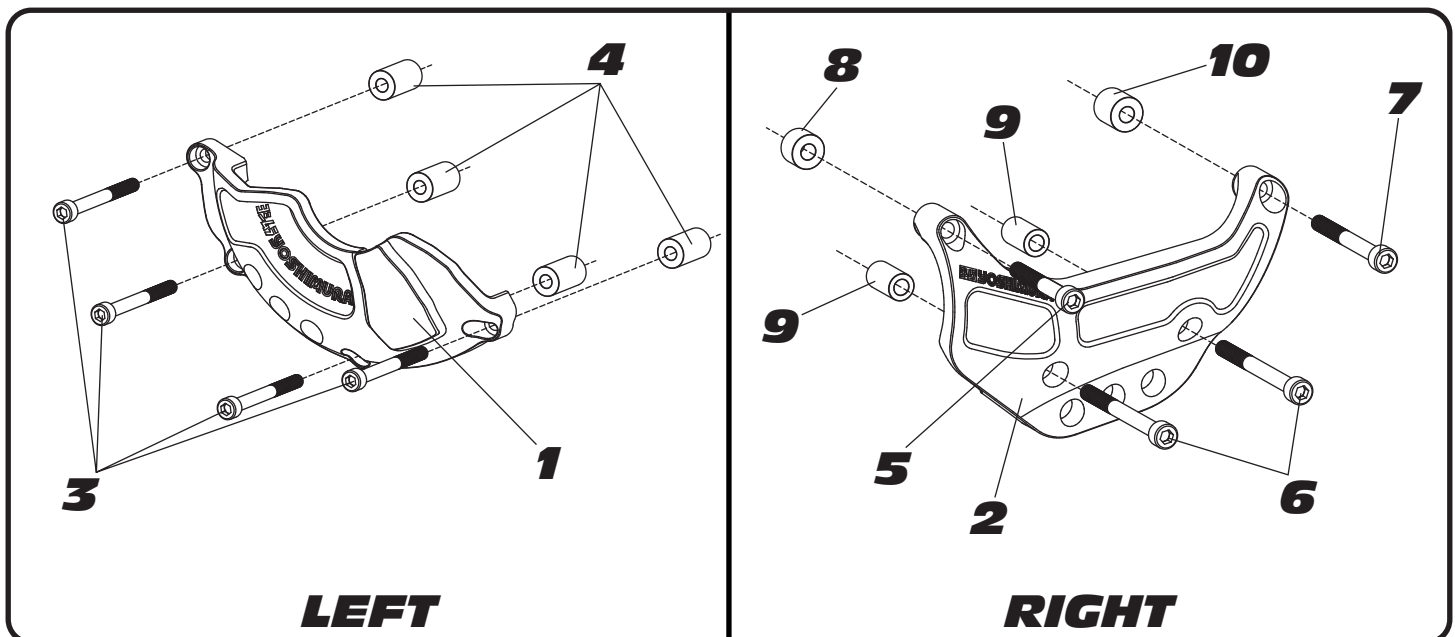

### Part List:

NO.	DESCRIPTION	QTY	PART #
1	Left Case Saver	1	030HA137000L
2	Right Case Saver	1	030HA137000R
3	6mm x 60mm Socket Head Cap Bolt	4	M6X60
4	Aluminum Spacer (25mm)	4	6X14X25SPCRHA
5	6mm x 45mm Socket Head Cap Bolt	1	M6X45
6	6mm x 65mm Socket Head Cap Bolt	2	M6X65
7	6mm x 55mm Socket Head Cap Bolt	1	M6X55
8	Aluminum Spacer (10mm)	1	6X14X10SPCRHA
9	Aluminum Spacer (20mm)	2	6X11X20SPCRHA
10	Aluminum Spacer (15mm)	1	6X14X15SPCRHA
**	Yoshimura Sticker	2	17020C

Yoshimura Case Savers are designed to reduce damage to the engine cases in the event of a light or mild crash ONLY. The Case Savers are not designed to prevent damage to the engine cases completely, nor are they designed to prevent damage to fairings or body work.

**Read through all instructions before beginning installation be sure to prepare a clean work area. Take necessary safety precautions to ensure a safe working environment. Always use a bike stand whenever available.**

## **Tools Required:**

Metric Socket Set  
Ratchet and Extension  
Metric Allen Socket Set  
Torque Wrench

## **Installation Steps:**

1. Remove the four specified left side engine cover bolts.

*Note<sup>1</sup>: Do not remove engine cover.*

*Note<sup>2</sup>: It is recommended to place bike on rearstand. Engine oil may leak from the two lower case bolts circled in the diagram if leaned over onto the kickstand.*

2. Install Yoshimura left side case saver using the four supplied 6mm x 60mm bolts and 25mm aluminum spacers as shown on the diagram on page 1.

3. Torque bolts to factory specification.

4. Remove the four specified right side engine cover bolts.

*Note: Do not remove engine cover.*

5. Install Yoshimura right side case saver using the supplied bolts and aluminum spacers. See diagram on page 1 for proper orientation and order of hardware.

6. Torque bolts to factory specification.

