



CHASSIS PROTECTOR KIT

APPLICATION

YEAR	MODEL
2013-2014	Honda CB500F
2013-2014	Honda CB500X
PRODUCT	CB500F/X Chassis Protector Kit

 Read through all instructions before beginning installation. Motorcycle can be extremely hot. Let motorcycle cool down before beginning installation. Always wear hand and eye protection and take precautionary measures to avoid injury.

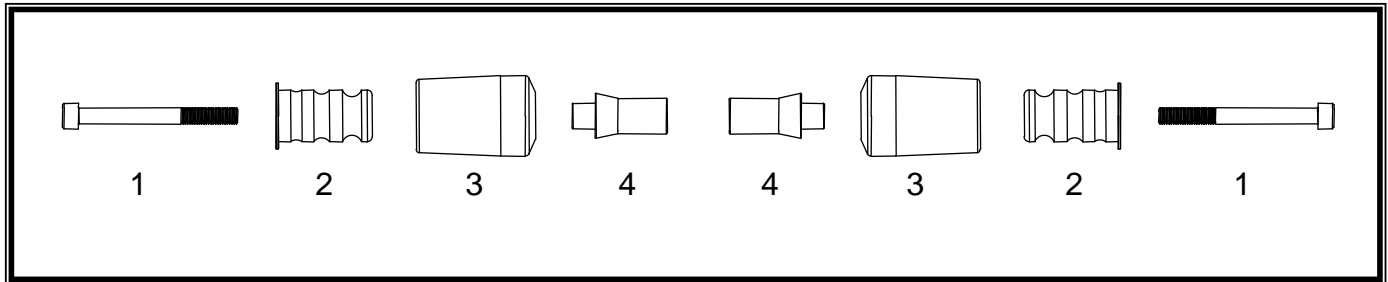

No.	Part #	Description	Qty
1	M10X100	10mm x 100mm Socket Head Cap Bolt	2
2	040BG-MLI-10	Aluminum Insert	2
3	040BG-ML	Chassis Protector	2
4	040BG140700SL	Aluminum Spacer	2
**	17020C	Sticker Sheet	2

-TOOLS REQUIRED-

Metric Socket Set • Combination Wrench Set • Torque Wrench • Metric Allen Wrench Set

-INSTALLATION-

1. Remove right side engine mount bolt.
2. Install Yoshimura chassis protector on left side according to the diagram using the provided hardware. Torque to factory specification.
3. Remove left side engine mount bolt.
4. Install Yoshimura chassis protector on right side according to the diagram using the provided hardware. Torque to factory specification.

IMPORTANT NOTE: Install Yoshimura chassis protector one side at a time. DO NOT remove both left and right engine mount bolts simultaneously. Doing so may cause engine to sag or drop and as a result the mounting holes may be misaligned.