



# CHASSIS PROTECTOR KIT

**APPLICATION**

<b>YEAR</b>	<b>MODEL</b>
2009-2012	Kawasaki ZX6R

**PRODUCT**

040BG146400	Kawasaki ZX6R Chassis Protector Kit
-------------	-------------------------------------

**!** Read through all instructions before beginning installation. Exhaust system can be extremely hot. Let motorcycle cool down before beginning installation. Always wear hand and eye protection and take precautionary measures to avoid injury.

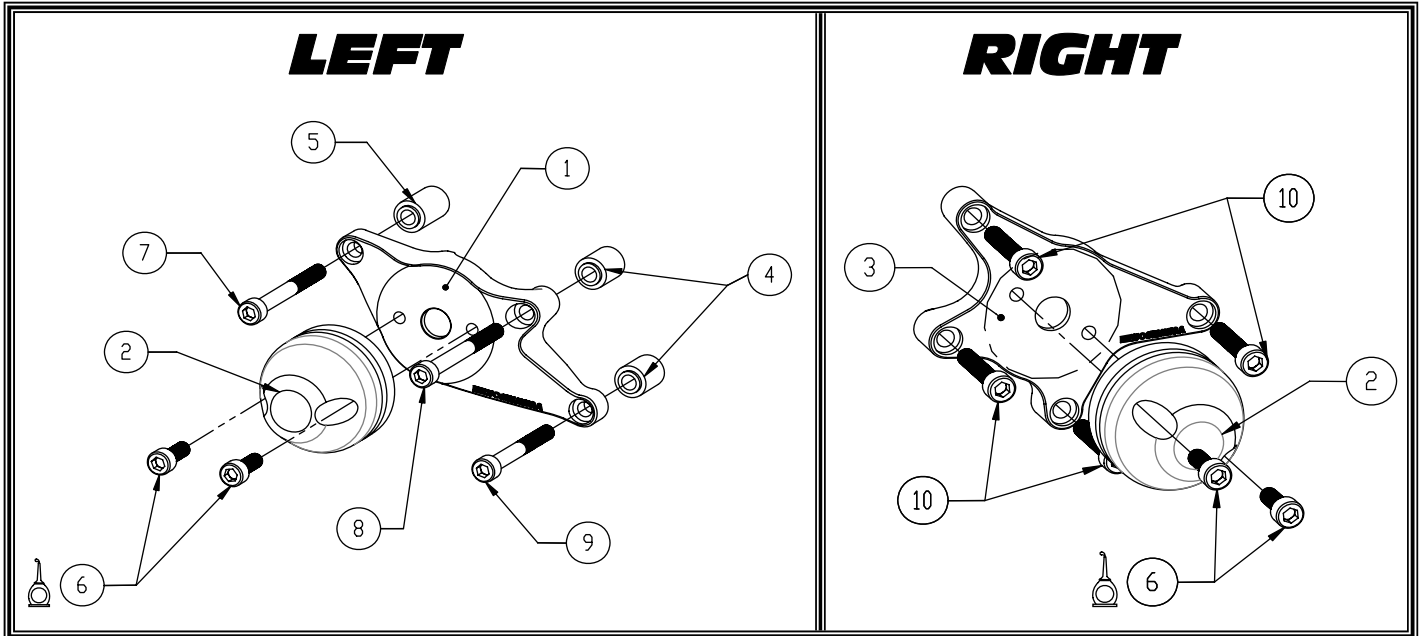

No.	Part #	Description	Qty
1	14640-CSBRKT-L	Left Chassis Protector Bracket	1
2	040BG-MB	Chassis Protector	2
3	14640-CSBRKT-R	Right Chassis Protector Bracket	1
4	14640-CS-SPCR2	Small Aluminum Spacer	2
5	14640-CS-SPCR1	Large Aluminum Spacer	1
6	M6X16	6mm x 16mm Socket Head Cap Screw	4
7	M6X55	6mm x 55mm Socket Head Cap Screw	1
8	M6X60	6mm x 60mm Socket Head Cap Screw	1
9	M6X50	6mm x 50mm Socket Head Cap Screw	1
10	M6X30	6mm x 30mm Socket Head Cap Screw	4
**	R-K880ND	Med. Strength Thread Lock	1
**	17020C	Yoshimura Sticker Sheet	2

**-TOOLS REQUIRED-**

*Metric Socket Set • Combination Wrench Set • Torque Wrench • Metric Allen Wrench Set*

**-INSTALLATION-**

- 1. Remove the top (3) left side engine case bolts.**
- 2. Using the hardware provided, assemble and install Yoshimura left side chassis protector according to the parts diagram. Note the proper orientation and order of hardware.**



**Note:** Apply provided medium strength thread lock to (2) M6X16 bolts that secure chassis protector to chassis protector bracket.

- 3. Remove the (4) right side starter cover bolts.**  
**Note:** The Yoshimura Chassis Protector is designed to be used with the (2) stock copper washers. Inspect for damage and replace if necessary.
- 4. Assemble and install Yoshimura right side chassis protector along with the stock copper washers. See diagram for proper orientation of hardware.**

**Note<sup>1</sup>:** There are two arrows on the starter cover where the copper washers are to be installed.



**Note<sup>2</sup>:** Apply provided medium strength thread lock to (2) M6X16 bolts that secure chassis protector to chassis protector bracket.

- 5. Torque bolts to factory specification.**