



CHASSIS PROTECTOR KIT

APPLICATION

YEAR	MODEL
2012-2014	Kawasaki Ninja650
PRODUCT	
040BG146500	Kawasaki Ninja650 Chassis Protector Kit

 Read through all instructions before beginning installation. Motorcycle can be extremely hot. Let motorcycle cool down before beginning installation. Always wear hand and eye protection and take precautionary measures to avoid injury.

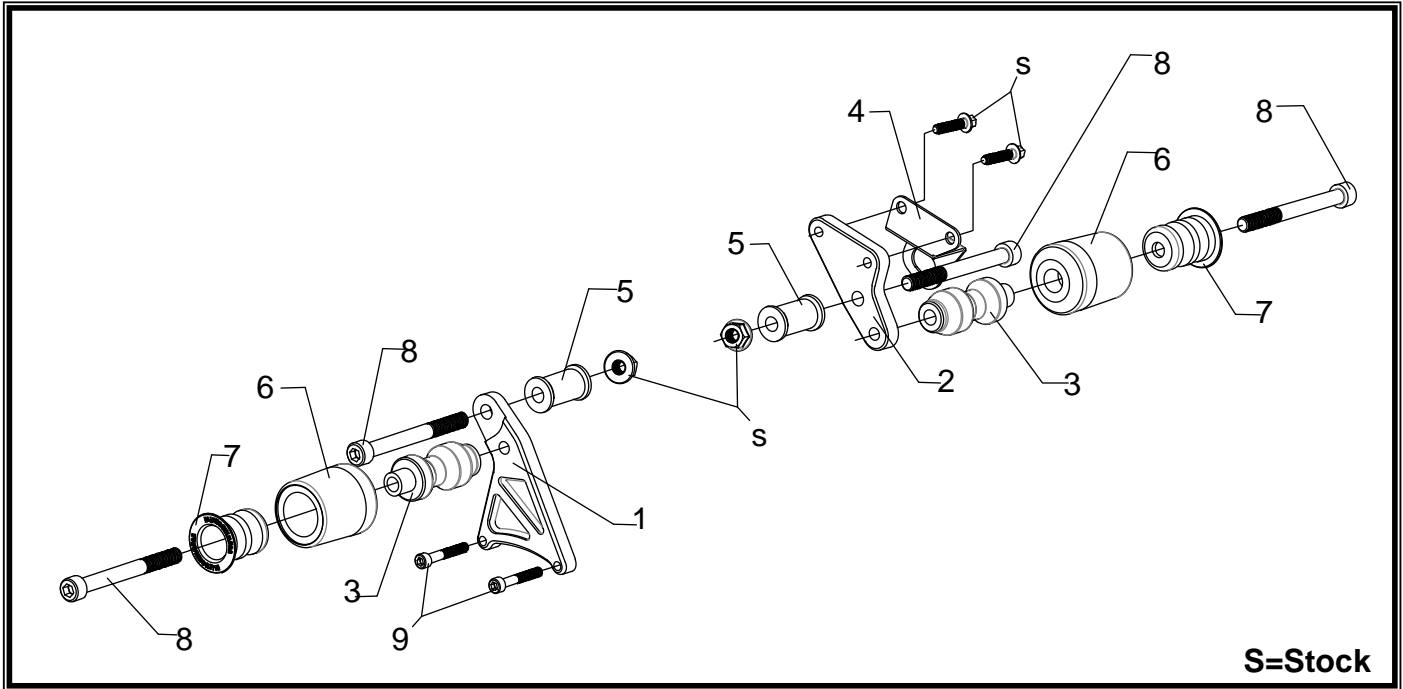

S=Stock

No.	Part #	Description	Qty
1	14650-CPBKT-L	Left Chassis Protector Bracket	1
2	14650-CPBKT-R	Right Chassis Protector Bracket	1
3	14650-CHS-SPR	Left & Right Chassis Protector Spacer	2
4	14650-CPMB-R	Fairing Mount Bracket	1
5	14650-CP-SPCR	Aluminum Spacer	2
6	1115-A03-01	Chassis Protector	2
7	1115-A03-01-IK	Aluminum Insert	2
8	M10X100	10mm x 100mm Socket Head Cap Screw	4
9	M6X40	6mm x 40mm Socket Head Cap Screw	2
**	17020C	Sticker Sheet	2

-TOOLS REQUIRED-

Metric Socket Set
Combination Wrench Set
Torque Wrench
Metric Allen Wrench Set

-INSTALLATION-

1. Remove left side fairing as per Factory Service or Owners Manual.
2. Remove left side engine mount bolt.

IMPORTANT: INSTALL CHASSIS PROTECTOR ONE SIDE AT A TIME. REMOVING BOTH LEFT AND RIGHT ENGINE MOUNT BOLTS SIMULTANEOUSLY MAY CAUSE ENGINE TO SAG OR DROP RESULTING IN MOUNTING HOLES TO BE MISALIGNED.

3. Remove the (2) left side engine case bolts shown in Fig. 1.
4. Using the hardware provided in the kit, install left side chassis protector as shown on the parts diagram using the stock nut. Torque bolts to factory specifications.
5. Reinstall left side fairing using the opposite steps of removal.



Fig. 1 Left Side

6. Remove right side fairing as per Factory Service or Owners Manual.
7. Remove right side engine mount bolt.
8. Remove the (2) bolts securing engine bracket onto frame.
Note: The stock engine bracket will not be reused.
9. Remove the stock rubber grommet from the stock right side engine bracket and install onto Yoshimura fairing mount bracket.
10. Install provided right side chassis protector bracket and fairing mount bracket using the (2) stock bolts. See diagram for proper orientation.
11. Using the hardware provided in the kit, install right side chassis protector as shown on the parts diagram. Torque bolts to factory specification.
12. Reinstall right side fairing using the opposite steps of removal.



Fig. 2 Right Side