



# YOSHIMURA

RESEARCH&DEVELOPMENT OF AMERICA, INC.

5420 DANIELS STREET STE A, CHINO CALIF. 91710 · (800)634-9166 · (909)628-4722 · FACSIMILE (909)591-2198

[www.yoshimura-rd.com](http://www.yoshimura-rd.com)

## CHASSIS PROTECTOR SET

**SUZUKI**  
**GSX-R600/750**

**040HA110400**

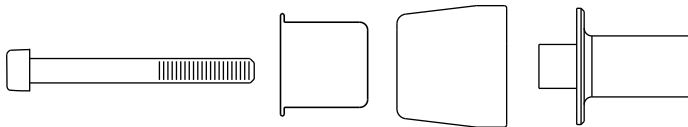

1            2            3            4

Left Side Chassis Protector

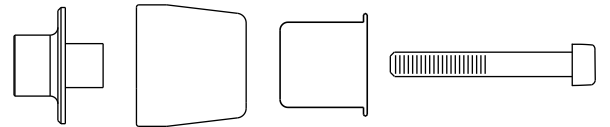

5            3            2            6

Right Side Chassis Protector

### Part List:

NO.	DESCRIPTION	QTY	PART #
1	10mm x 110mm Socket Head Cap Screw	1	M10X1.25X110
2	Aluminum Insert for 040BG-MS	2	040HA-MSI-10
3	Chassis Protector Black	2	040BG-MS
4	Aluminum Spacer (Left Side)	1	040HA110400SL
5	Aluminum Spacer (Right Side)	1	040HA110400SR
6	10mm x 90mm Socket Head Cap Screw	1	M10X1.25xX90
**	Yoshimura Sticker	2	17020C

**Note: Read through all instructions before beginning installation.**

**Tools Needed:**

Allen Wrench Set (Metric)

Socket Set (Metric)

Ratchet

Extension

Masking Tape

Drill

Drill Bit Set

1" Hole Saw

Torque Wrench

**Installation Steps:**

- 1 *Install right side chassis protector with aluminum spacer into the right engine mount using the supplied 10mm x 90mm bolt and aluminum insert. Torque bolt to 5.5 kgf-m (39.8 lb-ft).*
- 2 *Remove bottom left fairing and remove the stock engine mount bolt that is in the left chassis protector mounting location.*
- 3 *Insert drill bit into the engine mounting hole with the tip facing out (use a drill bit that matches the size of the engine mounting hole).*
- 4 *Reinstall left fairing and press the drill bit against the inside of the fairing and turn the drill bit to mark the exact location for the pilot hole.*
- 5 *Remove the left fairing and using the mark you just made as a guide, drill a small pilot hole.*
- 6 *Reinstall the left fairing and make sure the pilot hole lines up perfectly with the engine mount hole.*
- 7 *Remove the left fairing and tape the area around the pilot hole with masking tape.*
- 8 *Using a 1" hole saw, cut a 1" hole in the fairing using the pilot hole as a guide.*
- 9 *Remove the masking tape and reinstall the left fairing.*
- 10 *Install the left chassis protector with aluminum spacer into the left engine mount using the supplied 10mm x 110mm bolt and aluminum insert. Torque bolt to 5.5 kgf-m (39.8 lb-ft).*

**IMPORTANT NOTE:** *Install Yoshimura Chassis Protector one side at a time. Removing both engine mount bolts simultaneously may cause engine to sag or drop causing mounting holes to be misaligned.*