



Fender Eliminator Kit

APPLICATION

YEAR	MODEL
2009-2012	Suzuki GSXR 1000
PRODUCT	
070BG111800	Fender Eliminator Kit

! This product is not DOT approved. Yoshimura R&D of America, Inc. is not liable or responsible for any resulting event caused by the installation of this product. Check with local laws and regulations for compliance prior to installation and use. This product is not intended for use on public highways.

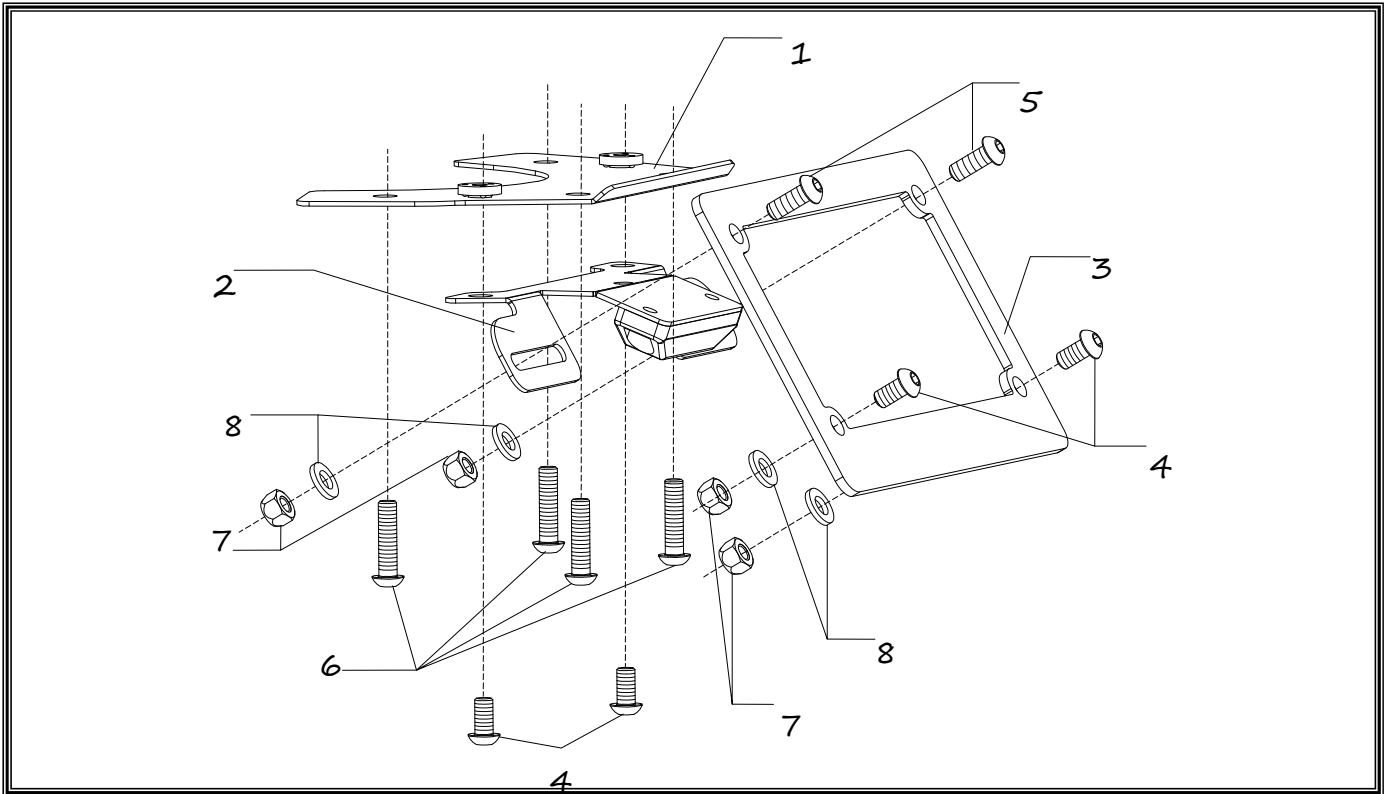

No.	Part #	Description	Qty
1	1118-FEB	Yoshimura Fender Eliminator Bracket	1
2	070BG-LPB1-01	Yoshimura License Plate Bracket	1
3	070BG-LPF	Yoshimura License Plate Frame	1
4	M6X12BHS	6mm x 12mm Button Head Screw	4
5	M6X16BHS	6mm x 16mm Button Head Screw	2
6	M6X25BHS	6mm x 25mm Button Head Screw	4
7	6MMLN	6mm Nylon Lock Nut	4
8	6MMWASHER	6mm Washer	4
**	94785-01-ND	Butt Connectors	2
**	17029	Yoshimura Sticker Sheet	1

-TOOLS REQUIRED-

Metric Socket Set

Combination Wrench Set

Metric Allen Wrench Set

-REMOVAL-

- 1. Remove left side cowling from the tail section and disconnect the license plate light connector.**
- 2. Remove the stock fender by removing the (4) bolts.**
- 3. Cut the stock license plate light connector from the stock fender. BE SURE TO CUT AT LEAST A 6" SECTION OF WIRE FROM THE CONNECTOR.**

-INSTALLATION-

- 1. Using the connectors provided in the kit, connect the Yoshimura Fender Eliminator wires to the stock license plate light connector as follows: Red wire goes to Gray wire; Black wire goes to Black w/ White stripe.**
- 2. Install Yoshimura Fender Eliminator kit as shown in the parts diagram.**
- 3. Route wiring through hole in bracket, then through tail section to stock location. Connect license plate light connector to stock harness.**
- 4. Check for function of license plate light and that all brackets and pieces are secure prior to riding.**