



# Fender Eliminator Kit

**APPLICATION**

YEAR	MODEL
2008-2010	Suzuki GSXR 600/750
PRODUCT	
070BG117000	Fender Eliminator Kit

**!** This product is not DOT approved. Yoshimura R&D of America, Inc. is not liable or responsible for any resulting event caused by the installation of this product. Check with local laws and regulations for compliance prior to installation and use. This product is not intended for use on public highways.

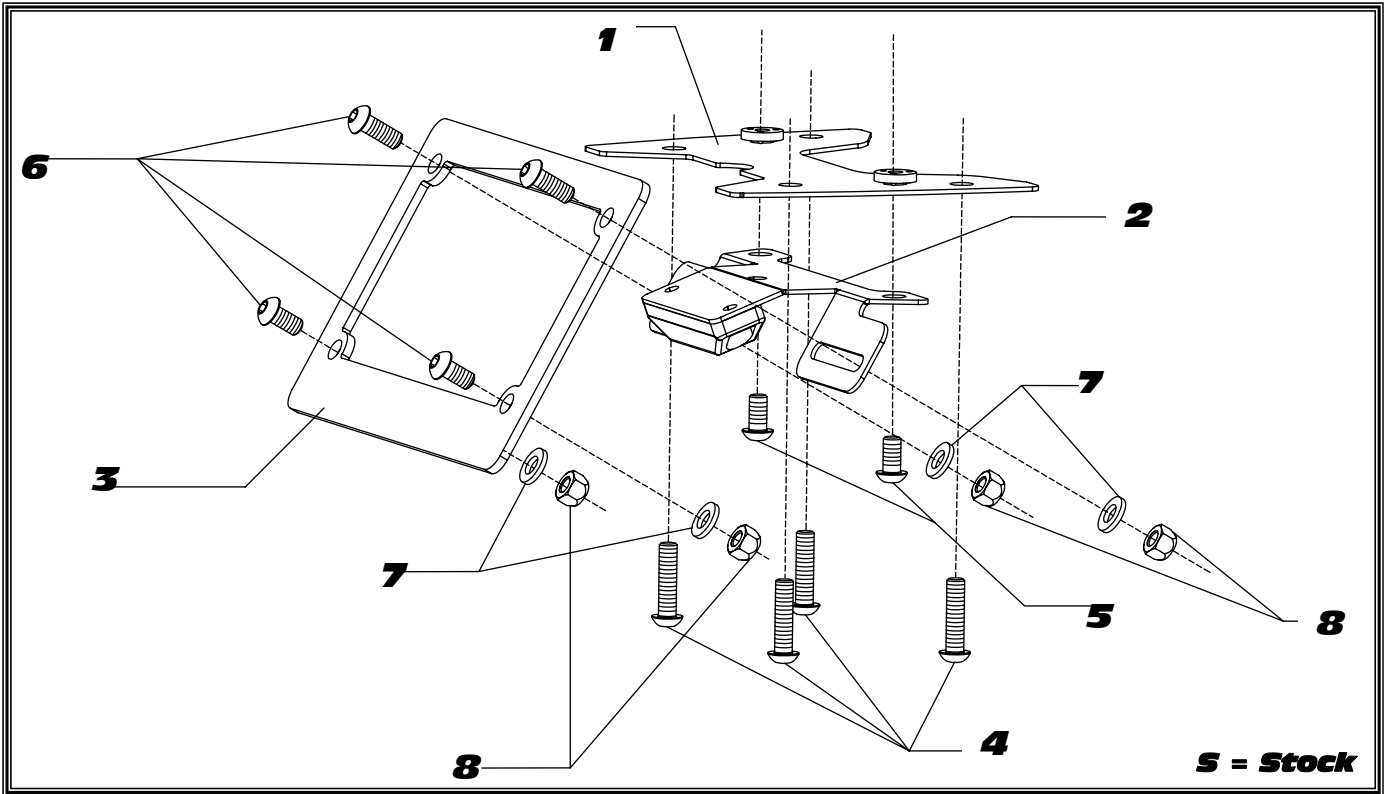

No.	Part #	Description	Qty
1	1170-FEB	Yoshimura Fender Eliminator Bracket	1
2	070BG-LPB1-01	Yoshimura License Plate Bracket	1
3	070BG-LPF	Yoshimura Aluminum License Plate Frame	1
4	M6X25BHS	6mm x 25mm Button Head Screw	4
5	M6X16BHS	6mm x 16mm Button Head Screw	2
6	M6X12BHS	6mm x 12mm Button Head Screw	4
7	6MMWASHER	6mm Washer	4
8	6MMLN	Nylon Lock Nut	4
**	94785-01-ND	Butt Connectors	2
**	17029	Yoshimura Sticker Sheet	1

***-TOOLS REQUIRED-***

*Metric Socket Set*

*Combination Wrench Set*

*Metric Allen Wrench Set*

***-REMOVAL-***

- 1. Remove left side cowling from the tail section and disconnect license plate light connector.***
- 2. Remove stock fender by removing the 4 bolts.***
- 3. Cut the stock license plate light connector from the stock fender. BE SURE TO CUT AT LEAST A 6" SECTION OF WIRE FROM THE CONNECTOR.***

***-INSTALLATION-***

- 1. Using the connectors in the kit, connect the Yoshimura Fender Eliminator wires to the stock license plate light connector as follows: Red wire goes to white wire; Black wire goes to black w/ white stripe.***
- 2. Install Yoshimura Fender Eliminator kit as shown in the parts diagram.***
- 3. Route wiring through hole in bracket, then through tail section to stock location. Connect license plate light connector to stock harness.***
- 4. Check for function of license plate light and that all brackets and pieces are secure prior to riding.***