



Fender Eliminator Kit

APPLICATION

YEAR	MODEL
2006-2011	Yamaha YZF-R6V

PRODUCT

070BG136300	Fender Eliminator Kit
-------------	-----------------------

! Yoshimura R&D is not liable or responsible for any resulting event caused by the installation of this product. Check with local laws and regulations for compliance prior to installation and use. This product is designed and specified for off-road applications only and is not intended for use on public highways.

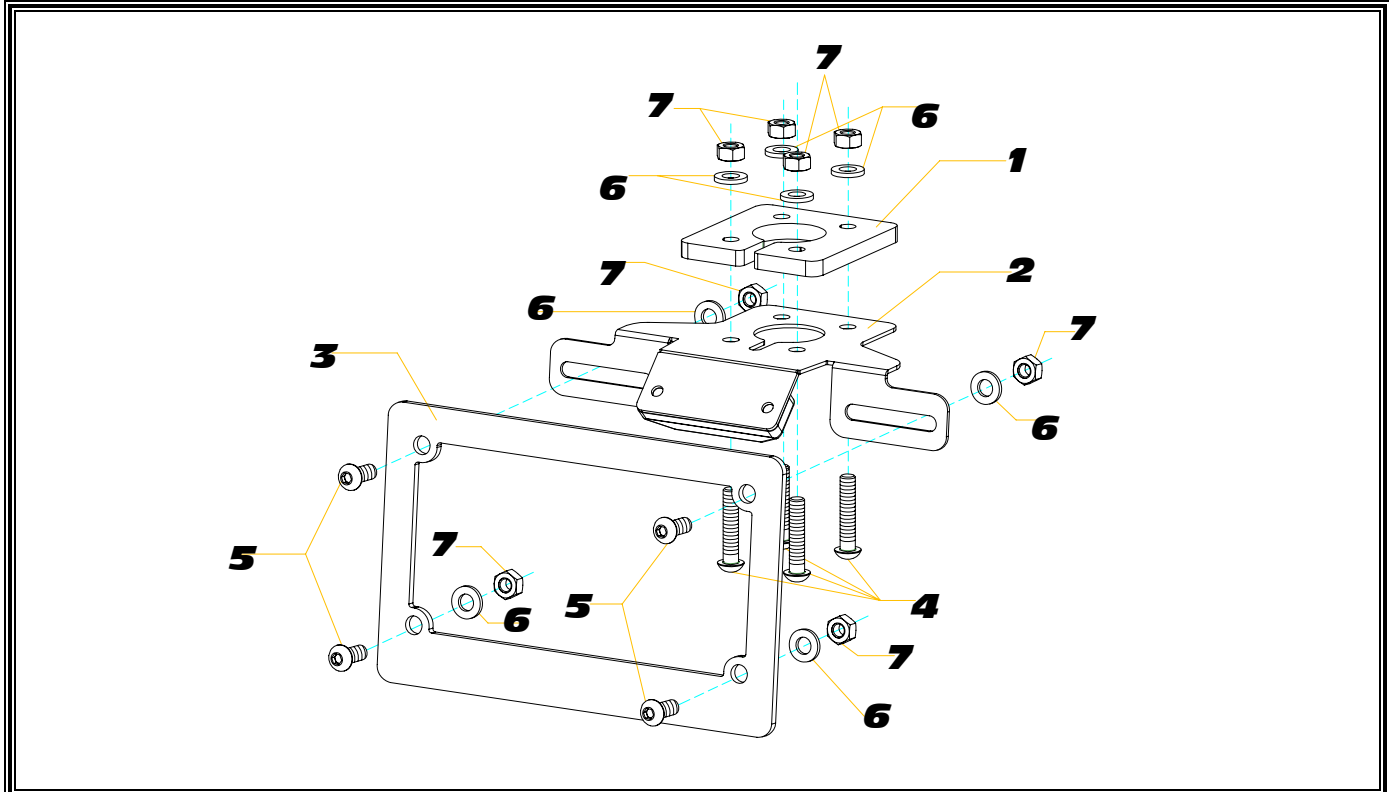

No.	Part #	Description	Qty
1	1363-FEB	Yoshimura Fender Eliminator Brkt	1
2	070BG-LPB4	Yoshimura License Plate Bracket	1
3	070BG-LPF	Yoshimura Aluminum License Plate Frame	1
4	M6X30BHS	6mm x 30mm Button Head Screw	4
5	M6X16BHS	6mm x 16mm Button Head Screw	4
6	6MMWASHER	6mm Washer	8
7	6MMLN	6mm Nylon Lock Nut	8
**	ZT-200	Zip Ties	3
**	94785-01-ND	Butt Connectors	2
**	17029	Yoshimura Sticker Sht	1

-TOOLS REQUIRED-

Metric Socket Set

Combination Wrench Set

Metric Allen Wrench Set

-REMOVAL-

- 1. Remove tail cowl or passenger seat and disconnect the license plate light connector.**
- 2. Remove the stock fender by removing the (4) bolts.**
- 3. Cut the stock license plate light connector from the stock fender. BE SURE TO CUT AT LEAST A 6" SECTION OF WIRE FROM THE CONNECTOR.**

-INSTALLATION-

- 1. Using the connectors provided in the kit, connect the Yoshimura Fender Eliminator wires to the stock license plate light connector as follows: Red wire goes to White wire; Black wire goes to Black w/ White stripe. (For 2011 Models, Red wire goes to Blue w/ Red Stripe; Black wire goes to Black.)**
- 2. Install Yoshimura Fender Eliminator kit as shown in the parts diagram. Note the order of components mounted to the subframe; the Yoshimura Fender Bracket plate fits between the stock tail and the Yoshimura License Plate Bracket.**
- 3. Route wiring through hole in bracket, then through tail section to stock location. Connect license plate light connector to stock harness. Use zip ties to secure license plate light wires.**
- 4. Check for function of license plate light and that all brackets and pieces are secure prior to riding.**