



Fender Eliminator Kit

APPLICATION

YEAR	MODEL
2008-2012	Kawasaki Ninja250R
PRODUCT	
070BG140700	Fender Eliminator Kit

! This product is not DOT approved. Yoshimura R&D of America, Inc. is not liable or responsible for any resulting event caused by the installation of this product. Check with local laws and regulations for compliance prior to installation and use. This product is not intended for use on public highways.

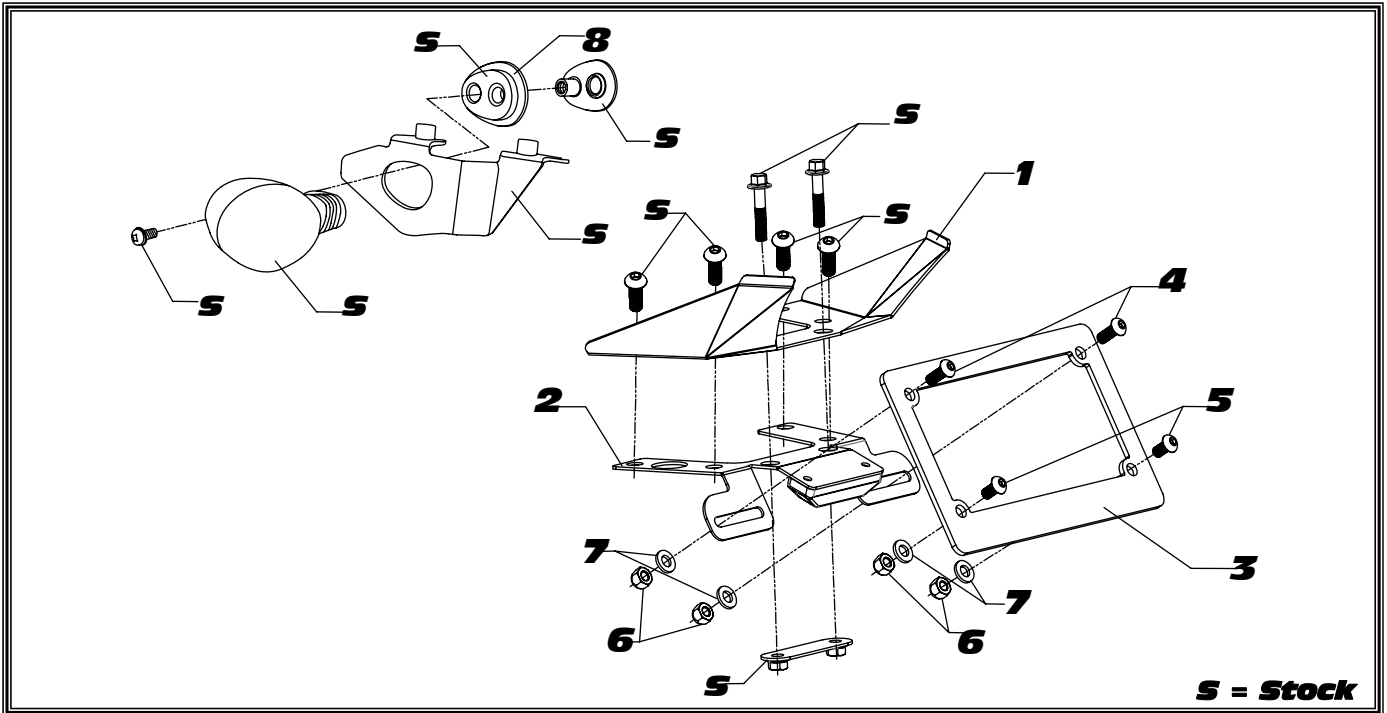

No.	Part #	Description	Qty
1	1407-FEB-00	Yoshimura Fender Eliminator Bracket	1
2	070BG-LPB6-01	Yoshimura License Plate Bracket	1
3	070BG-LPF	Yoshimura Aluminum License Plate Frame	1
4	M6X16BHS	6mm x 16mm Button Head Screw	2
5	M6X12BHS	6mm x 12mm Button Head Screw	2
6	6MMLN	6mm Lock Nut	4
7	6MMWASHER	6mm Washer	4
8	1407-TS-BKT	Turn Signal Bracket Shim	2
**	94785-01-ND	Butt Connectors	2
**	17029	Yoshimura Sticker Sht	1
<i>Optional Replacement Parts</i>			
****	M6X1HN	6mm Flange Nut	4
****	M6X16H	6mm x 16mm Hex Bolt	4

-TOOLS REQUIRED-

Metric Socket Set

Combination Wrench Set

Metric Allen Wrench Set

Power Drill

-REMOVAL-

- 1. Remove passenger seat and disconnect tail light, turn signals, and license plate light.**
- 2. Remove stock fender by removing the (6) bolts.**
- 3. Using a drill, drill out the (2) rivets on the turn signal bracket attached to the fender.**
- 4. Disassemble turn signal assembly and remove rubber grommet to separate turn signal assembly from fender. (Note: Stock turn signal, bracket and rubber grommet will be reused. Care should be taken during removal.)**
- 5. Cut the stock license plate light connector from the stock fender. BE SURE TO CUT AT LEAST A 6" SECTION OF WIRE FROM THE CONNECTOR.**

-INSTALLATION-

- 1. Using the connectors provided in the kit, connect the Yoshimura Fender Eliminator wires to the stock license plate light connector as follows: Red wire goes to orange wire; Black/yellow wire goes to black wire.**
- 2. Install shim provided in the kit onto the stock rubber grommet and re-assemble the stock turn signal assembly. Repeat step for opposite side.**
- 3. Assemble Yoshimura Fender Eliminator kit as shown in the parts diagram.**
- 4. Route wiring through hole in bracket, then through tail section to stock location. Connect license plate light connector to stock harness.**
- 5. Install Yoshimura Fender Eliminator assembly using the (6) stock bolts.**
- 6. Check for function of license plate light and that all brackets and pieces are secure prior to riding.**