



Fender Eliminator Kit

APPLICATION

YEAR	MODEL
2006-2013	Kawasaki ZX-14R
PRODUCT	Fender Eliminator Kit
070BG141400	

 This product is not DOT approved. Yoshimura R&D of America, Inc. is not liable or responsible for any resulting event caused by the installation of this product. Check with local laws and regulations for compliance prior to installation and use. This product is not intended for use on public highways.

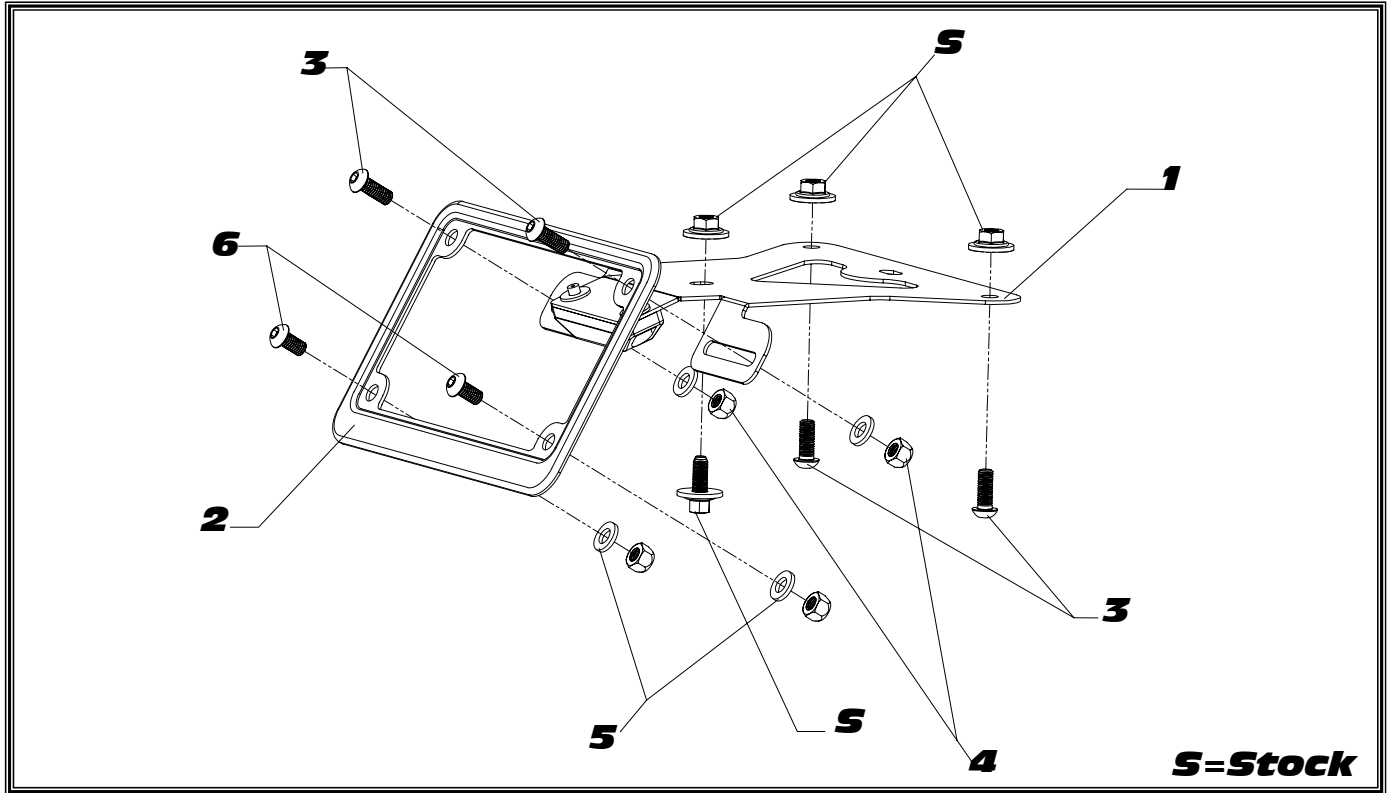

No.	Part #	Description	Qty
1	070BG-LPB12-01	Yoshimura License Plate Bracket	1
2	070BG-LPF	Yoshimura License Plate Frame	1
3	M6X16BHS	6mm x 16mm Button Head Screw	4
4	6MMLN	6mm Lock Nut	4
5	6MMWASHER	6mm Washer	4
6	M6X12BHS	6mm x 12mm Button Head Screw	2
**	94785-01-ND	Butt Connectors	2
**	17029	Yoshimura Sticker Sheet	1

-TOOLS REQUIRED-

Metric Socket Set

Combination Wrench Set

Metric Allen Wrench Set

-REMOVAL-

- 1. Remove tail cowl or passenger seat and disconnect the license plate light connector.***
- 2. Locate the tool kit box and remove tool kit from box to access the (4) screws securing the tool box.***
- 3. Move ECU to gain access to the fender mounting nuts. DO NOT DISCONNECT ECU.***
- 4. While securely supporting the fender assembly, remove the (3) stock nuts and carefully lower fender assembly.***
- 5. Cut the stock license plate light connector from the stock fender. BE SURE TO CUT AT LEAST A 6" SECTION OF WIRE FROM THE CONNECTOR.***

-INSTALLATION-

- 1. Using the connectors provided in the kit, connect the Yoshimura Fender Eliminator wires to the stock license plate light connector as follows: Red wire goes to Red; Black wire goes to Black w/ Yellow stripe.***
- 2. Install Yoshimura Fender Eliminator kit as shown in the parts diagram.***
- 3. Route wiring through hole in bracket, then through tail section to stock location. Connect license plate light connector to stock harness.***
- 4. Using the provided hardware in conjunction with the stock hardware, assemble and install Yoshimura Fender Eliminator bracket. See diagram for proper orientation.***
- 5. Re-install tool box and seat using the reverse steps of removal.***
- 6. Check for function of license plate light and that all brackets and pieces are secure prior to riding.***