



# Fender Eliminator Kit

APPLICATION

MAKE	MODEL
Kawasaki	ZX-14R
PRODUCT	
070BG141402	Fender Eliminator Kit

 This product is not DOT approved. Yoshimura R&D of America, Inc. is not liable or responsible for any resulting event caused by the installation of this product. Check with local laws and regulations for compliance prior to installation and use. This product is not intended for use on public highways.

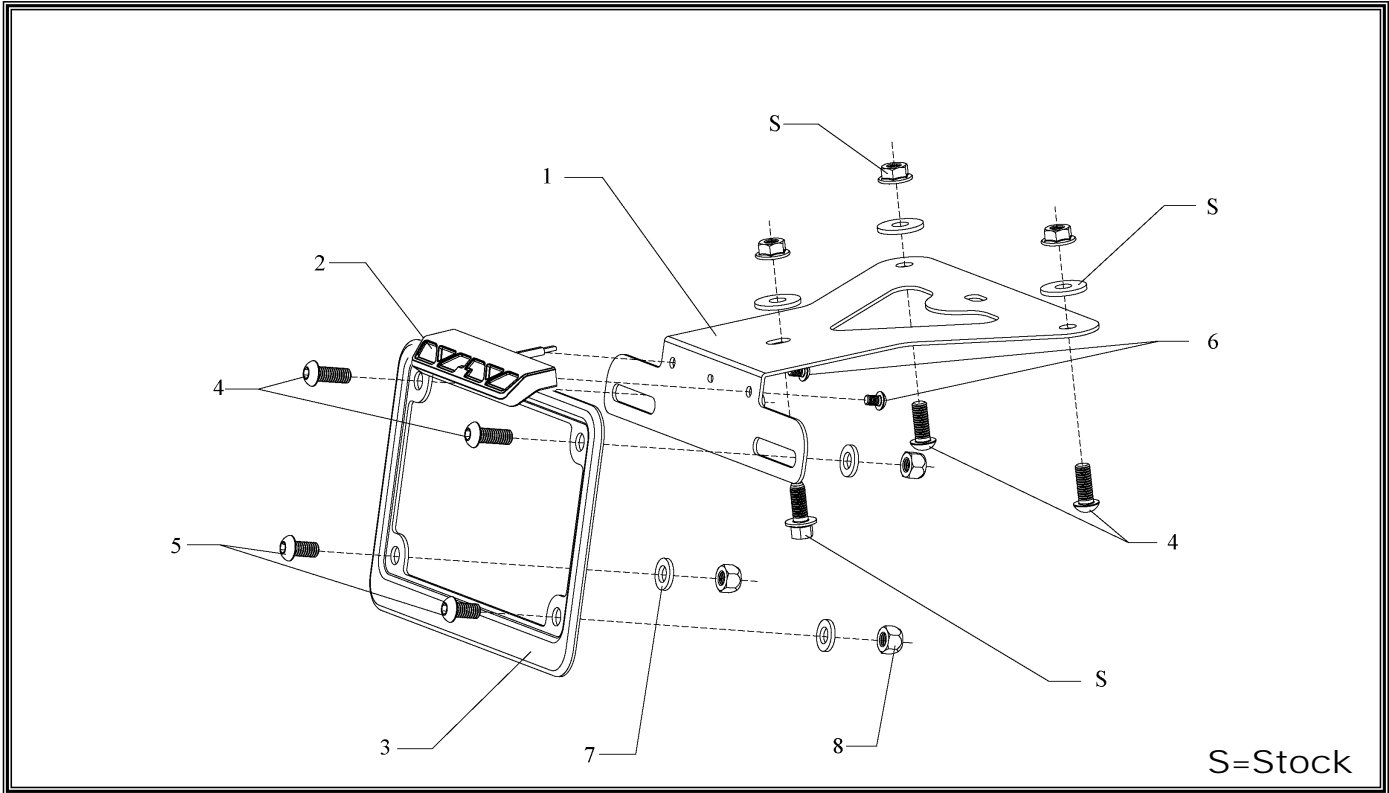

S=Stock

No.	Part #	Description	Qty
1	14140-FEBKT	Yoshimura Fender Eliminator Bracket	1
2	070BG-LH-K1	Yoshimura LED Fender Eliminator Light	1
3	070BG-LPF	Yoshimura License Plate Frame	1
4	M6X16BHS	6mm x 16mm Button Head Screw	4
5	M6X12BHS	6mm x 12mm Button Head Screw	2
6	M4X6BHS	4mm x 6mm Button Head Screw	2
7	6MMWASHER	6mm Washer	4
8	6MMLN	6mm Lock Nut	4
**	BN-SSS-22-18	Butt Connectors	2
**	17029	Yoshimura Sticker Sheet	1

**-TOOLS REQUIRED-**

*Metric Socket Set • Combination Wrench Set • Metric Allen Wrench Set*

**-REMOVAL-**

- 1. Remove tail cowl or passenger seat and disconnect the license plate light connector.**
- 2. Locate the tool kit box and remove tool kit from box to access the (4) screws securing the tool box.**
- 3. Move ECU to gain access to the fender mounting nuts. DO NOT DISCONNECT ECU.**
- 4. While securely supporting the fender assembly, remove the (3) stock nuts and carefully lower fender assembly.**
- 5. Cut the stock license plate light connector from the stock fender. BE SURE TO CUT AT LEAST A 6" SECTION OF WIRE FROM THE CONNECTOR.**

**-INSTALLATION-**

- 1. Install Yoshimura LED fender eliminator light onto Yoshimura fender eliminator bracket as shown in the parts diagram using the (2) provided 4mm screws.**
- 2. Using the connectors provided in the kit, connect the Yoshimura Fender Eliminator wires to the stock license plate light connector as follows: Red wire goes to Red; Black wire goes to Black w/ Yellow stripe.**
  - A) Strip the stock fender light wires ends  $\frac{1}{4}$ " -  $\frac{1}{2}$ " and insert into BN-SSS-22-18, butt connectors provided in the kit.**
  - B) Center the spliced wire ends in the middle and using a heat gun or lighter, apply heat evenly on the outer edges of the butt connector to shrink and hold wires in place.**
  - C) Making sure that the stripped ends are centered, heat the center of the butt connector evenly until the solder begins to liquify.**
  - D) Allow to cool completely and tug both ends of the wires to verify that connection is secured.**

**Scan for link to butt connector instruction video.**



- 3. Install Yoshimura Fender Eliminator kit as shown in the parts diagram using the hardware provided in the kit in conjunction with the stock hardware. See diagram for proper orientation and order of hardware.**
- 4. Route wiring through hole in bracket, then through tail section to stock location. Connect license plate light connector to stock harness.**
- 5. Re-install tool box and seat using the reverse steps of removal.**
- 6. Check for function of license plate light and that all brackets and pieces are secure prior to riding.**