



YOSHIMURA

RESEARCH&DEVELOPMENT OF AMERICA, INC.

5420 DANIELS STREET STE A, CHINO CALIF. 91710 · (800)634-9166 · (909)628-4722 · FACSIMILE (909)591-2198

www.yoshimura-rd.com

090HA231000 STEERING STEM NUT

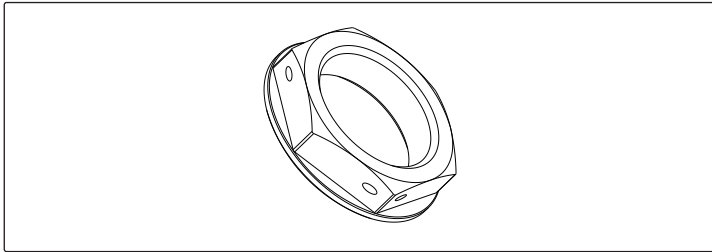

Instructions:

1. Remove stock steering head bolt.
2. Install Yoshimura steering head bolt. Torque to factory specification.

If safety wire is required, loop safety wire through the holes drilled in the nut and secure to stationary location on upper triple clamp.

Note: Installation to be performed by qualified technician only.

NO.	DESCRIPTION	QTY	PART #
1	Stem Nut	1	090HA231000F



YOSHIMURA

RESEARCH&DEVELOPMENT OF AMERICA, INC.

5420 DANIELS STREET STE A, CHINO CALIF. 91710 · (800)634-9166 · (909)628-4722 · FACSIMILE (909)591-2198

www.yoshimura-rd.com

090HA231000 STEERING STEM NUT

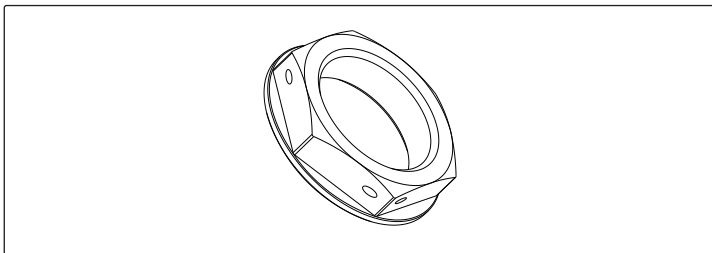

Instructions:

1. Remove stock steering head bolt.
2. Install Yoshimura steering head bolt. Torque to factory specification.

If safety wire is required, loop safety wire through the holes drilled in the nut and secure to stationary location on upper triple clamp.

Note: Installation to be performed by qualified technician only.

NO.	DESCRIPTION	QTY	PART #
1	Stem Nut	1	090HA231000F