



YOSHIMURA

RESEARCH&DEVELOPMENT OF AMERICA, INC.

5420 DANIELS STREET STE A, CHINO CALIF. 91710 · (800)634-9166 · (909)628-4722 · FACSIMILE (909)591-2198

www.yoshimura-rd.com

090RD231000	STEERING STEM NUT
	2010-2013 Yamaha YZ250F
	2010-2014 Yamaha YZ450F
	2012-2014 Yamaha WR450F
	2011-2013 Honda CBR250R
	2014 Honda Grom
	2014 Honda CRF125

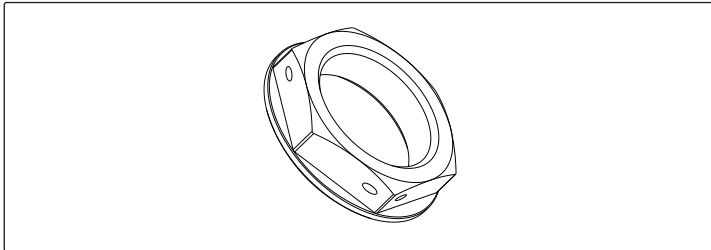

Instructions:

1. Remove stock steering head bolt.
2. Install Yoshimura steering head bolt. Torque to 105 lb-ft (145 N-m).

If safety wire is required, loop safety wire through the holes drilled in the nut and secure to stationary location on upper triple clamp.

Note: Installation to be performed by qualified technician only.

NO.	DESCRIPTION	QTY	PART #
1	Stem Nut	1	090RD231000F



YOSHIMURA

RESEARCH&DEVELOPMENT OF AMERICA, INC.

5420 DANIELS STREET STE A, CHINO CALIF. 91710 · (800)634-9166 · (909)628-4722 · FACSIMILE (909)591-2198

www.yoshimura-rd.com

090RD231000	STEERING STEM NUT
	2010-2013 Yamaha YZ250F
	2010-2014 Yamaha YZ450F
	2012-2014 Yamaha WR450F
	2011-2013 Honda CBR250R
	2014 Honda Grom
	2014 Honda CRF125

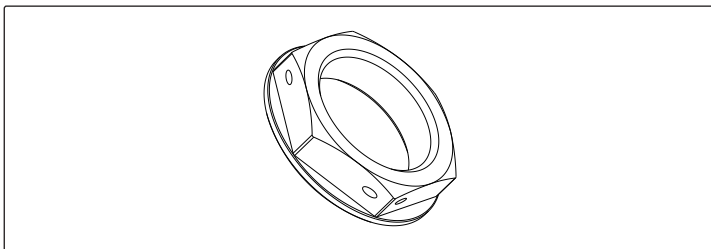

Instructions:

1. Remove stock steering head bolt.
2. Install Yoshimura steering head bolt. Torque to 105 lb-ft (145 N-m).

If safety wire is required, loop safety wire through the holes drilled in the nut and secure to stationary location on upper triple clamp.

Note: Installation to be performed by qualified technician only.

NO.	DESCRIPTION	QTY	PART #
1	Stem Nut	1	090RD231000F