



YOSHIMURA

RESEARCH&DEVELOPMENT OF AMERICA, INC.

5420 DANIELS STREET STE A, CHINO CALIF. 91710 · (800)634-9166 · (909)628-4722 · FACSIMILE (909)591-2198

www.yoshimura-rd.com

090RD242800	STEERING STEM NUT
	2004-2013 Kawasaki KX450F
	2006-2013 Kawasaki KX250F

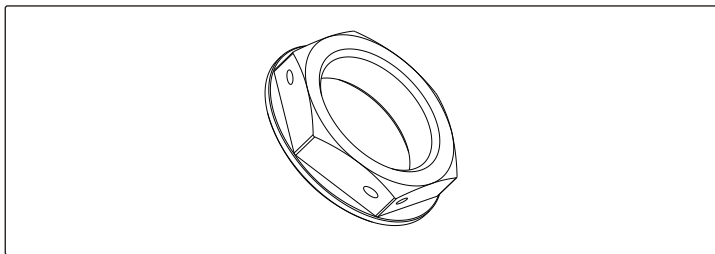

Instructions:

1. Remove stock steering head bolt.
2. Install Yoshimura steering head bolt. Torque to 72 lb-ft (97.5 N-m).

If safety wire is required, loop safety wire through the holes drilled in the nut and secure to stationary location on upper triple clamp.

Note: Installation to be performed by qualified technician only.

NO.	DESCRIPTION	QTY	PART #
1	Stem Nut	1	090RD242800F



YOSHIMURA

RESEARCH&DEVELOPMENT OF AMERICA, INC.

5420 DANIELS STREET STE A, CHINO CALIF. 91710 · (800)634-9166 · (909)628-4722 · FACSIMILE (909)591-2198

www.yoshimura-rd.com

090RD242800	STEERING STEM NUT
	2004-2013 Kawasaki KX450F
	2006-2013 Kawasaki KX250F

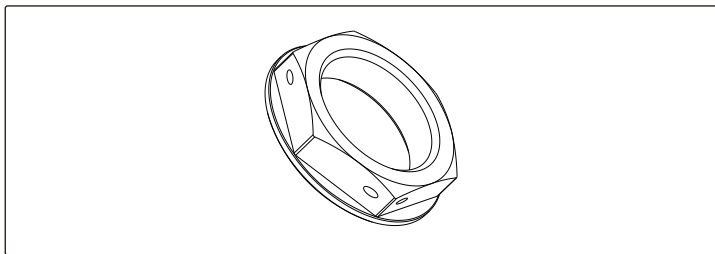

Instructions:

1. Remove stock steering head bolt.
2. Install Yoshimura steering head bolt. Torque to 72 lb-ft (97.5 N-m).

If safety wire is required, loop safety wire through the holes drilled in the nut and secure to stationary location on upper triple clamp.

Note: Installation to be performed by qualified technician only.

NO.	DESCRIPTION	QTY	PART #
1	Stem Nut	1	090RD242800F