



YOSHIMURA

RESEARCH&DEVELOPMENT OF AMERICA, INC.

5420 DANIELS STREET STE A, CHINO CA., 91786 · (800)634-9166 · (909)628-4722 · FACSIMILE (909)591-2198

www.yoshimura-rd.com

TRI-OVAL PERFORMANCE EXHAUST SYSTEM

**SUZUKI
'01-03
GSX-R600**

110109 (2,5,7)

TRI-OVAL STAINLESS STEEL DUPLEX RACE SYSTEM

110119 (2,5,7)

TRI-OVAL TITANIUM DUPLEX RACE SYSTEM

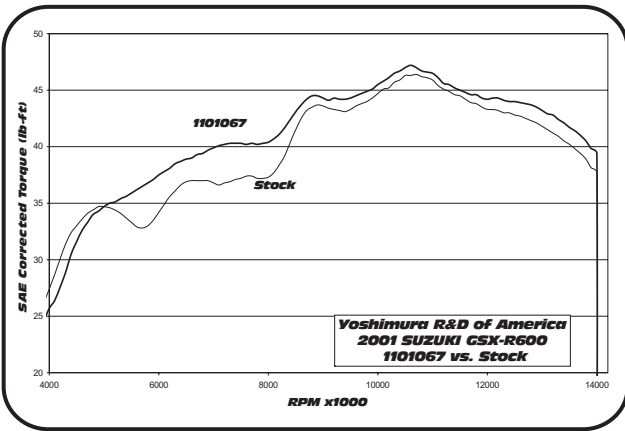
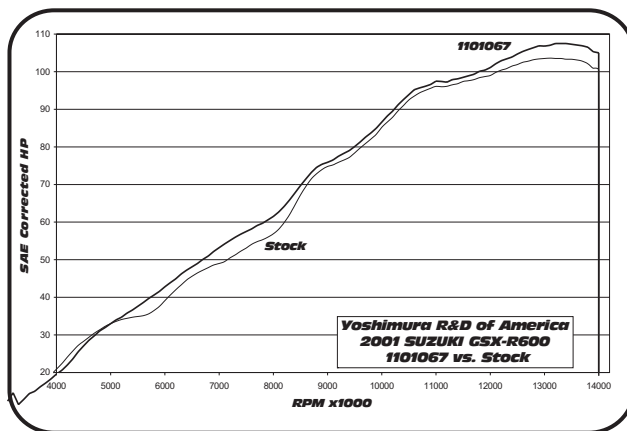

Note: Dyno graphs are for comparison use only. Actual results may vary depending on operating and motorcycle condition.



THIS PRODUCT IS DESIGNED FOR USE IN CLOSED COURSE RACING AND IS NOT INTENDED FOR HIGHWAY USE.



NOTE: IN THE STATE OF CALIFORNIA, IT IS ILLEGAL TO MODIFY THE EMISSION CONTROL SYSTEM. WHICH INCLUDES THE CARBURETORS OF ANY VEHICLE.

Caution: Exhaust system can be extremely hot. Let motorcycle cool down before beginning installation.

Note: Read through all instructions before beginning installation.

Tools Needed:

10mm and 12mm socket
3/8" ratchet and extension
12mm wrench
4mm Allen wrench
6mm Allen wrench for torque wrench
Torque wrench
Soft Face Mallet

Installation Steps:

- 1 Remove left, right and lower rear cowling.
(See Fig.1 for fastener locations)
- 2 Remove lower radiator mount bolt and tilt radiator forward slightly. (See Fig. 2)
- 3 Remove stock exhaust system and exhaust port gaskets.
- 4 Install new exhaust port gaskets.
(not supplied - Suzuki part no. 14181-46E00)
- 5 Install manifolds and flanges to exhaust ports using stock bolts. Torque bolts to 1.0 Kg-m (7.3 lb-ft).
(Refer to Fig. 3 for proper flange orientation.)
- 6 Install Yoshimura header.
(Install header from one end of the engine to the other. Slip one tube at a time into manifold.)
- 7 Install 2-1/2" exhaust springs into flange spring holes.
(Hook one end of the spring through drilled hole then pull the other end with supplied spring puller tool onto header's spring hook.) (See Fig.3)

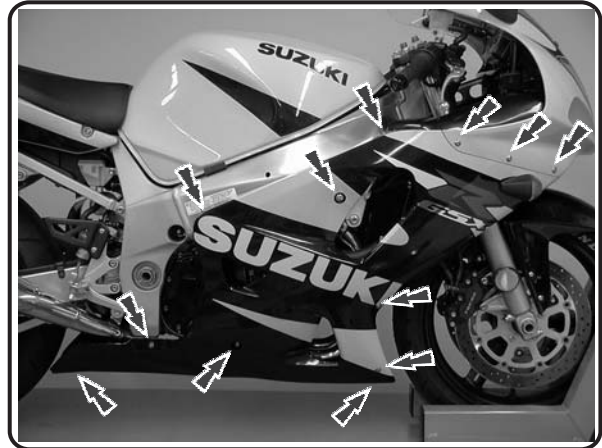

Fig. 1

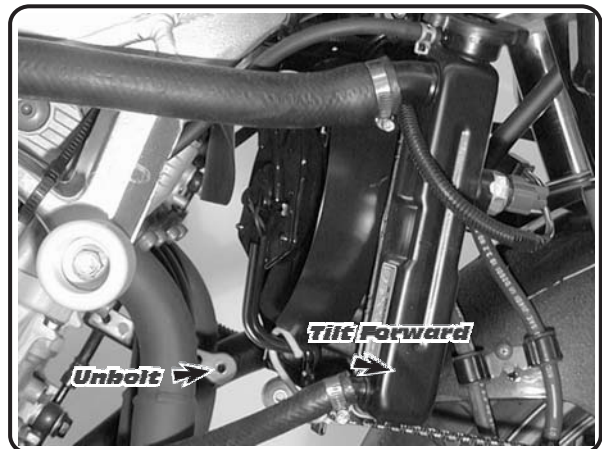

Fig. 2

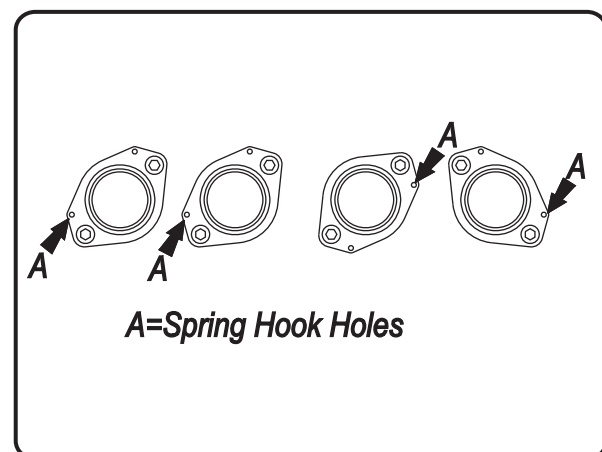
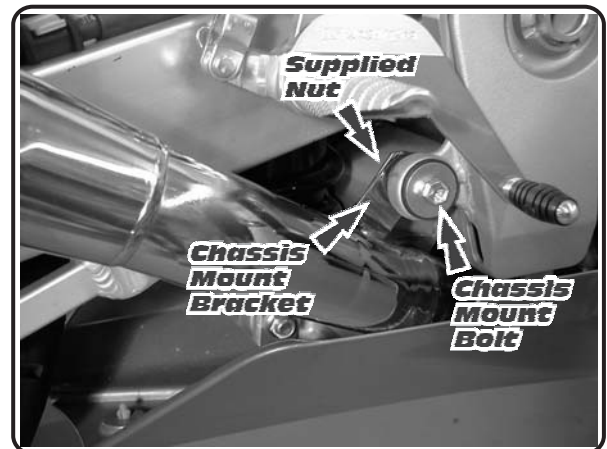
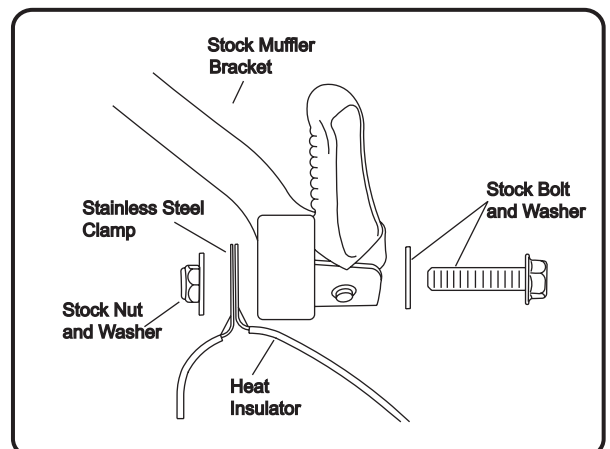

Fig. 3

- 8 With a soft face mallet, tap on header to fully seat tubes into manifolds.
- 9 Install Yoshimura tailpipe with muffler onto header and install 3 1/2" springs between header and tailpipe.
- 10 Bolt tailpipe to inside of chassis mount with stock bolt and supplied nut. (See Fig. 4)
Torque bolt to 2.5 kg-m (18 lb-ft)
- 11 Apply heat insulator to inside of muffler clamp then slide clamp onto muffler.
(note direction of clamp in Fig. 5)
- 12 Mount muffler clamp to inside of stock bracket using stock bolt washer and nut. (see Fig. 5)
Torque bolt to 2.5 kg-m (18 lb-ft).
- 13 It is recommended that the entire exhaust system be wiped down with rubbing alcohol to remove oil and fingerprints. This will help prevent tarnishing of the finish after the exhaust is heated up.
- 14 Reinstall lower radiator mount bolt.
- 15 Before starting motorcycle, check for proper clearance between new exhaust system and motorcycle. (i.e. radiator, oil pan, swing-arm, etc.)
If any problem is found, please carefully follow through the installation steps again. If problem still persists, please call Yoshimura tech. dept. at (800)634-9166 / in CA (909)628-4722.
- 16 Reinstall cowlings.
- 17 Check for proper clearance between new exhaust system and cowling before starting engine.

Note: After starting motorcycle, it is normal for new exhaust system to smoke until oil residue burns off.

**Fig. 4****Fig. 5**

#110109 (2,5,7) / #110119(2,5,7)

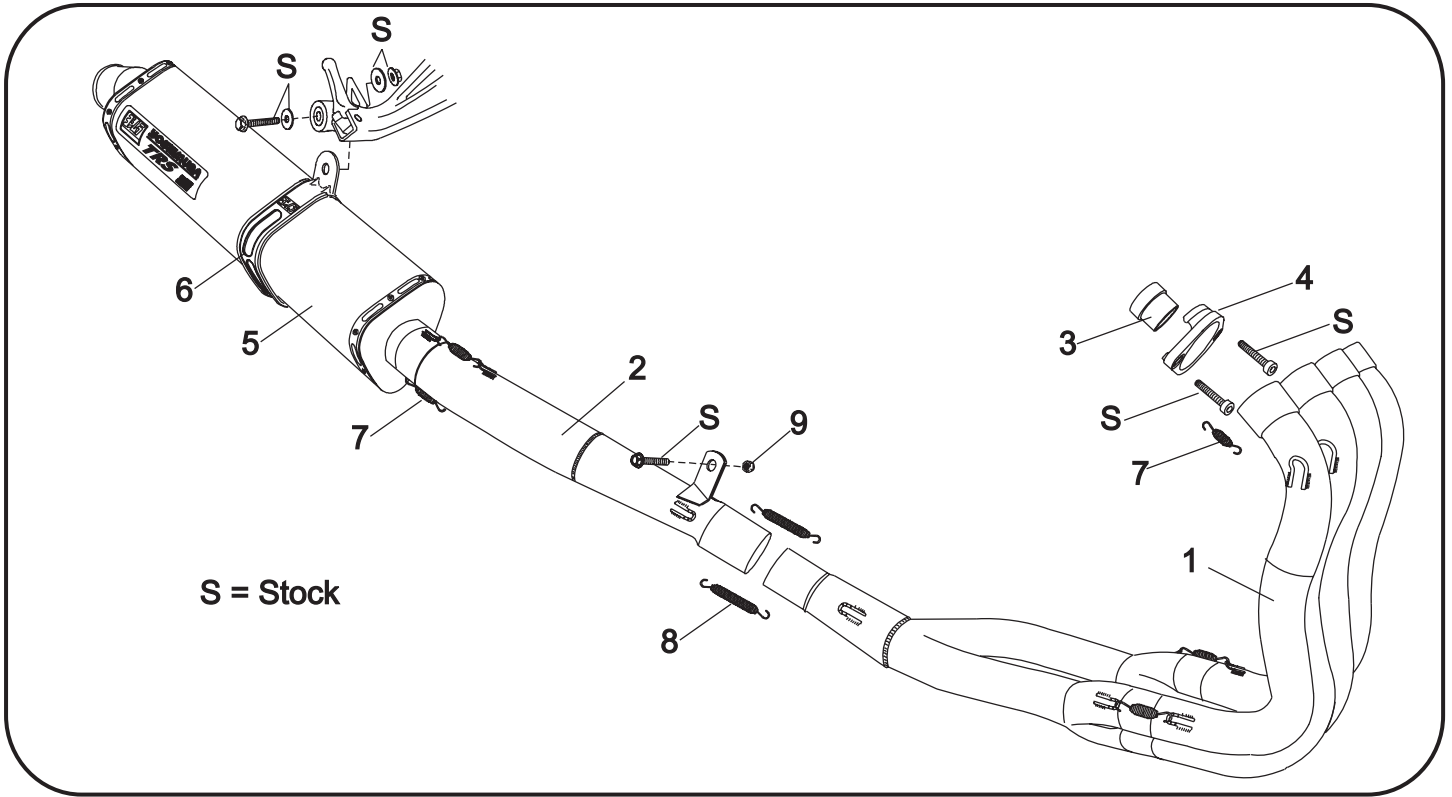

S = Stock

Parts Diagram

NO.	DESCRIPTION	QTY	PART #
1	Yoshimura Header Stainless Steel Duplex Race Only	1	1101-404
2	Yoshimura Tailpipe Stainless Steel Race only	1	1101-419
3	Stainless Steel Exhaust Manifold	4	YZ616SDM
4	Stainless Steel Exhaust Flange	4	YZ616SDR
5	TRS Muffler Assembly	1	**
6	TRS Stainless Steel Muffler Clamp Stainless Steel or Titanium Sleeve use Carbon Fiber Sleeve use	1	CTS081X CTS081
7	2-1/2' Exhaust Spring	10	RACE-SPS
8	3-1/2' Exhaust Spring	2	RACE-SPL
9	Flanged Nut	1	8MMNUT
**	Muffler Clamp Heat Insulator	1	HT SHLDTRS
**	Spring Puller Tool	1	ST-200
**	Yoshimura Vinyl Sticker	1	17029
**	Duplex Sticker	2	DLABEL

Nuts and Bolts Guide (Actual Size):

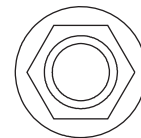

8mm Flange Nut