



YOSHIMURA

RESEARCH & DEVELOPMENT OF AMERICA, INC.

5420 DANIELS STREET STE A, CHINO CA., 91786 · (800)634-9166 · (909)628-4722 · FACSIMILE (909)591-2198

www.yoshimura-rd.com

RS-3 PERFORMANCE EXHAUST SYSTEM

YAMAHA
'01-05
FZ1

132005 (2,5,7) RS-3 STAINLESS STEEL RACE SYSTEM

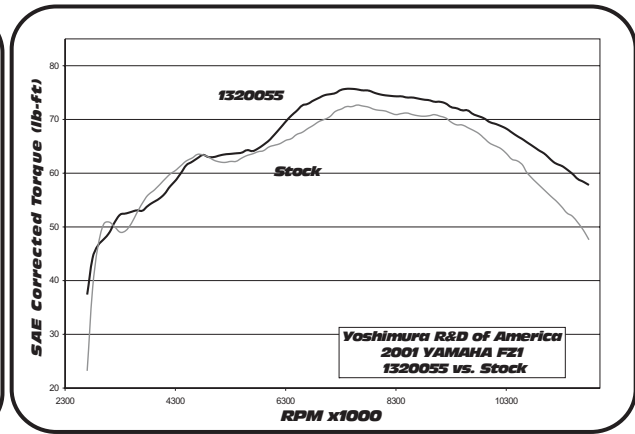
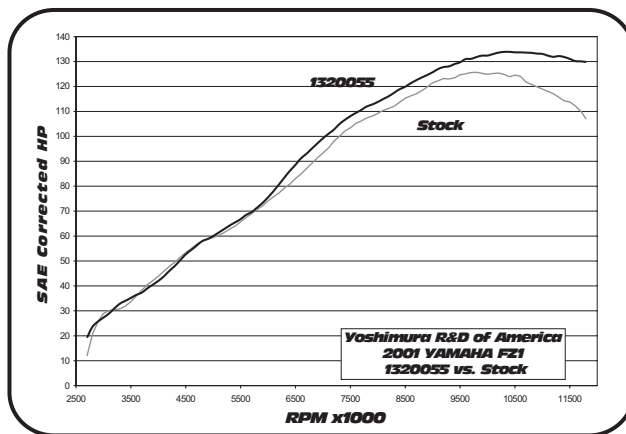

Note: Dyno graphs are for comparison use only. Actual results may vary depending on operating and motorcycle condition.



NOTE: IN THE STATE OF CALIFORNIA, IT IS ILLEGAL TO MODIFY THE EMISSION CONTROL SYSTEM. WHICH INCLUDES THE CARBURETORS OF ANY VEHICLE.

Caution: Exhaust system can be extremely hot. Let motorcycle cool down before beginning installation.

Note: Read through all instructions before beginning installation.

Tools Needed:

8mm, 12mm, 14mm socket
5mm, 8mm Allen wrench
11mm, 12mm, 14mm wrench
Ratchet with extension
Torque wrench
Electric Drill with 3/16" drill bit
Safety Glasses

Installation Steps:

- 1 Disconnect and remove EXUP cables.
(See Yamaha service manual for proper procedures)
- 2 Remove stock exhaust system. First remove stock muffler and tailpipe, use a soft cloth to cushion center stand contact with shifter lever. Remove nuts from head pipes. Remove chassis bolt from frame bracket (note: for ease of bolt removal allow center stand to retract as far as possible)(See Fig.1).
- 3 Remove exhaust port gaskets and replace with new gaskets. (Not supplied Yamaha part no. 4FM146130000)
- 4 Install Yoshimura header using header stock nuts. Torque nuts to 1.0 kg-m (7.3 lb-ft).
- 5 Install stock chassis mount bolt with supplied nut. (For ease of installation allow center stand to retract as high as possible) (See Fig.1). Torque bolt to 2.5kg-m (18.2lb-ft).
- 6 Slide supplied collector clamp over Yoshimura tailpipe and install tailpipe with muffler onto header. Adjust tailpipe until center stand stop bracket is correctly positioned.
- 7 Apply heat insulator to inside of muffler clamp then slide clamp onto muffler. (note direction of clamp in Fig. 3)
- 8 Mount muffler clamp to the outside of stock muffler/footpeg bracket using stock bolt, washer, and supplied nut. (See Fig. 3) Torque bolt to 2.5 kg-m (18 lb-ft)
- 9 Drill a 3/16" hole thru end of header at the center of the securing hole in Yoshimura tailpipe. (See Fig.2) (Caution: Always wear eye protection when using any power tool.)

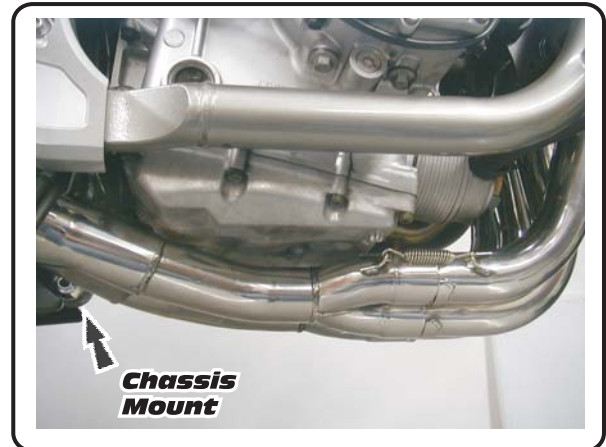

Fig. 1

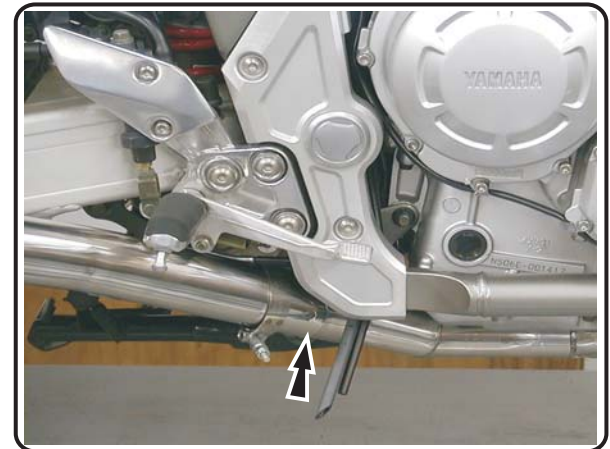
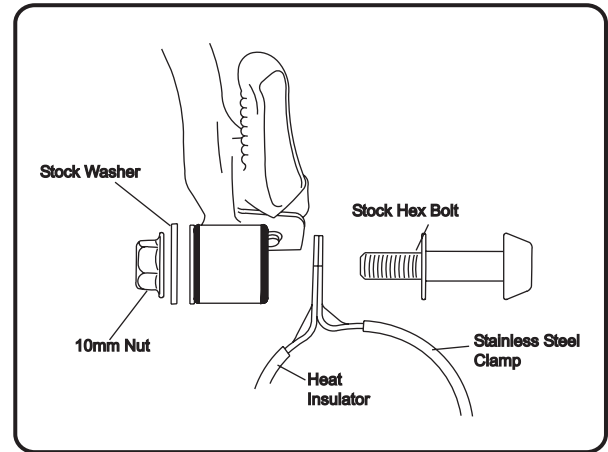

Fig. 2

Installation Steps:

- 10 Install securing rivet into drilled hole, slide stainless steel exhaust clamp over rivet and tighten clamp nut to 1.25 kg-m (9 lb-ft.).
- 11 It is recommended that the entire exhaust system be wiped down with rubbing alcohol to remove oil and fingerprints. This will help prevent tarnishing of the finish after the exhaust is heated up.
- 12 Before starting motorcycle, check for proper clearance between new exhaust and motorcycle. (i.e. Chassis, radiator, swing-arm, passenger foot-peg, rear wheel, etc.) If any problem is found, please carefully follow through the installation steps again. If problem still persists, please call Yoshimura tech. Dept. at (800)634-9166 / in CA (909)628-4722

Note: After starting motorcycle, it is normal for new exhaust and muffler to emit smoke until oil residue burns off.

**Fig. 3**

P/N# 132005(2,5,7)

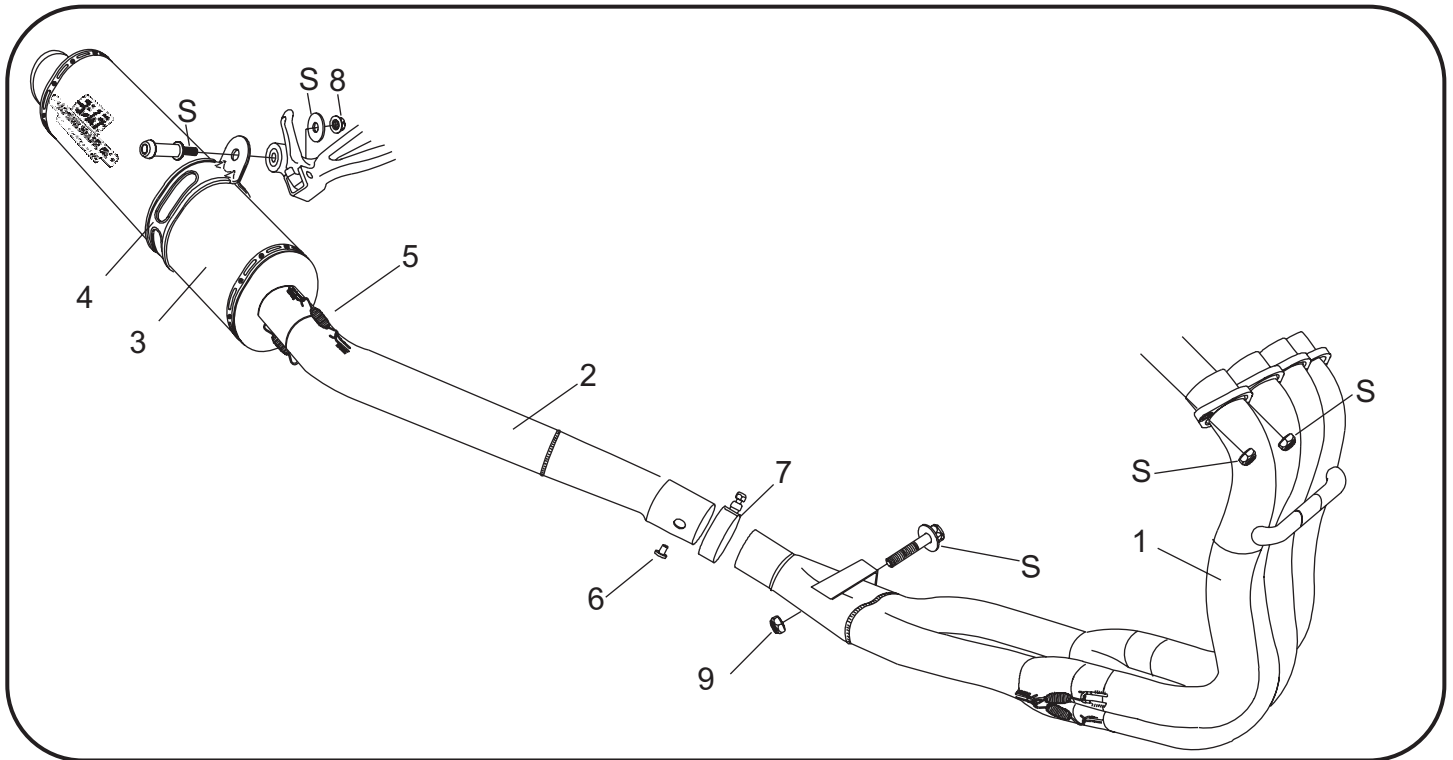

Parts Diagram

NO.	DESCRIPTION	QTY	PART #
1	Yoshimura Header Stainless Steel Race	1	1320-401
2	Yoshimura Tailpipe Stainless Steel Race	1	1320-419
3	RS-3 Muffer Assembly	1	**
4	Stainless Steel Muffer Clamp Stainless Steel or Titanium Sleeve uses Carbon Fiber Sleeve uses	1	COS450S10ASX COS450S10AS
5	Stainless Steel Spring	6	RACE-SPS
6	Collector Rivet	1	S-RIVET
7	Stainless Steel Collector Clamp	1	20067
8	10mm Flanged Hex Nut	1	10MMFNUT
9	8mm Flanged Hex Nut	1	8MMFNUT
**	Spring Puller Tool	1	ST-200
**	Muffer Clamp Heat Insulator	1	HT SHLDTRS
**	Yoshimura Vinyl Sticker	2	17028-BLK

Recommended Modifications For This Exhaust System:
With a hole saw; drill 4 equally spaced 7/8" holes in Airbox lid.



Nuts and Bolts Guide (Actual Size):

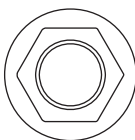

8mm Flange Nut

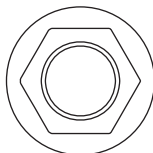

10mm Flange Nut