



# YOSHIMURA

RESEARCH&DEVELOPMENT OF AMERICA, INC.

5420 DANIELS STREET STE A, CHINO CALIF. 91710 · (800)634-9166 · (909)628-4722 · FACSIMILE (909)591-2198

[www.yoshimura-rd.com](http://www.yoshimura-rd.com)

**2166-840-K**

2000-2013 Suzuki DRZ400/SM Case Saver Kit

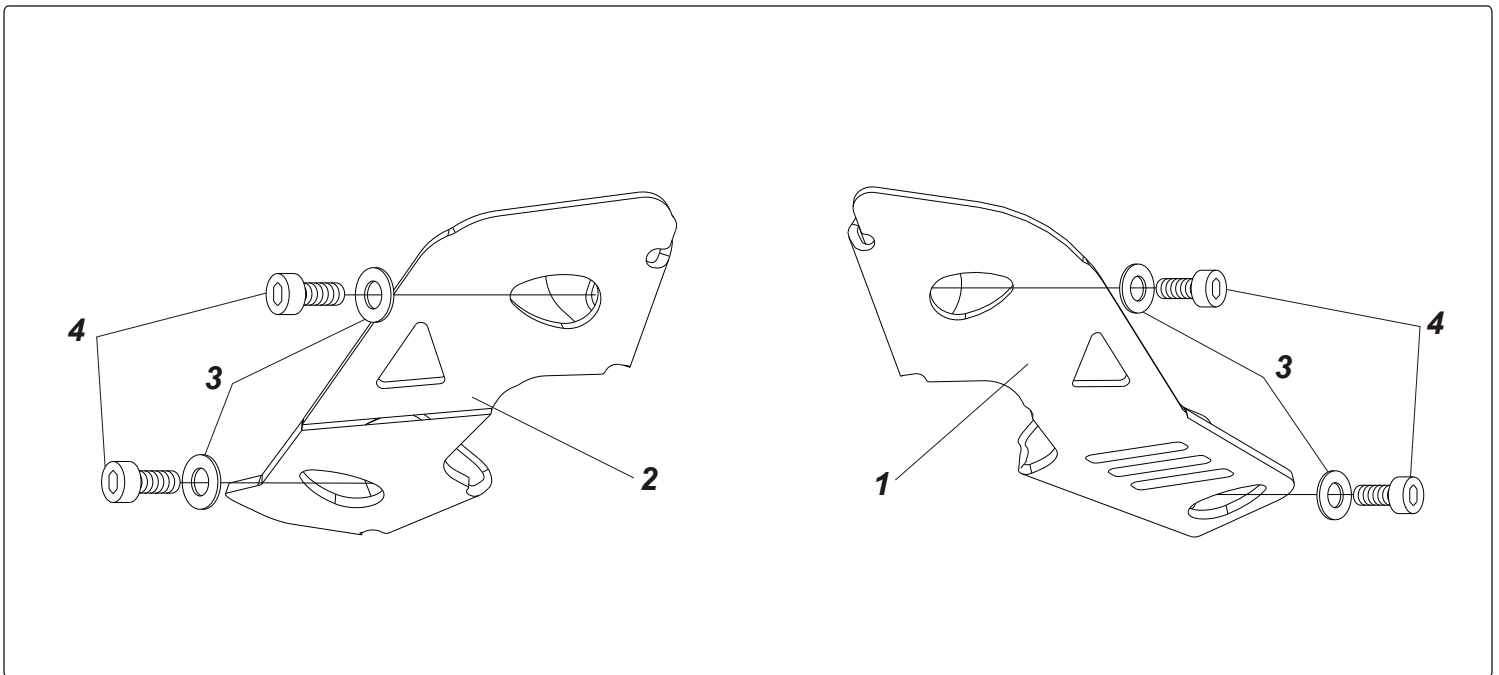

NO.	DESCRIPTION	QTY	PART #
1	Yoshimura Left Cast Saver	1	2166-840-L
2	Yoshimura Right Case Saver	1	2166-840-R
3	8mm Washer	4	8MMWASHER
4	8mm x 16mm Socket Head Screw	4	M8X16

## ***Installation Instructions:***

1. Remove stock plastic case savers. (Remove one side first, then other side)
2. Using the supplied hardware, mount one case saver to each side of the frame. Each case saver uses 2 bolts and 2 washers.
3. Torque each bolt to 9.5 lb-ft (13 N-m)

Yoshimura Case Savers are designed to reduce damage to the engine cases in the event of a light or mild crash ONLY. The Case Savers are not designed to prevent damage to the engine cases completely, nor are they designed to prevent damage to fairings or body work.