



# YOSHIMURA

RESEARCH&DEVELOPMENT OF AMERICA, INC.

5420 DANIELS STREET STE A, CHINO CA., 91710 · (800) 634-9166 · (909) 628-4722 · FAX (909) 591-2198

[www.yoshimura-rd.com](http://www.yoshimura-rd.com)

## *Signature Series*

Qualified Manufacturer Declared "Replacement Part"

**2019**

**Honda CRF450RWE**

**22584-704F**

***Titanium Works Edition Header***



Signature Series systems are:

- CARB/EPA tail-pipe emissions compliant.
- Marked with appropriate EPA noise labels.
- Independent laboratory tested for EPA new vehicle noise compliance.



✘ You must know how to remove and replace your stock exhaust in order to install this product otherwise have it installed by a professional mechanic. Keep all stock parts from your existing system as some components may be necessary to install your new Yoshimura exhaust depending on the application. Read through all instructions before beginning installation. Exhaust system can be extremely hot. Let motorcycle cool down before beginning installation. Always wear hand and eye protection and take precautionary measures to avoid injury. ✘

NOTE: IN THE STATE OF CALIFORNIA, IT IS ILLEGAL TO MODIFY THE EMISSION CONTROL SYSTEM, WHICH INCLUDES THE CARBURETORS OF ANY VEHICLE.

## Assembly Diagram

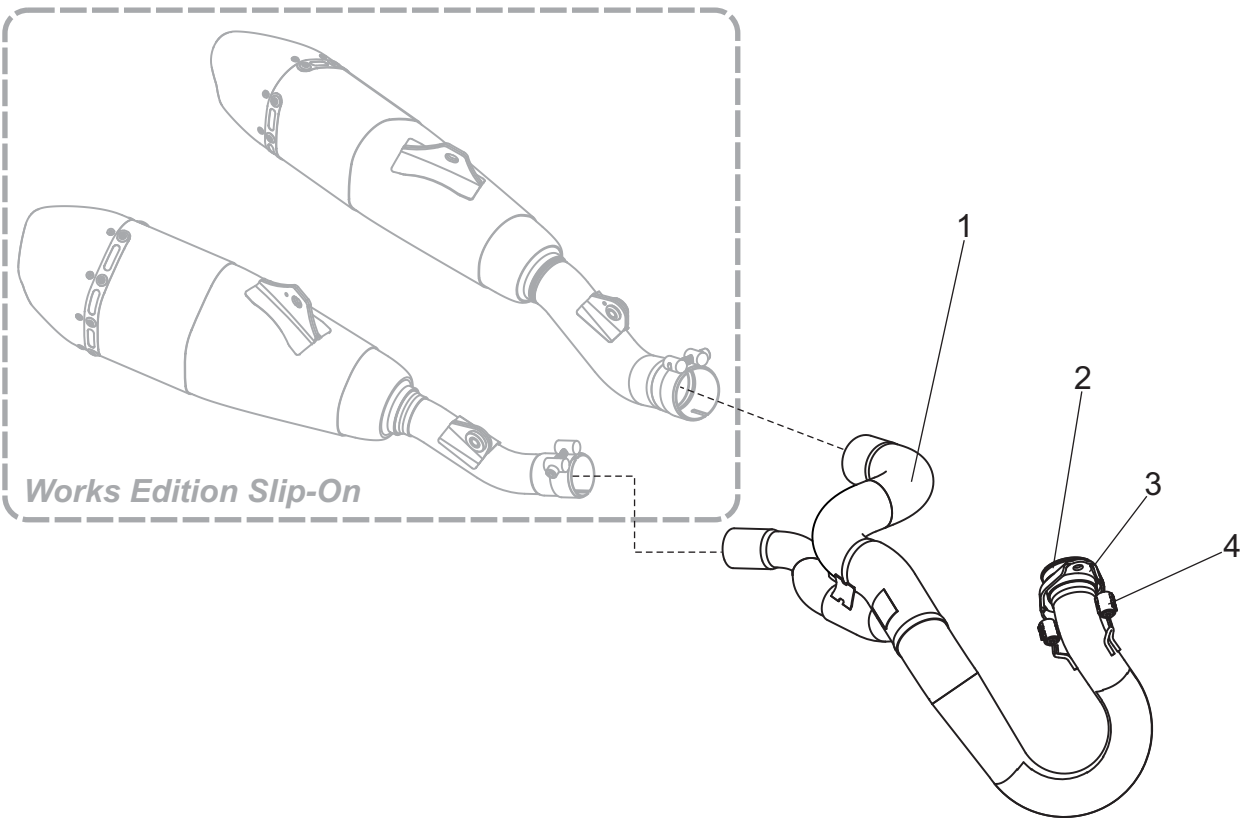

No.	Item	Description	Qty.
1	22584-704	Yoshimura Works Edition Ti Header	1
2	2257SDM-TI	Yoshimura Manifold	1
3	22582-SDR	Yoshimura Flange	1
4	RACE-SPX-2	Short Exhaust Spring	2
**	ST-200	Spring Puller Tool	1
**	17029	Sticker Kit Sheet	1

\*\* Not shown in diagram.

**CAUTION:** Exhaust system can be extremely hot. Let motorcycle cool down before beginning installation. Always wear hand and eye protection and take precautionary measures to avoid injury.

**WARNING:** Always properly support vehicle with a stand and/or lift when servicing or performing any work. Unstable vehicles may present dangerous conditions and may cause property damage and/or personal injury.

**NOTE:** Read through all instructions before beginning installation.

---

## Removal

1. Remove the left and right side panels.
2. Loosen the left and right tailpipe exhaust clamps.
3. While securely supporting the left muffler, remove the left side muffler mount bolt. Carefully remove muffler by sliding toward the rear.
4. While securely supporting the right muffler, remove the right side muffler mount bolt. Carefully remove muffler by sliding toward the rear.
5. Remove left side tailpipe chassis mount bolt and remove tailpipe off of stock header.
6. Remove right side tailpipe chassis mount bolt and remove tailpipe off of stock header.
7. Remove the header nuts and carefully remove the stock header.

Note: The stock exhaust port gasket will be re-used with the Yoshimura Works Edition header. Inspect and replace if necessary.

## Installation

1. Install (No. 1) 22584-704, Yoshimura header using the stock header nuts. Do not torque at this time.  
  
Note: For ease of installation, hook (No. 4) *RACE-SPX-2*, small exhaust springs onto flange before installing.
2. Re-install left tailpipe by sliding onto left header outlet. Align tailpipe chassis mount bracket to subframe and secure using the stock chassis mount bolt. Do not torque at this time.
3. Re-install right tailpipe by sliding onto right header outlet. Align tailpipe chassis mount bracket to subframe and secure using the stock chassis mount bolt. Do not torque at this time.
4. Install right muffler, onto right tailpipe outlet. Align muffler mount bracket to muffler mount and secure using the stock muffler mount bolt and washer. Do not torque at this time.
5. Install left muffler, onto left tailpipe outlet. Align muffler mount bracket to muffler mount and secure using the stock muffler mount bolt and washer. Do not torque at this time.
6. Torque header nuts to factory specification and using the supplied *ST-200*, spring puller tool hook (No. 4) *RACE-SPX-2*, short exhaust springs to header from the flange.
7. Torque left and right tailpipe chassis mount bolt to factory specification.
8. Torque left and right muffler mount bolt to factory specification.
9. Torque left and right tailpipe tailpipe exhaust clamps to 8.5 Nm (0.86 kg-m, 6 ft-lbs).
10. Re-install left and right side panels following the opposite steps of removal.
11. Before starting motorcycle, check for proper clearance between new exhaust system and rear suspension (i.e. tire, swingarm, brakes, rear shock, and etc.) If any problem is found, please carefully follow through the installation steps again. If problem still persists, please call Yoshimura Tech Department at (800) 634-9166 / in CA (909) 628-4722.

12. It is recommended that the muffler and tailpipe be wiped down with rubbing alcohol to remove oil and fingerprints. This will help prevent tarnishing of the finish after the exhaust is heated up.

Note: After starting motorcycle, it is normal for new exhaust system and muffler to emit smoke until oil residue burns off.