



# ENDURO SERIES

**Qualified Manufacturer Declared "Replacement Part"**

**APPLICATION**

<b>YEAR</b>	<b>MODEL</b>
2012-2015	Yamaha WR450F

**PRODUCT**

234700D320	RS4S SS Full System Exhaust System with Aluminum Sleeve: Carbon Fiber Endcap
------------	--

- ⚠ In the state of California, it is illegal to modify the emission control system, which includes the fuel injection of any vehicle.
- ⚠ You must know how to remove and replace your stock exhaust in order to install this product otherwise have it installed by a professional mechanic. Keep all stock parts from your existing system as some components may be necessary to install your new Yoshimura exhaust depending on the application.
- ⚠ Read through all instructions before beginning installation. Exhaust system can be extremely hot. Let motorcycle cool down before beginning installation. Always wear hand and eye protection and take precautionary measures to avoid injury.

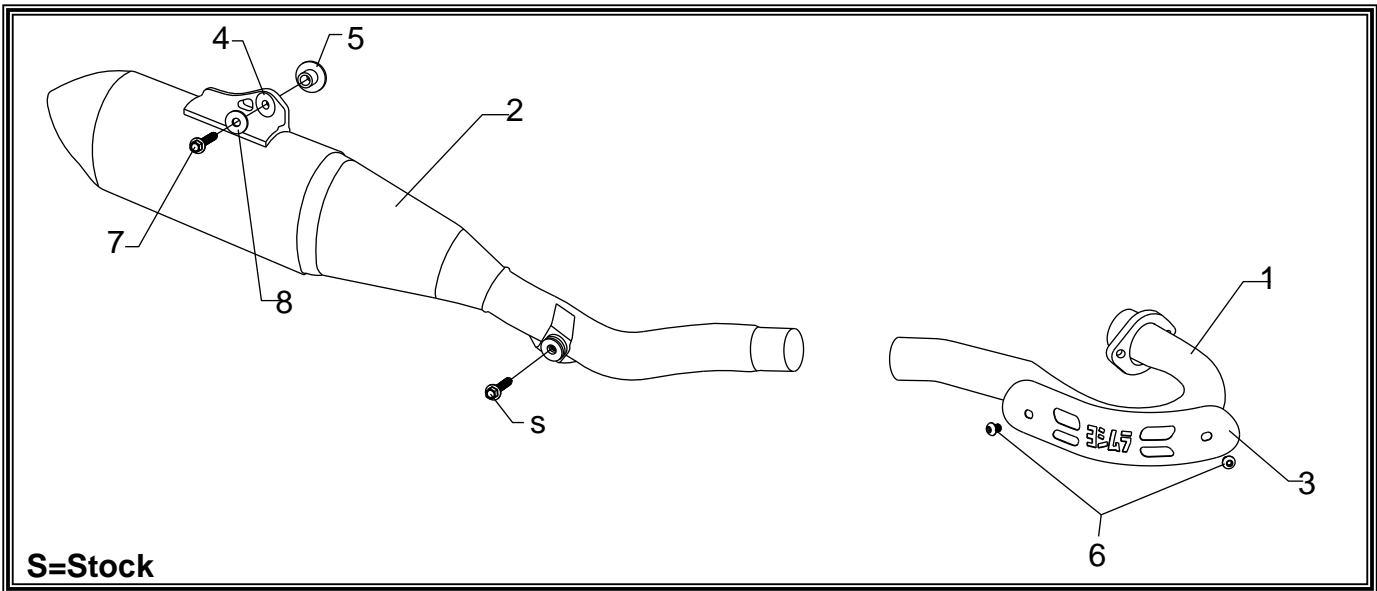

No.	Part #	Description	Qty
1	23470-101	Yoshimura Header	1
2	234700D320-RMA	Yoshimura Muffler Assembly	1
3	2115-HS	Yoshimura Heatshield	1
4	Z1022	Rubber Grommet	1
5	ALS-003	Aluminum Spacer	1
6	RC116HSB	6mm x 8mm Button Head Screw	2
7	M8X30H	8mm x 30mm Hex Head Bolt	1
8	8MMWASHERL	8mm Large Washer	1
**	HT SHLD4X6	Aluminum HS Foil	1
**	347PLUG	Muffler Wash Plug	1
**	17029	Yoshimura Sticker Sheet	1



## *-TOOLS REQUIRED-*

*Metric Socket Set • Combination Wrench Set • Torque Wrench • Metric Allen Wrench Set*

## *-REMOVAL-*

1. *Removing the number plate.*
  - a) **Remove the (2) bolts securing number plate.**
  - b) **Carefully pull off number plate from the airbox tabs.**
  
2. *Removing the muffler.*
  - a) **Loosen the exhaust clamp on the header to tailpipe connection.**
  - b) **Remove the chassis mount bolt securing the muffler assembly to subframe.**
  - c) **While securely supporting the muffler, remove the muffler mount bolt.**
  - d) **Carefully remove the muffler and tailpipe off the stock header.**
  - e) **While securely supporting the header, remove the header bolts and carefully remove header.**  
**Note: Inspect stock exhaust port gasket and replace if necessary. It will be used with the Yoshimura exhaust system.**

## *-INSTALLATION-*

1. *Small parts installation.*
  - a) **Install provided rubber grommet into muffler bracket.**
  - b) **Install aluminum spacer into rubber grommet. See diagram for proper orientation.**
  - c) **Install provided heatshield foil. See template for instructions.**
  
2. *Installing the Yoshimura full system exhaust.*
  - a) **Install Yoshimura header using the stock header bolts and stock exhaust port gasket. Do not torque at this time.**
  - b) **Carefully install Yoshimura muffler assembly by sliding onto Yoshimura header.**
  - c) **Bolt the tailpipe to subframe mount using the stock bolt. Start threads by hand to prevent cross-threading. Do not torque bolt at this time.**
  - d) **Secure Yoshimura muffler assembly using the stock muffler mount bolt and washer.**
  - e) **Torque muffler mount bolt to factory specification.**
  - f) **Torque chassis mount bolt to factory specification.**
  - g) **Torque header bolts to factory specification.**
  - h) **Install Yoshimura heatshield to header using the (2) button head screws provided in the kit.**
  
3. *Reinstall number plate.*
  - a) **Re-install number plate using the reverse steps of removal.**
  
4. *Fitment check and Notes.*
  - a) **Before starting motorcycle, check for proper clearance between new exhaust system and rear suspension (i.e. tire, swing-arm, brake, rear shock, engine, and etc.) If any problem is found, please carefully follow through the installation steps again. If problem still persists, please call Yoshimura Tech Department at (800) 634-9166 / in CA (909) 628-4722.**
  - b) **It is recommended that the muffler and tailpipe be wiped down with rubbing alcohol to remove oil and fingerprints. This will help prevent tarnishing of the finish after the exhaust is heated up.**
  - c) **NOTE: After starting motorcycle, it is normal for new exhaust system and muffler to emit smoke until oil residue burns off.**

Cut on dotted line.

Place template on the white adhesive side of the heatshield foil.

Cut heatshield foil along the template.

Clean airbox surface where the heatshield will be applied.

Peel adhesive backing from heatshield foil and install onto stock airbox along the subframe. See photo below.

