

SUZUKI **INSTALLATION INSTRUCTIONS**

Description: Performance Exhaust System
Applications: 2003- LT-Z400

Part Number: **99950-70502**
Installation Time: **1.5 hours**

Contents:

Reference#	Description	Qty
1	Performance Exhaust with Muffler	1
2	Muffler Clamp with Insulator	1
3	Aluminum Spacer	1
4	8mm X 60 mm Flange Head Bolt	1
5	Stainless Steel Collector Clamp	1
6	8mm Large Washer	1
Replacement parts:		
99950-70503-PAK	LTZ Repack Kit	1
99950-70503-001	LTZ Endcap Gasket	1
99950-70503-002	LTZ Spark Arrestor	1
99950-70503-003	Nameplate Rivets	4
99950-70503-004	LTZ Yosh/Suz Nameplate	1

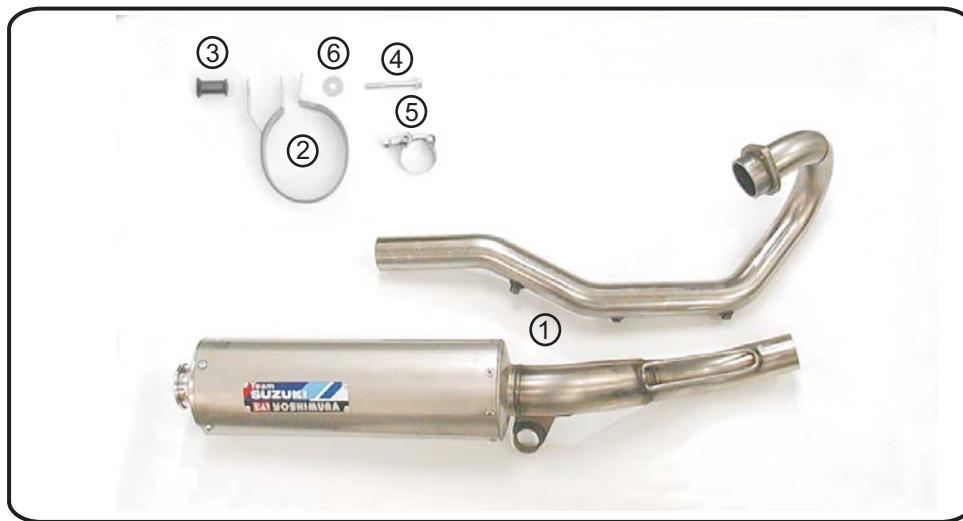

Tools Required:

Tools Description

10mm & 12mm Sockets
3/8" Ratchet Wrench with Extension
10mm & 12mm Wrench
4mm & 6mm Allen Wrench
3/8" Torque Wrench



Important:

WARNING

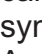
Please read this manual and follow the instructions carefully. To emphasize special information, the symbol  and the words **WARNING**, **CAUTION**, and **NOTE** have special meanings. Pay special attention to the messages highlighted by these signal words.

CAUTION

NOTE:

NOTE: Indicates special information to make maintenance easier or instructions clearer.

WARNING

Indicates potential hazard that could result in death or injury.

CAUTION

Indicates potential hazard that could result in vehicle damage.

GENUINE SUZUKI ACCESSORIES



Preparation Prior to Installation

Read instructions carefully. Lay out all parts and tools in a clean area. Visually inspect parts for possible damage from shipping.

WARNING

Engine and exhaust system can be extremely hot. Let ATV cool down before beginning installation.

GENERAL PRECAUTIONS

WARNING

- * Proper service and repair procedures are important for the safety of the service mechanic and the safety and reliability of the ATV.
- * When two or more persons work together, pay attention to the safety of each other.
- * When it is necessary to run the engine indoors, make sure the exhaust gas is forced outdoors.
- * When working with toxic or flammable materials, make sure the area you work in is well ventilated and that you follow all of the manufacturer's instructions.
- * Never use gasoline as a cleaning solvent.
- * To avoid getting burned, do not touch the engine, engine oil, radiator, and exhaust system until they have cooled.

CAUTION

- * If parts replacement is necessary, replace the parts with SUZUKI Genuine Parts or their equivalent.
- * When removing parts that are to be reused, keep them arranged in an orderly manner so that they may be reinstalled in the proper order.
- * Use a torque wrench to tighten fasteners to the specified torque. Wipe off grease and oil if a thread is smeared with them.
- * After reassembling, check parts for tightness and proper operation.



Installation:

- 1 Remove stock exhaust system by following the below listed steps (See Fig. 1 & 2)
2. Loosen the muffler clamp bolt ①
3. Remove the two muffler clamp mounting bolts and save them. (A)
4. Remove the muffler ②
5. Remove the radiator lower mounting bolt and push lower end of the radiator forward. ③
6. Remove the thermostat cover ④ and thermostat (See below for thermostat removal instructions).
7. Remove the stock exhaust header pipe. ⑤

THERMOSTAT

REMOVAL

- Drain a small amount of engine coolant. (2%-14%)
- Place a rag under the thermostat case.
- Remove the two 8mm hex headed bolts and the thermostat cover.
- Remove the thermostat.

INSTALLATION

- Install the thermostat in the reverse order of removal.
- Apply engine coolant to the rubber seal on the thermostat.
- After installing the thermostat, be sure to add engine coolant.

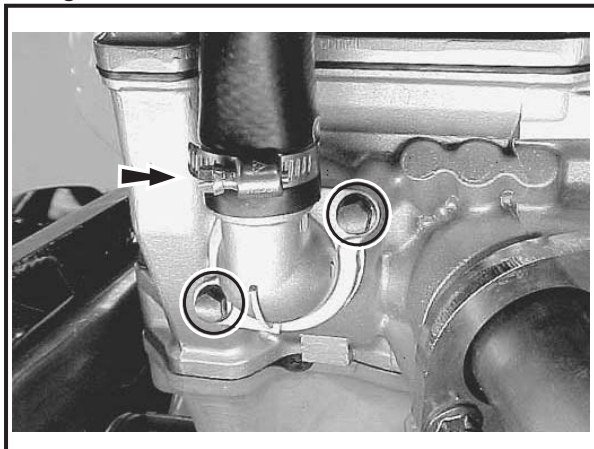

Fig. 1

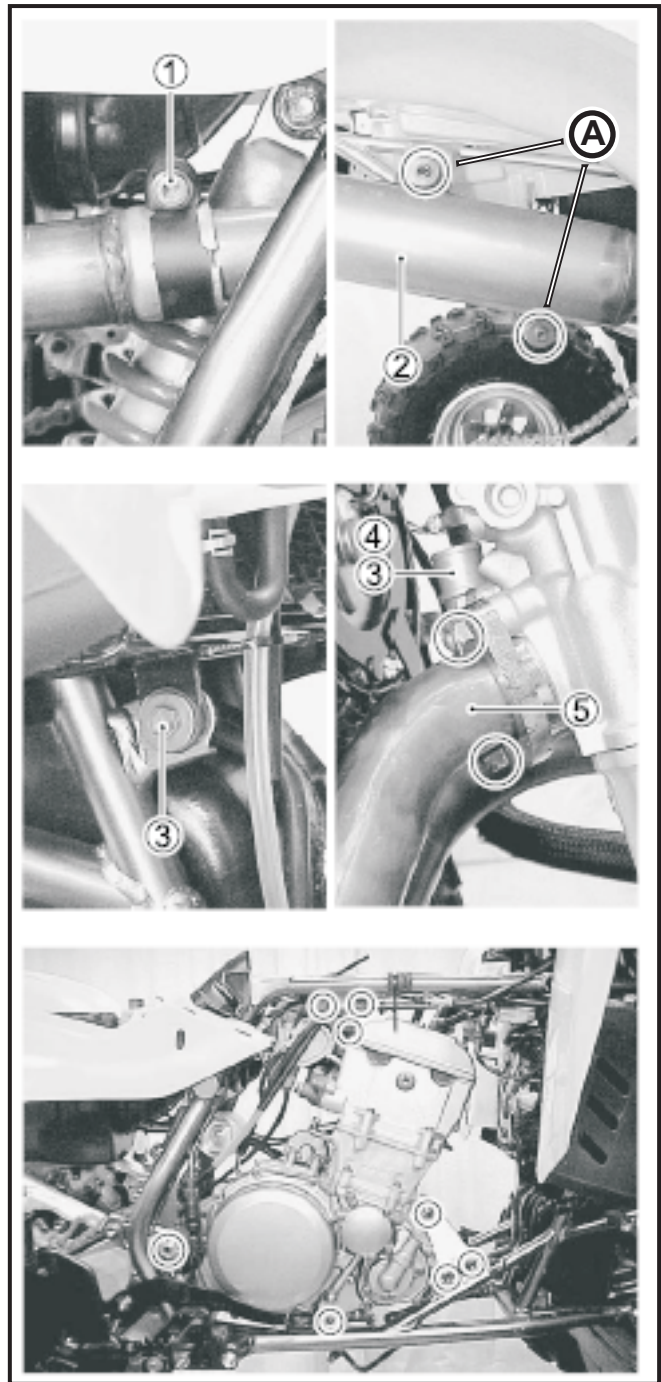

Fig. 2

Installation:

8. Install new exhaust port gasket.
Not supplied (Suzuki Part no. 14181-29E02)
9. Install performance header using stock header nuts. Do not tighten nuts at this point.
10. Remove rubber grommet and insert from stock lower muffler chassis mount and install on performance tailpipe lower chassis mount. (See Fig. 4)
11. Place collector clamp onto performance tailpipe with muffler and install onto performance header.
12. Bolt tailpipe to lower chassis mount using stock bolt and washer. Torque bolt to 2.5 kg-m (18 lb-ft).
13. Apply heat insulator to inside of muffler clamp and slide clamp onto muffler. (Note direction of clamp in Fig. 5)
14. Mount muffler clamp to upper chassis mount using supplied bolt, washer and spacer. (See Fig. 3)
15. Torque muffler clamp bolt to 2.5 kg-m (18 lb-ft).
16. Torque collector clamp to 1.25 kg-m (9 lb-ft)
17. Torque header nuts to 2.0 kg-m (14.6 lb-ft).
18. It is recommended that the entire exhaust system be wiped down with rubbing alcohol to remove oil and fingerprints. This will help prevent tarnishing of the finish after the exhaust is heated up.

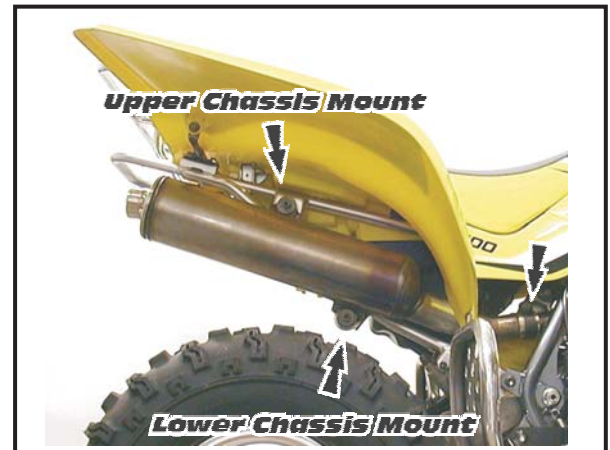

Fig. 3

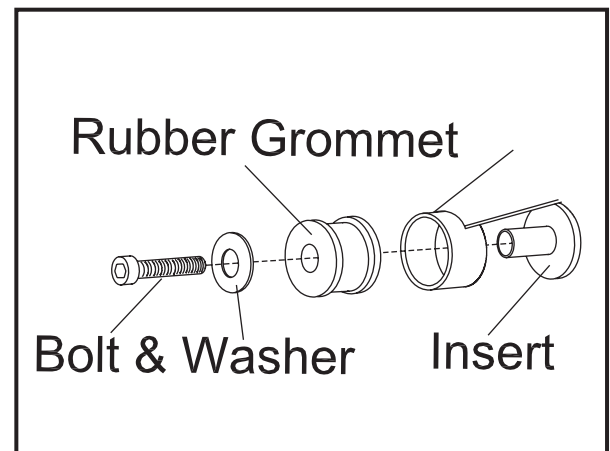

Fig. 4

WARNING
 Before starting ATV check for proper clearance between new exhaust system and ATV. (I.e. rear brake, frame, tire, etc.) If any problem is found, please carefully follow through the installation steps again.

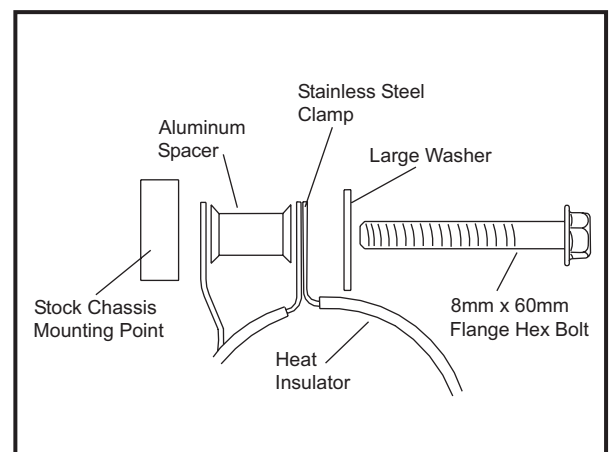

Fig. 5



Maintenance/Inspections:

Inspection and cleaning of Spark Arrester Assembly is advised after the first **2 hours** of operation, then once every 20 hours of operation.

CAUTION

Competition use requires muffler repacking every 10 hours.

Periodic Inspection and repacking of the muffler assembly is advised every 80 hours of recreational Riding.

WARNING

Gloves and Safety Glasses should be worn while repacking muffler assembly.

Muffler Repacking Steps:

Note: refer to parts diagram to identify component parts.

1. Using a 4mm allen wrench remove 4 hex head cap screws (item# 5) holding endcap assembly (items# 7-10) to stainless steel sleeve (item#12). Remove endcap assembly. Note: Endcap assembly is a very tight interference fit. A soft faced mallet may be necessary to assist in removal.
2. Using an electric drill with a 3/16" drill bit, carefully drill out the head of the rivets (item#2) attaching the stainless steel sleeve (item#12) to the front muffler adaptor (item#3).
3. Remove the stainless steel sleeve (item#12) and old packing material (item#11).
4. Install new packing material (item#11) tightly around steel wool on race baffle assembly (item#4). Ensure packing is evenly distributed from end to end on the race baffle assembly and is seated firmly against the front muffler adaptor (item#3).
5. Reassemble muffler in reverse of disassembly order.

Periodic inspection of exhaust system, mounting hardware, and all nuts and bolts is recommended.

CAUTION

When washing or operating ATV ensure water is not allowed into muffler assembly.

Stainless Steel Care: Stainless Steel is less prone to rusting, staining and pitting, but it will degrade, like all metals.

1. Wipe the exhaust with rubbing alcohol to remove any residue after installation and before starting your ATV.
2. Heat will turn your exhaust system a golden color; this is normal. Purple or blue may indicate a lean condition which should be corrected. Head pipes glowing (visible in normal light) may indicate an excessively lean condition that must be corrected.
3. Clean your exhaust with chrome/stainless polish every 1-2 months to retain the luster and remove dirt and grime.
4. If you ride in the snow, wipe the exhaust down after it cools to remove any possible salt residue, which can result in rusting. If you are storing your ATV for the season, wipe the exhaust system down with rubbing alcohol before storage.



Troubleshooting:

In the event of riding mishap where the exhaust system comes in contact with the ground or other objects, it is recommended that the exhaust be carefully inspected for damage and secure fit. If in doubt, replace damaged components.

COMPLAINT	SYMPTOM AND POSSIBLE CAUSES	REMEDY
Loss of performance.	1. Exhaust system damaged 2. Spark arrester screen clogged.	Replace damaged components. Clean spark arrester.

For technical assistance please contact Yoshimura R&D of America Inc., at (800)634-9166 / in CA (909)628-4722 or visit the website at www.Yoshimura-rd.com

Spark Arrester Cleaning:

WARNING

Muffler can be extremely hot. Let muffler cool down before removing spark arrester.

Tools Required:

4mm Allen Key Wire Brush
Safety Glasses Pair of Heavy Cotton Gloves

Cleaning Steps:

- 1 Using a 4mm Allen key remove the three 6mm x 16mm Button Head Screws located in the muffler end cap. (See Parts Diagram for location)
- 2 Remove the end cap, gasket and spark arrester from the muffler.

WARNING

Gloves and Safety Glasses should be worn while cleaning spark arrester.

- 3 Using a wire brush remove carbon deposits from spark arrester screen. Once cleaned, inspect the screen for excessive wear or damage. If any damage is found, the spark arrester **must** be replaced. Cleaning and inspection should be performed after every 20 hours of use.
- 4 Re-install spark arrester, gasket, end cap and 6mm x 16mm screws into muffler assembly. Torque screws to 1.0 kg-m (7.3 lb-ft)
(Note: It is recommended that Suzuki Thread Lock "1342" Pn# 99000-32050 be used on the screws.)

GENUINE SUZUKI ACCESSORIES