

# **SUZUKI** INSTALLATION INSTRUCTIONS

Description: Performance Exhaust System      Part Number: **99950-70511**  
 Applications: 2003- LT-Z250      Installation Time: **.75 hours**

Reference#	Description	Qty
1	Performance Exhaust with Muffler	1
2	Stainless Steel Collector Clamp	1

## Contents:

### Replacement parts:

99950-70503-PAK	LTZ Repack Kit
99950-70503-001	LTZ Endcap Gasket
99950-70503-002	LTZ Spark Arrestor
99950-70503-003	Nameplate Rivets
99950-70503-004	LTZ Yosh/Suz Nameplate



## Tools Required:

### Tools Description

10mm & 12mm Sockets  
 3/8" Ratchet Wrench with Extension  
 10mm & 12mm Wrench  
 4mm & 6mm Allen Wrench  
 3/8" Torque Wrench



## Important:

Please read this manual and follow the instructions carefully. To emphasize special information, the symbol  and the words **WARNING**, **CAUTION**, and **NOTE** have special meanings. Pay special attention to the messages highlighted by these signal words.

 **WARNING**

**CAUTION**

**NOTE:**

**NOTE:** Indicates special information to make maintenance easier or instructions clearer.

## **WARNING**

Indicates potential hazard that could result in death or injury.

## **CAUTION**

Indicates potential hazard that could result in vehicle damage.

**GENUINE SUZUKI ACCESSORIES**



## Preparation Prior to Installation

Read instructions carefully. Lay out all parts and tools in a clean area. Visually inspect parts for possible damage from shipping.

### WARNING

Engine and exhaust system can be extremely hot. Let ATV cool down before beginning installation.

## GENERAL PRECAUTIONS

### WARNING

- \* Proper service and repair procedures are important for the safety of the service mechanic and the safety and reliability of the ATV.
- \* When two or more persons work together, pay attention to the safety of each other.
- \* When it is necessary to run the engine indoors, make sure the exhaust gas is forced outdoors.
- \* When working with toxic or flammable materials, make sure the area you work in is well ventilated and that you follow all of the manufacturer's instructions.
- \* Never use gasoline as a cleaning solvent.
- \* To avoid getting burned, do not touch the engine, engine oil, radiator, and exhaust system until they have cooled.

### CAUTION

- \* If parts replacement is necessary, replace the parts with SUZUKI Genuine Parts or their equivalent.
- \* When removing parts that are to be reused, keep them arranged in an orderly manner so that they may be reinstalled in the proper order.
- \* Use a torque wrench to tighten fasteners to the specified torque. Wipe off grease and oil if a thread is smeared with them.
- \* After reassembling, check parts for tightness and proper operation.



## Installation:

1. Remove stock exhaust system by following the below listed steps (See Fig. 1)
2. Loosen the collector clamp bolt ①
3. Remove the two muffler mounting bolts and save them. ②
4. Remove the muffler ②
5. Remove rubber grommets and inserts from upper and lower stock muffler chassis mounts

**NOTE:** For ease of installation apply soapy water to rubber grommets prior to installation.

6. Install rubber grommets and inserts on upper (Fig 2) and lower (Fig. 3) performance muffler chassis mounts.
7. Loosen header mounting nuts at the exhaust port. Do not remove nuts or header.
8. Install supplied collector clamp onto tailpipe.

9. Slip muffler assembly onto stock header.

**NOTE:** Adjust header position slightly to ensure performance muffler upper and lower chassis mount are properly aligned.

10. Bolt performance muffler upper and lower chassis mounts to frame chassis mount positions using stock bolts and washers. Torque bolts to 2.5 kg-m (18 lb-ft). (See Fig. 4)
11. Torque collector clamp to 1.25 kg-m (9 lb-ft)
12. Torque header nuts to 1.0 kg-m (7 lb-ft)
13. It is recommended that the entire exhaust system be wiped down with rubbing alcohol to remove oil and fingerprints. This will help prevent tarnishing of the finish after the exhaust is heated up.

## ⚠ WARNING

Before starting ATV check for proper clearance between new exhaust system and ATV. (I.e. rear brake, frame, tire, etc.) If any problem is found, please carefully follow through the installation steps again.

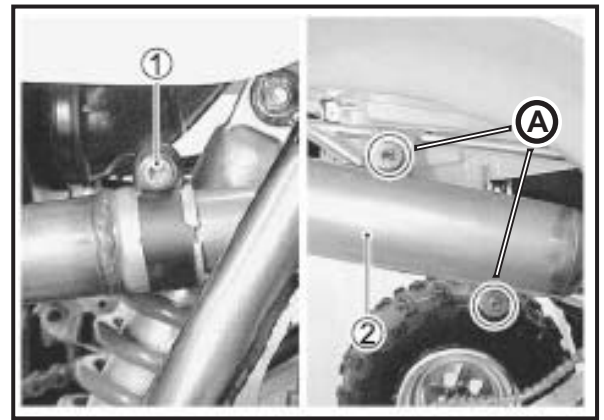

Fig. 1

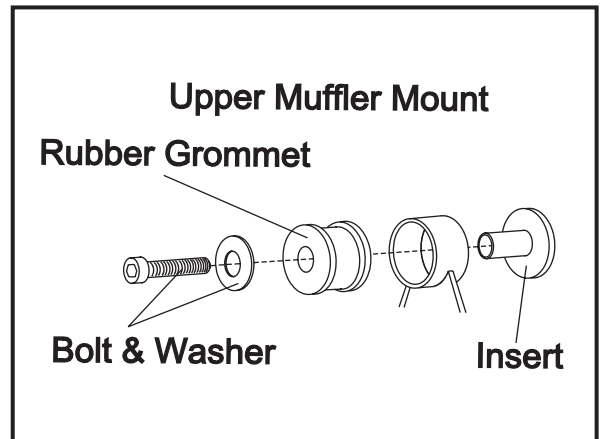

Fig. 2

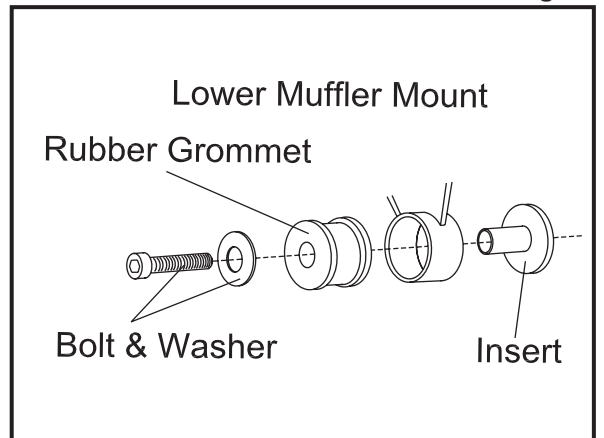

Fig. 3



Fig. 4



## Maintenance/Inspections:

Inspection and cleaning of Spark Arrester Assembly is advised after the first **2 hours** of operation, then once every 20 hours of operation.

### CAUTION

Competition use requires muffler repacking every 10 hours.

Periodic Inspection and repacking of the muffler assembly is advised every 80 hours of recreational Riding.

### WARNING

Gloves and Safety Glasses should be worn while repacking muffler assembly.

#### Muffler Repacking Steps:

Note: refer to parts diagram to identify component parts.

1. Using a 4mm allen wrench remove 4 hex head cap screws (item# 5) holding endcap assembly (items# 7-10) to stainless steel sleeve (item#12). Remove endcap assembly. Note: Endcap assembly is a very tight interference fit. A soft faced mallet may be necessary to assist in removal.
2. Using an electric drill with a 3/16" drill bit, carefully drill out the head of the rivets (item#2) attaching the stainless steel sleeve (item#12) to the front muffler adaptor (item#3).
3. Remove the stainless steel sleeve (item#12) and old packing material (item#11).
4. Install new packing material (item#11) tightly around steel wool on race baffle assembly (item#4). Ensure packing is evenly distributed from end to end on the race baffle assembly and is seated firmly against the front muffler adaptor (item#3).
5. Reassemble muffler in reverse of disassembly order.

Periodic inspection of exhaust system, mounting hardware, and all nuts and bolts is recommended.

### CAUTION

When washing or operating ATV ensure water is not allowed into muffler assembly.

**Stainless Steel Care:** Stainless Steel is less prone to rusting, staining and pitting, but it will degrade, like all metals.

1. Wipe the exhaust with rubbing alcohol to remove any residue after installation and before starting your ATV.
2. Heat will turn your exhaust system a golden color; this is normal. Purple or blue may indicate a lean condition which should be corrected. Head pipes glowing (visible in normal light) may indicate an excessively lean condition that must be corrected.
3. Clean your exhaust with chrome/stainless polish every 1-2 months to retain the luster and remove dirt and grime.
4. If you ride in the snow, wipe the exhaust down after it cools to remove any possible salt residue, which can result in rusting. If you are storing your ATV for the season, wipe the exhaust system down with rubbing alcohol before storage.



## Troubleshooting:

In the event of riding mishap where the exhaust system comes in contact with the ground or other objects, it is recommended that the exhaust be carefully inspected for damage and secure fit. If in doubt, replace damaged components.

COMPLAINT	SYMPTOM AND POSSIBLE CAUSES	REMEDY
Loss of performance.	1. Exhaust system damaged 2. Spark arrester screen clogged.	Replace damaged components. Clean spark arrester.

For technical assistance please contact Yoshimura R&D of America Inc., at (800)634-9166 / in CA (909)628-4722 or visit the website at [www.Yoshimura-rd.com](http://www.Yoshimura-rd.com)

## Spark Arrester Cleaning:

### WARNING

Muffler can be extremely hot. Let muffler cool down before removing spark arrester.

## Tools Required:

4mm Allen Key      Wire Brush  
Safety Glasses      Pair of Heavy Cotton Gloves

## Cleaning Steps:

- 1 Using a 4mm Allen key remove the three 6mm x 16mm Allen Head Screws located in the muffler end cap.
- 2 Remove the end cap, gasket and spark arrester from the muffler.

### WARNING

Gloves and Safety Glasses should be worn while cleaning spark arrester.

- 3 Using a wire brush remove carbon deposits from spark arrester screen. Once cleaned, inspect the screen for excessive wear or damage. If any damage is found, the spark arrester **must** be replaced. Cleaning and inspection should be performed after every 20 hours of use.
- 4 Re-install spark arrester, gasket, end cap and 6mm x 16mm screws into muffler assembly. Torque screws to 1.0 kg-m (7.3 lb-ft)  
(Note: It is recommended that Suzuki Thread Lock "1342" Pn# 99000-32050 be used on the screws.)

**GENUINE SUZUKI ACCESSORIES**