



YOSHIMURA

RESEARCH&DEVELOPMENT OF AMERICA, INC.

5420 DANIELS STREET STE A, CHINO CA., 91710 · (800)634-9166 · (909)628-4722 · FACSIMILE (909)591-2198

www.yoshimura-rd.com

RS-3 OVAL PERFORMANCE EXHAUST SYSTEM

HONDA

'97-02

CBR1100XX

CB136RR

STAINLESS STEEL RACE FULL SYSTEM

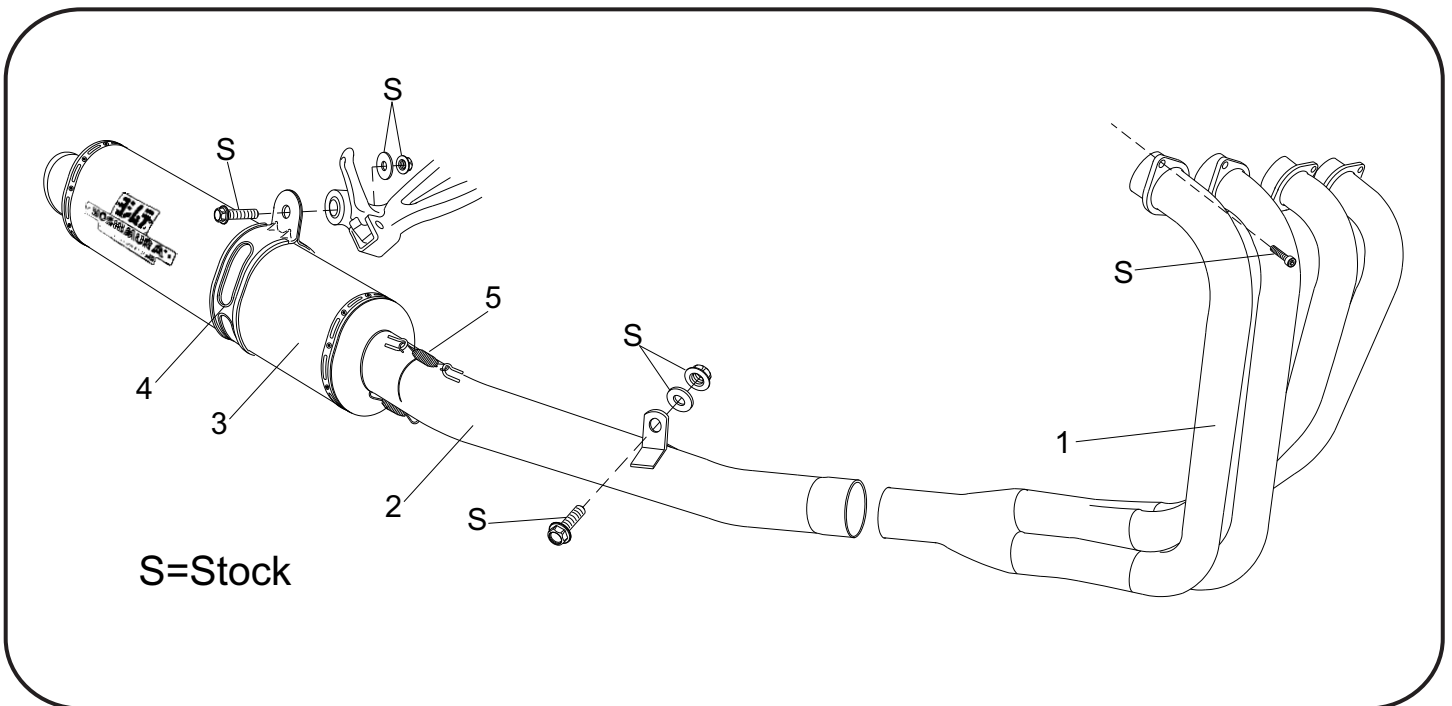

Parts Diagram

NO.	DESCRIPTION	QTY	PART #
1	Yoshimura Header Stainless Steel Race	1	CB136RRH
2	Yoshimura Tailpipe Stainless Steel Race	1	CB136RTW
3	RS-3 Oval Muffler Assembly	1	**
4	Stainless Steel Muffler Clamp Stainless Steel or Titanium Sleeve uses Carbon Fiber Sleeve uses	1	COS450S8SX COS450S8AS

NO.	DESCRIPTION	QTY	PART #
5	2.3" Race Springs	2	RACE-SPS
**	Muffler Clamp Heat Insulator	1	HT SHLDTRS
**	Low Volume Sound Insert	1	RS3-INS-K
**	Yoshimura Vinyl Sticker	1	17029



THIS PRODUCT IS DESIGNED FOR USE IN CLOSED COURSE RACING AND IS NOT INTENDED FOR HIGHWAY USE.



NOTE: IN THE STATE OF CALIFORNIA, IT IS ILLEGAL TO MODIFY THE EMISSION CONTROL SYSTEM. WHICH INCLUDES THE CARBURETORS OF ANY VEHICLE.

Caution: Exhaust system can be extremely hot. Let motorcycle cool down before beginning installation.

Note: Read through all instructions before beginning installation.

Installation Steps:

- 1 Remove cowlings.
- 2 Remove stock exhaust system.
- 3 Replace old exhaust port gasket with new exhaust port gasket. (not supplied)
- 4 Install Yoshimura header using stock bolts. Do not tighten.
- 5 Remove stock centerstand grommet from stock tailpipe. Install on Yoshimura tailpipe centerstand bracket.
- 6 Install Yoshimura tailpipe with muffler onto the header.
- 7 Bolt tailpipe chassis mount to frame chassis mount using the stock bolt, washer and nut.
- 8 Insert heat insulator into muffler clamp and slide over muffler. (See Fig. 1)
- 9 Bolt muffler clamp to outside of stock passenger footpeg mount using stock bolt, washer and nut.
- 10 Torque stock chassis mount bolt to 2.5 kg-m (18 lb-ft).
- 11 Torque header bolts to 0.8 kg-m (6 lb-ft).
- 12 It is recommended that the entire exhaust system be wiped down with rubbing alcohol to remove oil and fingerprints. This will help prevent tarnishing of the finish after the exhaust is heated up.
- 13 Re-install cowlings.
- 14 Check for proper clearance between new exhaust system and motorcycle. (i.e. Cowlings, radiator, oil pan, swing-arm etc.) If any problem is found, please carefully follow through the installation steps again. If problem still persists, please call Yoshimura tech. department at (800)634-9166 / in CA (909)628-4722.

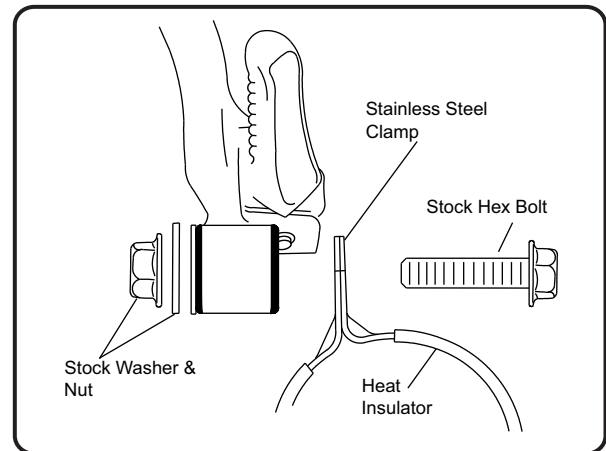

Fig. 1

15 Reinstall cowlings.

16 Check for proper clearance between new exhaust system and cowling.

Note: After starting motorcycle, it is normal for new exhaust system to smoke until oil residue burns off.