



YOSHIMURA

RESEARCH&DEVELOPMENT OF AMERICA, INC.

5420 DANIELS STREET STE A, CHINO CA., 91710 · (800) 634-9166 · (909) 628-4722 · FAX (909) 591-2198

www.yoshimura-rd.com

Street Series

Qualified Manufacturer Declared "Replacement Part"

**2000~2001
CBR929RR**

**2002~2003
CBR954RR**

CB93250 (SS/AL)

RS-1 Zyclone Stainless Steel Bolt-On

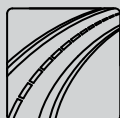

All Street Series systems are:

- Slip-on/Bolt-on applications that do not require tampering with the vehicle's emissions control system.
- CARB/EPA tail-pipe emissions compliant.
- Marked with appropriate EPA noise labels.
- Not tested for EPA new vehicle noise compliance.

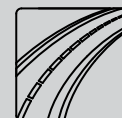

✘ You must know how to remove and replace your stock exhaust in order to install this product otherwise have it installed by a professional mechanic. Keep all stock parts from your existing system as some components may be necessary to install your new Yoshimura exhaust depending on the application. Read through all instructions before beginning installation. Exhaust system can be extremely hot. Let motorcycle cool down before beginning installation. Always wear hand and eye protection and take precautionary measures to avoid injury. ✘

NOTE: IN THE STATE OF CALIFORNIA, IT IS ILLEGAL TO MODIFY THE EMISSION CONTROL SYSTEM, WHICH INCLUDES THE CARBURETORS OF ANY VEHICLE.

Caution: Exhaust system can be extremely hot. Let motorcycle cool down before beginning installation.

Note: Read through all instructions before beginning installation.

Tools Needed:

- 12mm socket
- 3/8" ratchet and extension
- 12mm wrench
- Torque wrench

Installation Steps:

- 1 Remove stock muffler and gasket.
- 2 Install new muffler gasket.
(Not supplied-Honda part no. 18292-MCJ-000)
- 3 Install Yoshimura muffler using supplied bolts. Torque bolts to 2.3 kg-m (16.5 lb-ft)
- 4 Apply heat insulator to inside of muffler clamp and slide clamp onto muffler. (note direction of clamp in Fig. 2)
- 5 Mount clamp to stock muffler bracket using stock bolt, washer, and nut. (see Fig. 2)
Torque bolt to 2.5 kg-m (18 lb-ft)
- 6 Before starting, check for proper clearance between new muffler and motorcycle. (i.e. swing-arm, passenger foot-peg, rear wheel, etc.) If any problem is found, please carefully follow through the installation steps again. If problem still persists, please call Yoshimura tech. Dept. at (800)634-9166 / in CA (909)628-4722

Note: After starting motorcycle, it is normal for new muffler to smoke until oil residue burns off.

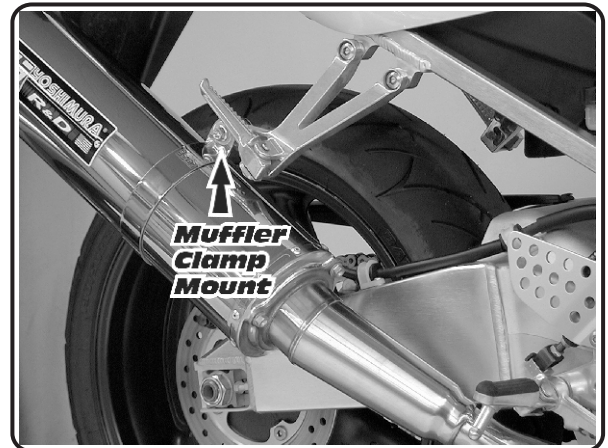

Fig. 1

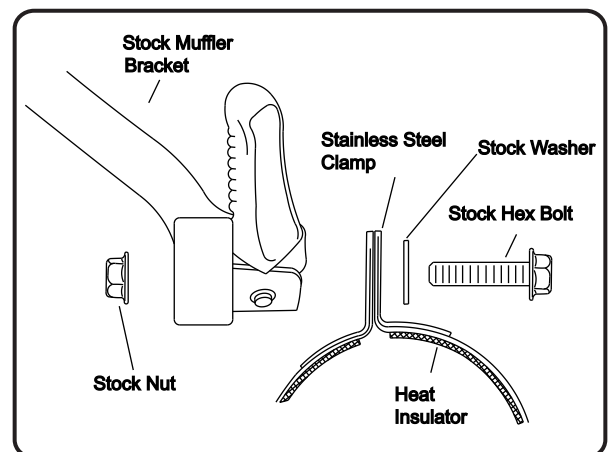
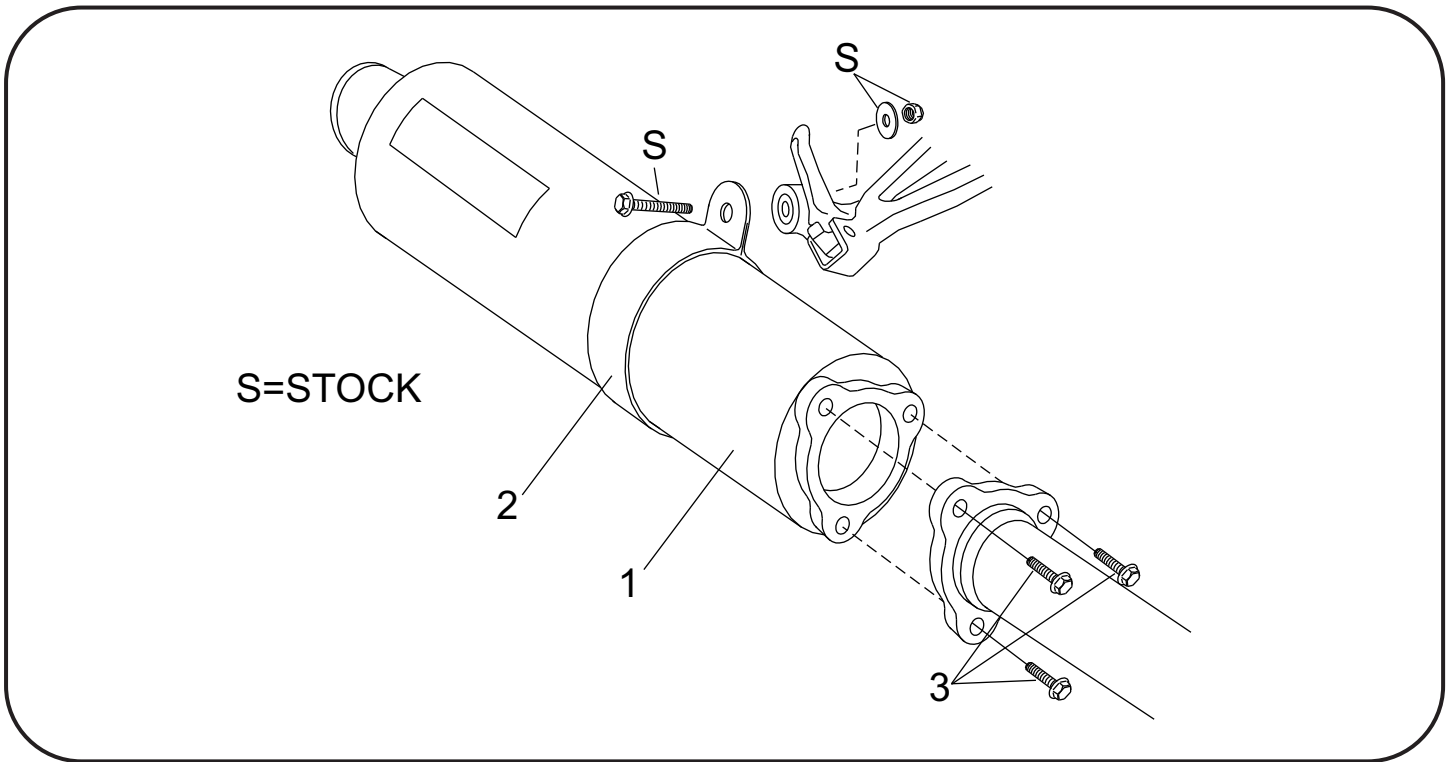

Fig. 2

#CB930SOC/CB93250



Parts Diagram

NO.	DESCRIPTION	QTY	PART #
1	Muffler Assembly	1	**
2	Stainless Steel Muffer Clamp	1	C500S8ASX
3	8 x 20mm Hex Head Bolt	3	M8X20H
**	5" Heat Insulator	1	HT SHLD5
**	Yoshimura Vinyl Sticker	1	17029

Nuts and Bolts Guide (Actual Size):

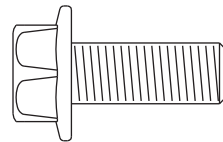

8mm x 20mm
Flange Hex Bolt