



YOSHIMURA

RESEARCH&DEVELOPMENT OF AMERICA, INC.

5420 DANIELS STREET STE A, CHINO CA., 91786 · (800)634-9166 · (909)628-4722 · FACSIMILE (909)591-2198

www.yoshimura-rd.com

RS-3 OVAL PERFORMANCE EXHAUST SYSTEM

00-08 SUZUKI DR400Z

03-04 KAWASAKI KLX400

D461AFS-SA

STAINLESS STEEL FULL SYSTEM



THIS PRODUCT IS DESIGNED FOR USE IN CLOSED COURSE RACING AND IS NOT INTENDED FOR HIGHWAY USE.



NOTE: IN THE STATE OF CALIFORNIA, IT IS ILLEGAL TO MODIFY THE EMISSION CONTROL SYSTEM, WHICH INCLUDES THE CARBURETORS OF ANY VEHICLE.

Caution: Exhaust system can be extremely hot. Let motorcycle cool down before beginning installation.

Note: Read through all instructions before beginning installation.

Tools Needed:

8mm, 10mm, and 12mm sockets
3/8" ratchet and extension
6mm Allen bit for torque wrench
Torque wrench

Installation Steps:

- 1 Remove right rear number plate.
(See Fig. 1 for fastener locations.)
- 2 Remove stock exhaust system and exhaust port gasket.
- 3 Install new exhaust port gasket, not supplied.
(Suzuki Part number 14181-29E02)
- 4 Install Yoshimura header using stock exhaust bolt and nut. Do not tighten at this point.
- 5 Install muffler and tail-pipe assembly onto header.
- 6 Bolt tail-pipe to chassis mount using stock bolt.
See (Fig. 2) Do not tighten bolt at this point.



Fig. 1



Fig. 2

- 7 Apply heat insulator to inside of muffler clamp and slide clamp onto muffler.
(Note direction of clamp in Fig. 3)
- 8 Mount muffler clamp to chassis using supplied bolt, spacer and stock nut. (See Fig. 3)
Torque bolt to 2.5 kg-m (18 lb-ft).
- 9 Torque chassis mount bolt to 2.5 kg-m (18 lb-ft) and header bolt and nut to 1.5 kg-m (11.0 lb-ft).
- 10 It is recommended that the entire exhaust system be wiped down with rubbing alcohol to remove oil and fingerprints. This will help prevent tarnishing of the finish after the exhaust is heated up.
- 11 Before starting motorcycle check for proper clearance between new exhaust system and rear suspension (i.e. rear brake, frame, shock spring, etc). If any problem is found, please carefully follow through the installation steps again. If problem still persists, please call Yoshimura tech. Dept. at (800)634-9166 / in CA (909) 628-4722
- 12 Reinstall number plate.
- 13 Check for proper clearance between new exhaust system and number plate.

Note: After starting motorcycle, it is normal for new exhaust system to smoke until oil residue burns off.

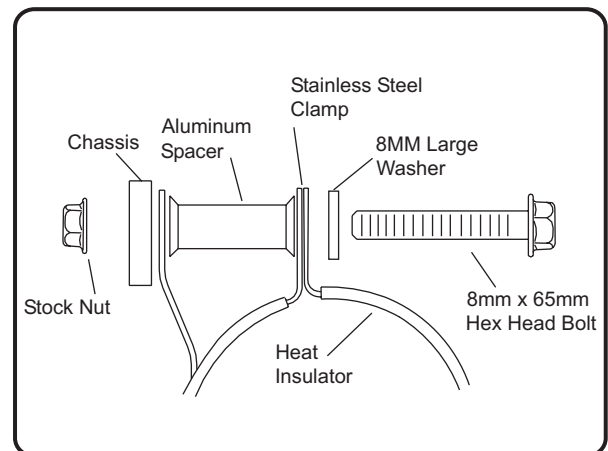
**Fig. 3**

#D461AFS-SA

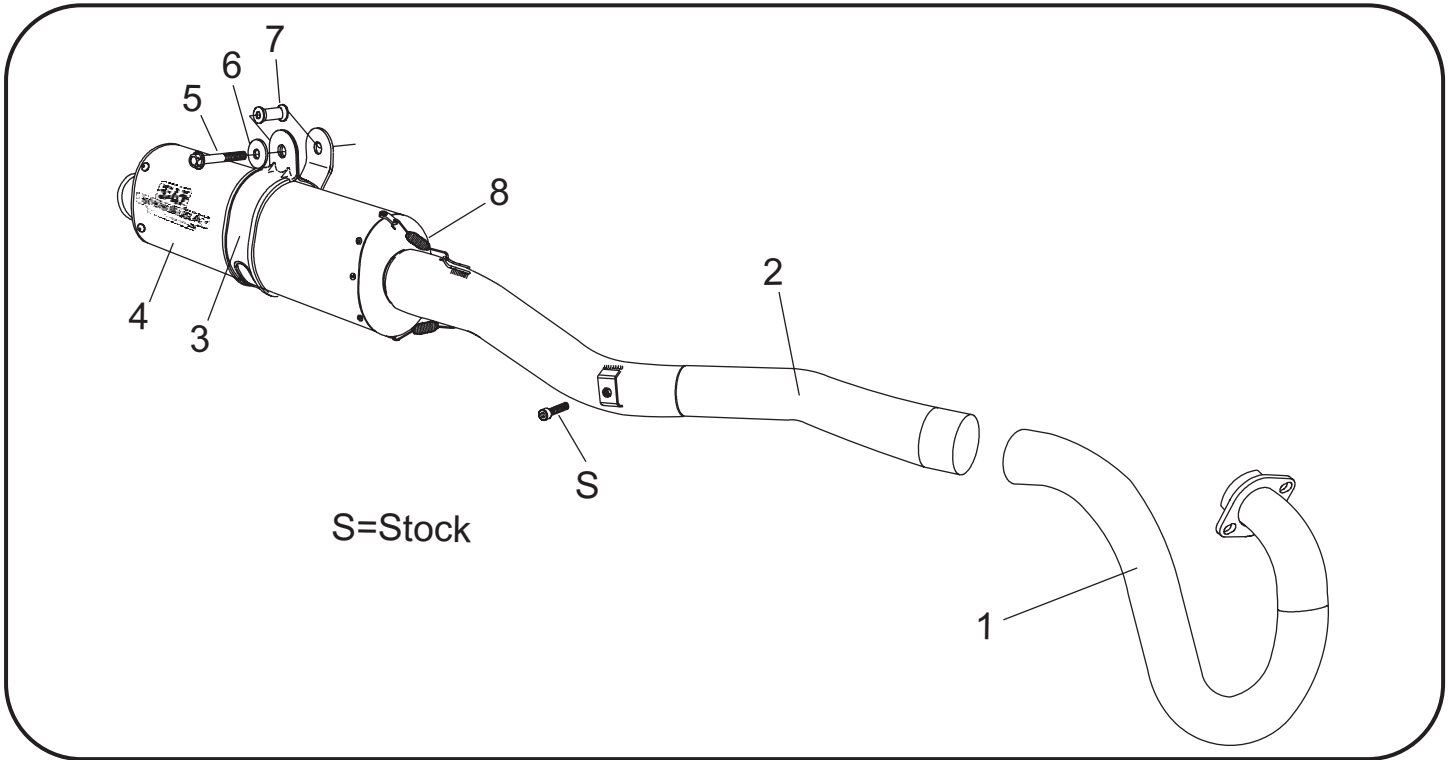

S=Stock

Parts Diagram

NO.	DESCRIPTION	QTY	PART #
1	Yoshimura Stainless Steel Header	1	D461SRRH
2	Yoshimura Stainless Steel Tailpipe	1	D461ASRT
3	Stainless Steel Muffler Clamp	1	CCS400S8ASD
**	Muffler Clamp Heat Insulator	1	HT SHLD-14A
4	RS-3 Muffler Assembly	1	**
5	Hex Head Bolt	1	M8x65H
6	8MM Large Washer	1	8MMWASHERL
7	43mm Aluminum Spacer	1	8MMFS
8	2.5' Exhaust Spring	2	RACE-SPS-1
**	Spring Puller Tool	1	ST-200
**	Yoshimura Vinyl Sticker	1	17029

OPTIONAL ACCESSORIES	PART #
Tunable Endcap Option - includes Low & Medium sound spark arrested inserts	TEC-KIT

Nuts and Bolts Guide (Actual Size):

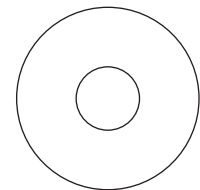

8mm Large Flat Washer

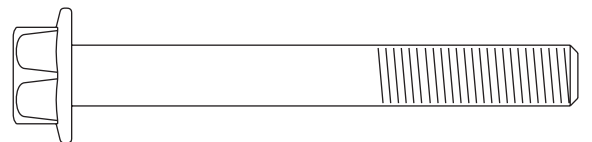

8mm x 65mm
Flange Hex Bolt

JETTING RECOMMENDATION

When using the stock carburetor, change the main jet to a 168 and raise the needle by moving the needle clip down one position.



YOSHIMURA

RESEARCH&DEVELOPMENT OF AMERICA, INC.

4555 CARTER COURT, CHINO CALIF. 91710 · (800)634-9166 · (909)628-4722 · FACSIMILE (909)591-2198

www.yoshimura-rd.com

TEC-SA Spark Arrester Cleaning Information

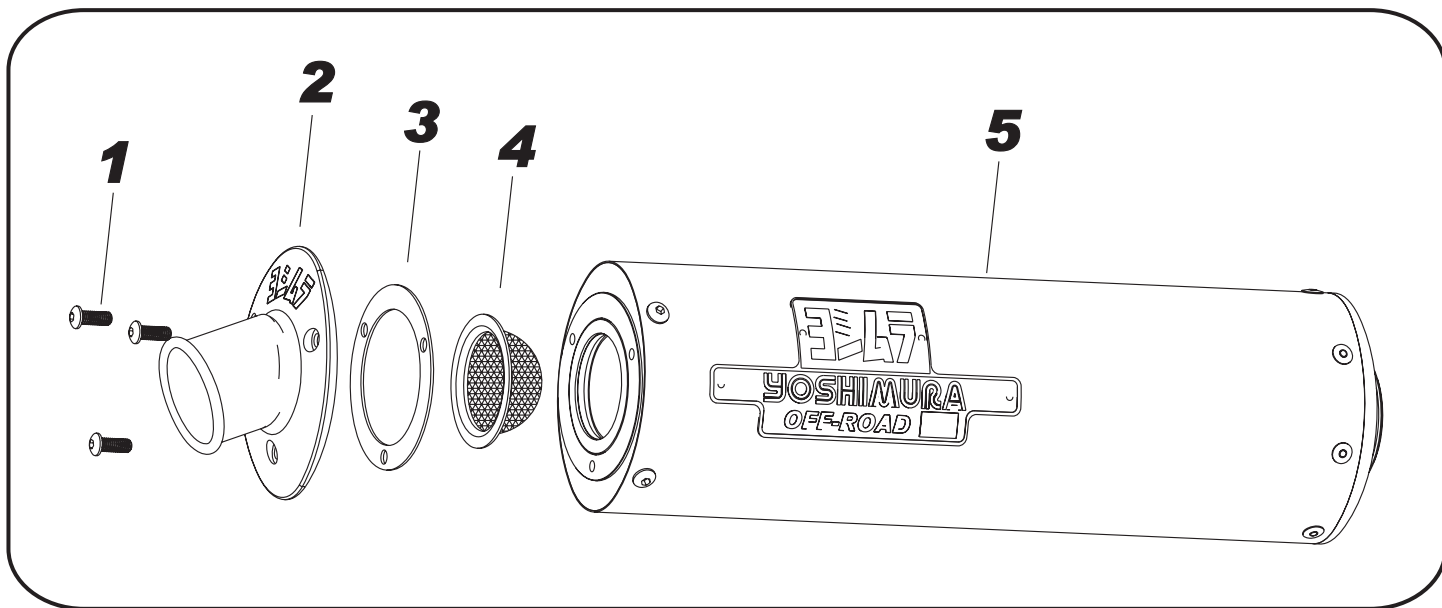

Parts Diagram

Caution: *Muffler can be extremely hot. Let muffler cool down before removing spark arrester.*

Note: *Read through all instructions before beginning disassembly.*

NO.	DESCRIPTION	QTY
1	6 x 1.0mm x 16mm Button Head Screw	3
2	4.0" YRD End Cap, Cover	1
3	T.E.C. End Cap, Gasket	1
4	T.E.C. End Cap, Spark Arrester	1
5	Muffler Assembly	1

Tools Needed:

4mm Allen Key
Wire Brush
Pair of Gloves
Safety Glasses

Cleaning Steps:

1 Using a 4mm Allen key remove the three 6mm x 16mm Button Head Screws located in the muffler end cap. (See Parts Diagram for location)

2 Remove the end cap, gasket and spark arrester from the muffler.

3 Using a wire brush remove carbon deposits from spark arrester screen. Once clean inspect the screen for excessive wear or damage, if any is found the spark arrester must be replaced. Cleaning and inspection should be performed after every 60 hours of use.

(Caution: Gloves and Safety Glasses should be worn while cleaning spark arrester.)

4 Re-install spark arrester, gasket, end cap and 6mm x 16mm screws into muffler assembly. Torque screws to 1.0 kg-m (7.3 lb-ft)

(Note: It is recommended that a low strength "Loctite" is used on the screws.)