



# YOSHIMURA

RESEARCH & DEVELOPMENT OF AMERICA, INC.

5420 DANIELS STREET SUITE A, CHINO, CA 91710 · (800)634-9166 · (909)628-4722 · FACSIMILE (909)591-2198

[www.yoshimura-rd.com](http://www.yoshimura-rd.com)

<b>INS-01-K</b>	<b>YOSHIMURA R55 INSERT KIT FOR CF ENDCAPS</b>
<b>INS-02-K</b>	<b>YOSHIMURA R55 INSERT KIT FOR SS ENDCAPS</b>

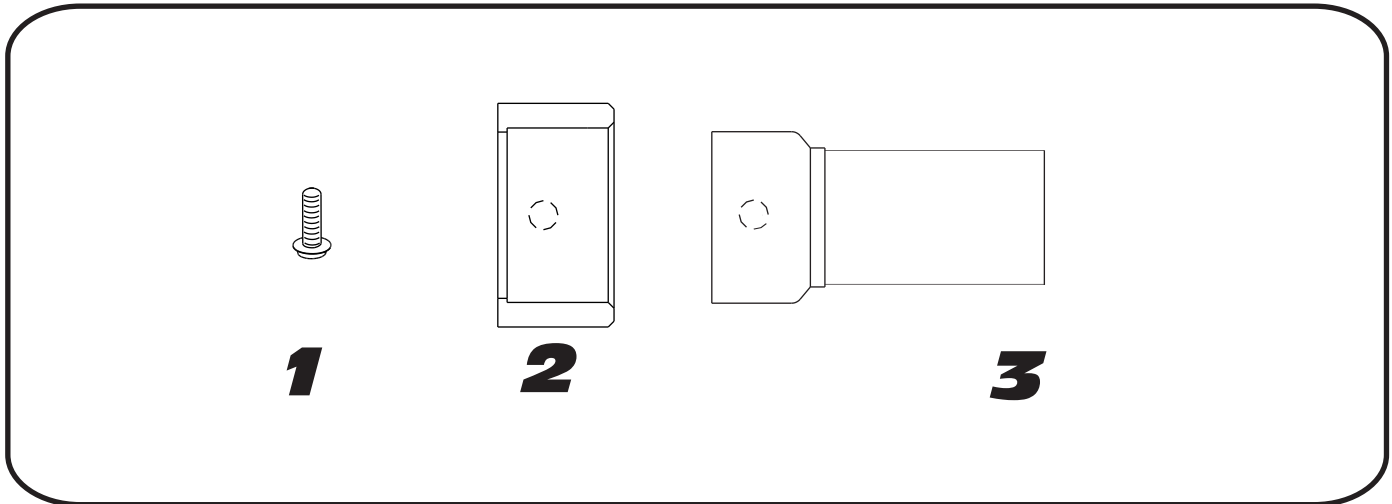

Parts Diagram

NO.	DESCRIPTION	QTY	PART #
1	Button Head Cap Screw 6mm x 22mm Button Head Screw (For SS Endcaps) 6mm x 12mm Button Head Screw (For CF Endcaps)	1	M6X22BHS M6X12BHS
2	Low Volume Insert Ring 1.5"	1	R55-RING-1500
3	R55 Low Volume Insert	1	R55-INS / YM6-INS
**	6mm Tooth Lock Washer	1	6MMLCKWSHR-TH
**	(For CF Endcap only) Grommet	1	GRMT

**Caution:** Muffler can be extremely hot. Let muffler cool down before installing sound inserts.

**Note:** Read through all instructions before beginning disassembly.

### Tools Needed:

4mm Allen Key

### Installation Steps:

1. Place aluminum ring over insert. Make sure to align the hole on the insert with the hole on the ring.
2. Place insert inside the outlet of Yoshimura muffler.
3. Secure insert using supplied button head cap screw and lock washer from outside. Torque to 8 lb-ft.

**NOTE:** It is recommended that a low strength "Loc-tite" is used on the button head cap screw.

4. For carbon fiber endcap mufflers, remove rubber grommet and drill hole through stainless endcap tip. (Drill where you see the circular recess in the tip.)
5. For carbon fiber mufflers insert supplied grommet into hole in carbon fiber endcap.