



YOSHIMURA

RESEARCH & DEVELOPMENT OF AMERICA, INC.

5420 DANIELS STREET SUITE A, CHINO, CA 91710 · (800)634-9166 · (909)628-4722 · FACSIMILE (909)591-2198

www.yoshimura-rd.com

INS-E-K Sound Insert Installation Instructions

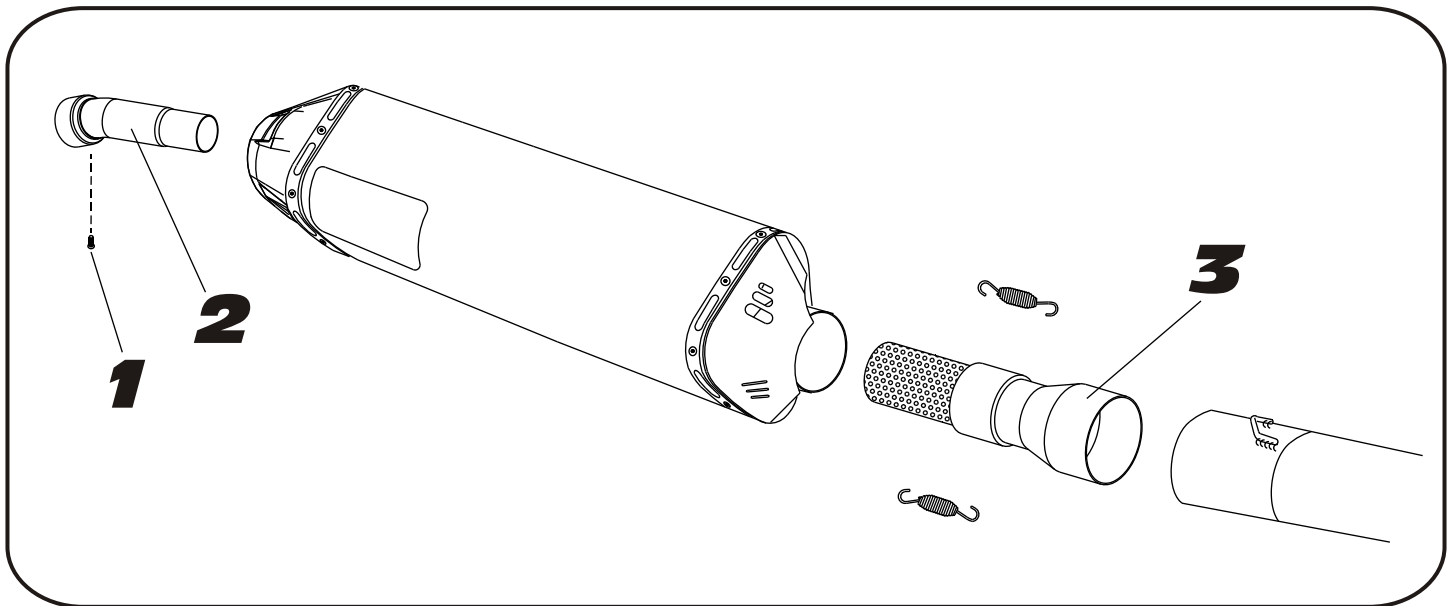

Parts Diagram

NO.	DESCRIPTION	QTY	PART #
1	6 x 1.0mm x 6mm Button Head Screw	1	M6X6BHS
2	TRS Rear Low Volume Insert	1	TRS-INS
3	Front Tailpipe Insert	1	INS-E
**	Yoshimura Stickers	2	17020C

Caution: *Muffler can be extremely hot. Let muffler cool down before installing sound inserts.*

Note: *Read through all instructions before beginning disassembly.*

Tools Needed:

4mm Allen Key
Spring Puller Tool

Installation Steps:

- 1 Remove muffler from tailpipe.
- 2 Insert the front insert into the tailpipe.
- 3 Reinstall the muffler.
- 4 Insert the rear insert into the end of the muffler and secure using the small allen head bolt.

NOTE: *It is recommended that a low strength "Loc-tite" is used on the small allen head bolt.*