



YOSHIMURA

RESEARCH & DEVELOPMENT OF AMERICA, INC.

5420 DANIELS STREET STE A, CHINO CALIF. 91710 · (800)634-9166 · (909)628-4722 · FACSIMILE (909)591-2198

www.yoshimura-rd.com

R-K2005

2010 BMW S1000RR Fender Eliminator Kit



NOTE:

Yoshimura R&D is not liable or responsible for any resulting event caused by installation of this product. Check with local laws and regulations for compliance prior to installation and use. This product is designed and specified for off-road applications only and is not intended for use on public high-ways.

Installation Instructions:

1. Remove Rear Cowl or Passenger seat and disconnect rear tail light and turn signal harness plug.
2. Remove fender assembly by unbolting 3 Torx bolts. Remove tail light and turn signal harness from fender assembly. Disconnect the turn signal wires from the turn signals by removing the lamp cover and disassemble stock turn signals from fender assembly.
3. Remove undertail cowl by unbolting 6 Torx bolts from underneath.
4. Remove 2 front spacers as indicated in Fig. 1. Reinstall cowl using 6 stock Torx bolts.



Fig. 1

5. Assemble Yoshimura Fender Eliminator Kit as shown in Parts Diagram. Fender Bracket is mounted to stock subframe using stock Torx bolts.

6. Attach Yoshimura Fender Eliminator Kit beneath rear undertail using supplied hardware as shown in Parts Diagram. Do not tighten bolts to subframe at this time.

7. Cut off and remove 2" of the sleeve at the middle of the harness where the wires split off to each of the turn signals and to the rear license plate illumination light. Cut off the stock license plate illumination light wires 75mm away from the light.

8. Route license plate light and turn signal harness through stock opening in undertail cowling.

9. Tighten Yoshimura Fender Eliminator mounting bolts to subframe. Torque to 7.0 ft-lbs (10 N-m).

10. Using the supplied butt connectors, connect the license plate illumination light wires to the plate light and turn signal harness as follows:

| Yoshimura FE Wire | ----- | Stock Sub-harness |
|--------------------------|--------------|--------------------------|
| Red Wire | ----- | Green Wire |
| Black Wire | ----- | Brown Wire |

(Note: Use of soldering and heat shrink tubing is recommended)

11. Attach stock turn signals to Yoshimura fender assembly.

12. Route stock turn signal wires and connect to the stock turn signals, inserting wires through the stock turn signal mounting stalks. Note the (+) and (-) as shown in Fig 2. Note:

| Turn Signal Wire | ---- | Description |
|-------------------------|-------------|-----------------------|
| Green w/ White Stripe | ---- | Left Turn Signal (+) |
| Blue w/ Black Stripe | ---- | Right Turn Signal (+) |
| Brown | ---- | Ground (-) |

13. Secure the wires inside the tail section and route the wires to prevent loose wires and/or connections.

14. Reinstall cowl cover or rear seat.

6. Check for function of license plate light and turn signals and that all brackets and components are secure prior to riding.

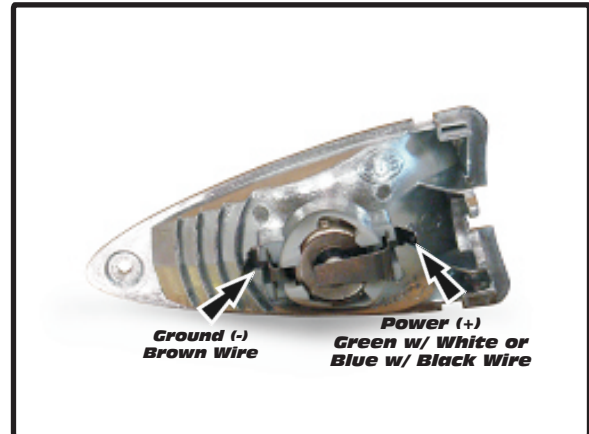
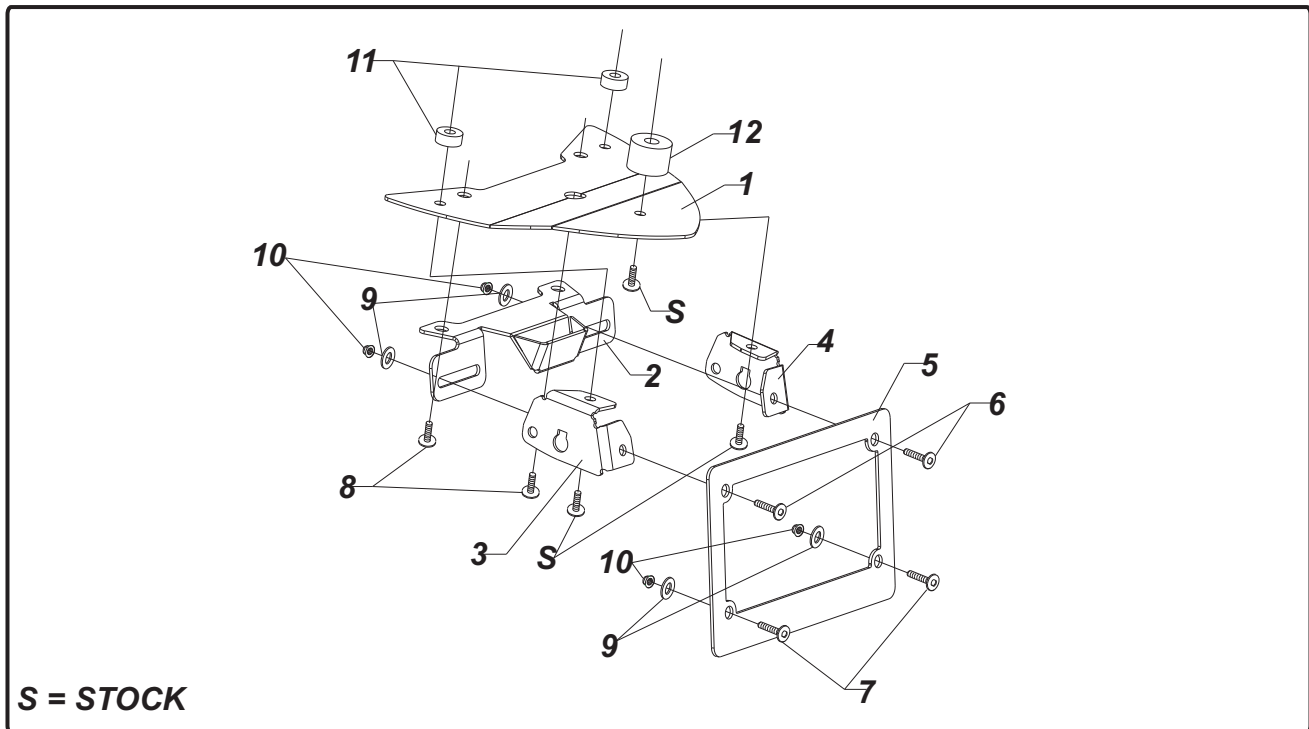

Fig. 2



| NO. | DESCRIPTION | QTY | PART # |
|------------|--------------------------------------|------------|----------------|
| 1 | Fender Eliminator Bracket | 1 | 1520-FEB-00 |
| 2 | License Plate Bracket | 1 | 1118-LPB |
| 3 | Left Turn Signal Bracket (Optional) | 1 | 1520-TSLBKT-00 |
| 4 | Right Turn Signal Bracket (Optional) | 1 | 1520-TSRBKT-00 |
| 5 | License Plate Frame | 1 | 1118-LPF |
| 6 | 6mm x 16mm Button Head Screw | 2 | M6X16BHS |
| 7 | 6mm x 12mm Button Head Screw | 2 | M6X12BHS |
| 8 | 6mm x 6mm Button Head Screw | 2 | M6X6BHS |
| 9 | 6mm Flat Washer | 4 | 6MMWASHER |
| 10 | 6mm Nylon Lock Nut | 4 | 6MMLN |
| 11 | 6mm Aluminum Spacer | 2 | 6X7SPC |
| 12 | 8mm Aluminum Spacer | 1 | 8X17SPC |
| *** | Butt Connectors | 2 | 94785-01-ND |
| *** | Cable Tie | 3 | ZT-200 |
| *** | Yoshimura Sticker Sheet | 1 | 17029 |
| *** | Instructions Manual | 1 | INST KIT |