



# YOSHIMURA

RESEARCH&DEVELOPMENT OF AMERICA, INC.

5420 DANIELS STREET STE A, CHINO CA., 91786 · (800)634-9166 · (909)628-4722 · FACSIMILE (909)591-2198

[www.yoshimura-rd.com](http://www.yoshimura-rd.com)

## RS-3 OVAL PERFORMANCE EXHAUST SYSTEM

**SUZUKI**  
**'94-96**  
**RF900**

<b>RF90850C</b>	RS-3 ZYCLONE BOLT-ON SYSTEM
<b>RF90950</b>	RS-3 RACE BOLT-ON SYSTEM

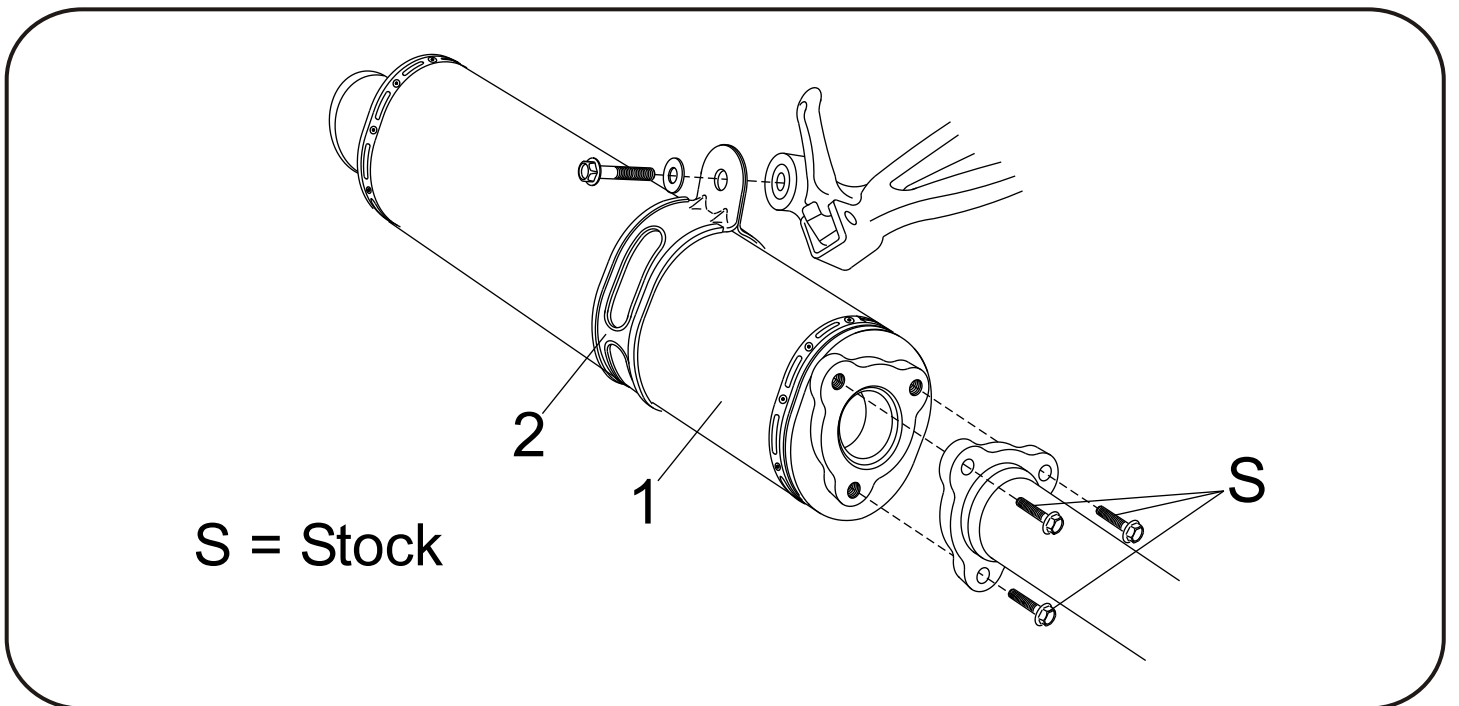

Parts Diagram

NO.	DESCRIPTION	QTY	PART #
1	RS-3 Oval Bolt-On Muffler Assembly	1	**
2	Stainless Steel Muffler Clamp Stainless Steel or Titanium Sleeve uses Carbon Fiber Sleeve uses	1	COS450S8ASX COS450S8AS
**	Muffler Clamp Heat Insulator	1	HT SHLDTRS
**	Instructions	1	INST KIT
**	Yoshimura Sticker	1	17029



**THIS PRODUCT IS DESIGNED FOR USE IN CLOSED COURSE RACING AND IS NOT INTENDED FOR HIGHWAY USE.**



NOTE: IN THE STATE OF CALIFORNIA, IT IS ILLEGAL TO MODIFY THE EMISSION CONTROL SYSTEM, WHICH INCLUDES THE CARBURETORS OF ANY VEHICLE.

**Caution:** Exhaust system can be extremely hot. Let motorcycle cool down before beginning installation.

**Note:** Read through all instructions before beginning installation.

## Tools Needed:

12mm socket  
3/8" ratchet  
12mm and 14mm wrenches  
Torque wrench

## Installation Steps:

- 1 Remove stock muffler and muffle gasket.
- 2 Install new muffler gasket.  
(Not supplied)
- 3 Install Yoshimura muffler using stock bolts.  
Torque bolts to 2.3 kg-m (16.5 lb-ft). **NOTE:** Use of a high strength thread lock is recommended.
- 4 Apply muffler clamp heat insulator to inside of muffler clamp and slide clamp onto muffler.  
(note direction of clamp in Fig. 1)
- 5 Mount muffler clamp to stock muffler bracket using stock bolt, washer, and nut. (see Fig. 1)  
Torque bolt to 2.5 kg-m (18 lb-ft).
- 6 Check for proper clearance between new muffler and motorcycle. (i.e. swing-arm, passenger foot-peg, rear wheel, etc.) If any problem is found, please carefully follow through the installation steps again. If problem still persists, please call Yoshimura tech. Dept. at (800)634-9166 / in CA (909)628-4722

**Note:** After starting motorcycle, it is normal for new exhaust system to smoke until oil residue burns off.

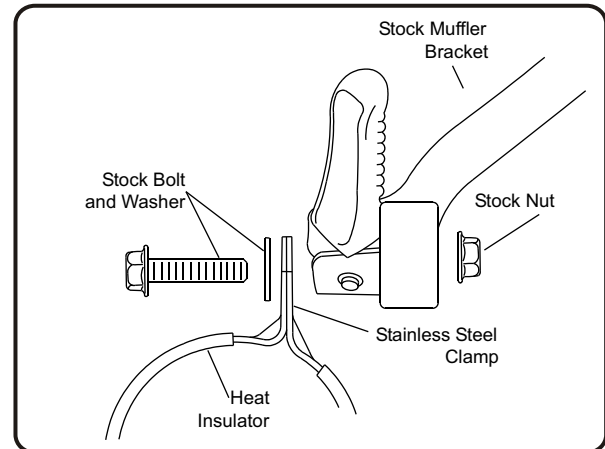

Fig.1