



# YOSHIMURA

RESEARCH&DEVELOPMENT OF AMERICA, INC.

5420 DANIELS STREET STE A, CHINO CA. 91786 · (800)634-9166 · (909)628-4722 · FACSIMILE (909)591-2198

[www.yoshimura-rd.com](http://www.yoshimura-rd.com)

## **ADJUSTABLE SPROCKET KIT SUXR 1301**

**2001-2012 SUZUKI GSX-R 1000  
1999-2012 SUZUKI GSX-R 750  
2001-2012 SUZUKI GSX-R 600**

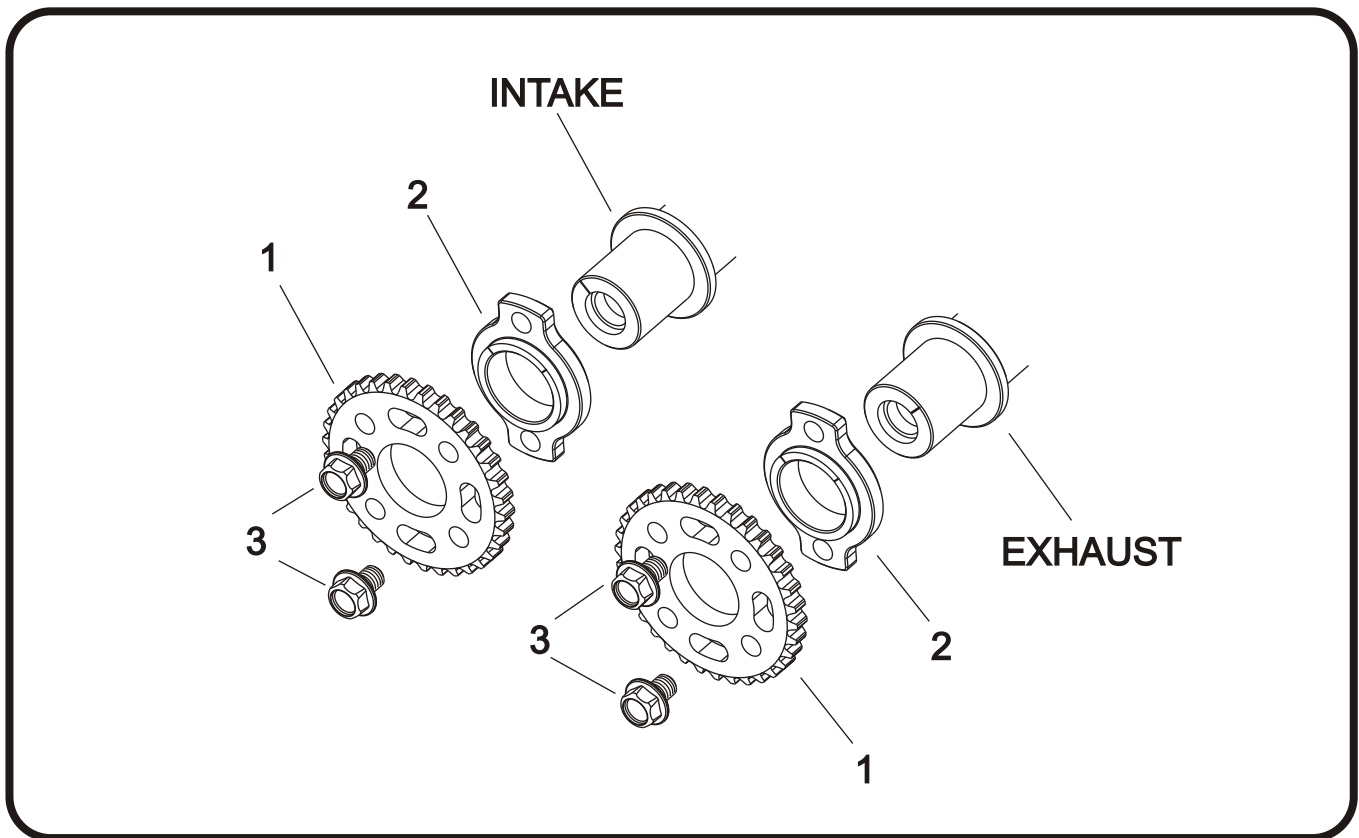

### **Part List:**

NO.	DESCRIPTION	QTY	PART #
1	Adjustable Cam Timing Sprocket	2	212-567-0010
2	Sprocket Adaptor	2	SUXR1130
3	7mm X 10 Flange Bolt	4	09103-07003
4	Adaptor Installation Tool	1	SUXR1130ST
**	Yoshimura Vinyl Sticker	2	17020C

NOTE: IN THE STATE OF CALIFORNIA, IT IS ILLEGAL TO MODIFY THE EMISSION CONTROL SYSTEM. WHICH INCLUDES THE CARBURETORS OF ANY VEHICLE.

**Caution:** Engine and exhaust system can be extremely hot. Let motorcycle cool down before beginning installation.

**Note:** Read through all instructions before beginning installation.

### **Installation Notes:**

- 1 Remove stock cam sprocket from camshaft. Support backside of stock sprocket when pressing sprocket off from camshaft.
- 2 Remove bolts and sprocket from sprocket adaptor before pressing onto camshaft.
- 3 Align sprocket adaptors with timing mark at end of camshafts. Press adaptors on camshafts with installation tool. It is important to completely press adaptors on until installation tool bottoms out on end of camshafts for proper sprocket alignment.

See Fig.1 for adaptor alignment with camshaft timing mark.

See Fig. 2 for installation tool placement.

- 4 After adjusting cam timing, apply thread lock to 7mm flange bolts and torque to 2.5 kg-m (18 lb-ft).

**⚠ Caution**

**Do not press adaptor on and off more than three times as severe engine damage could occur. Adaptor should be replaced after it has been removed the third time.**

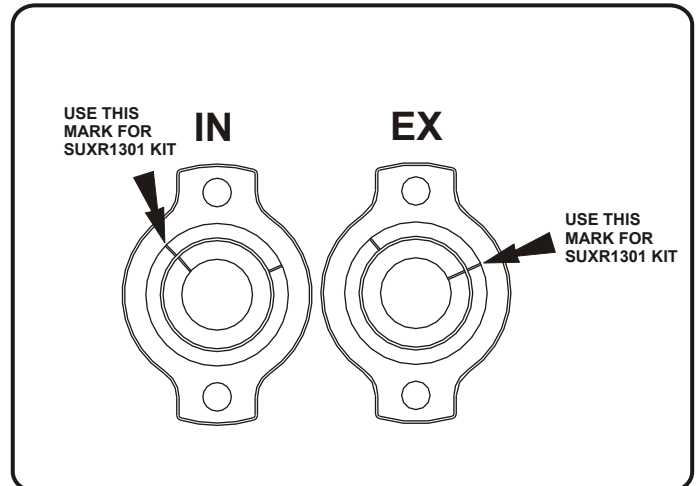

Fig. 1

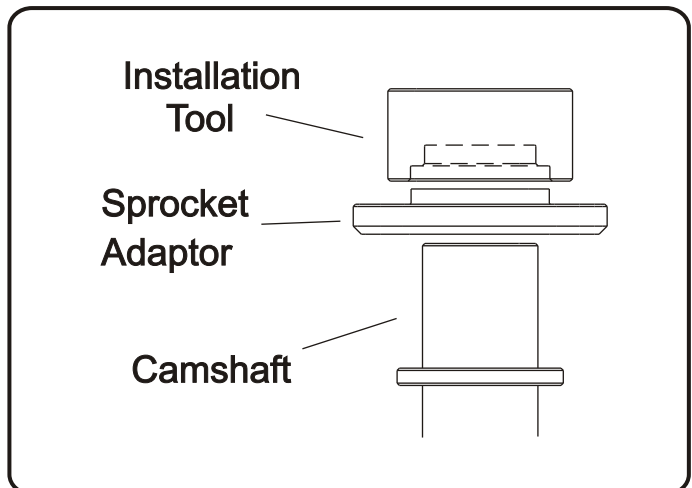

Fig. 2