



YOSHIMURA

RESEARCH&DEVELOPMENT OF AMERICA, INC.

5420 DANIELS STREET STE A, CHINO CA., 91786 · (800)634-9166 · (909)628-4722 · FACSIMILE (909)591-2198

www.yoshimura-rd.com

RS-3 OVAL PERFORMANCE EXHAUST SYSTEM

SUZUKI
'97-01
TL1000S

TL106RRS

STAINLESS STEEL RACE HIGH EXIT FULL SYSTEM

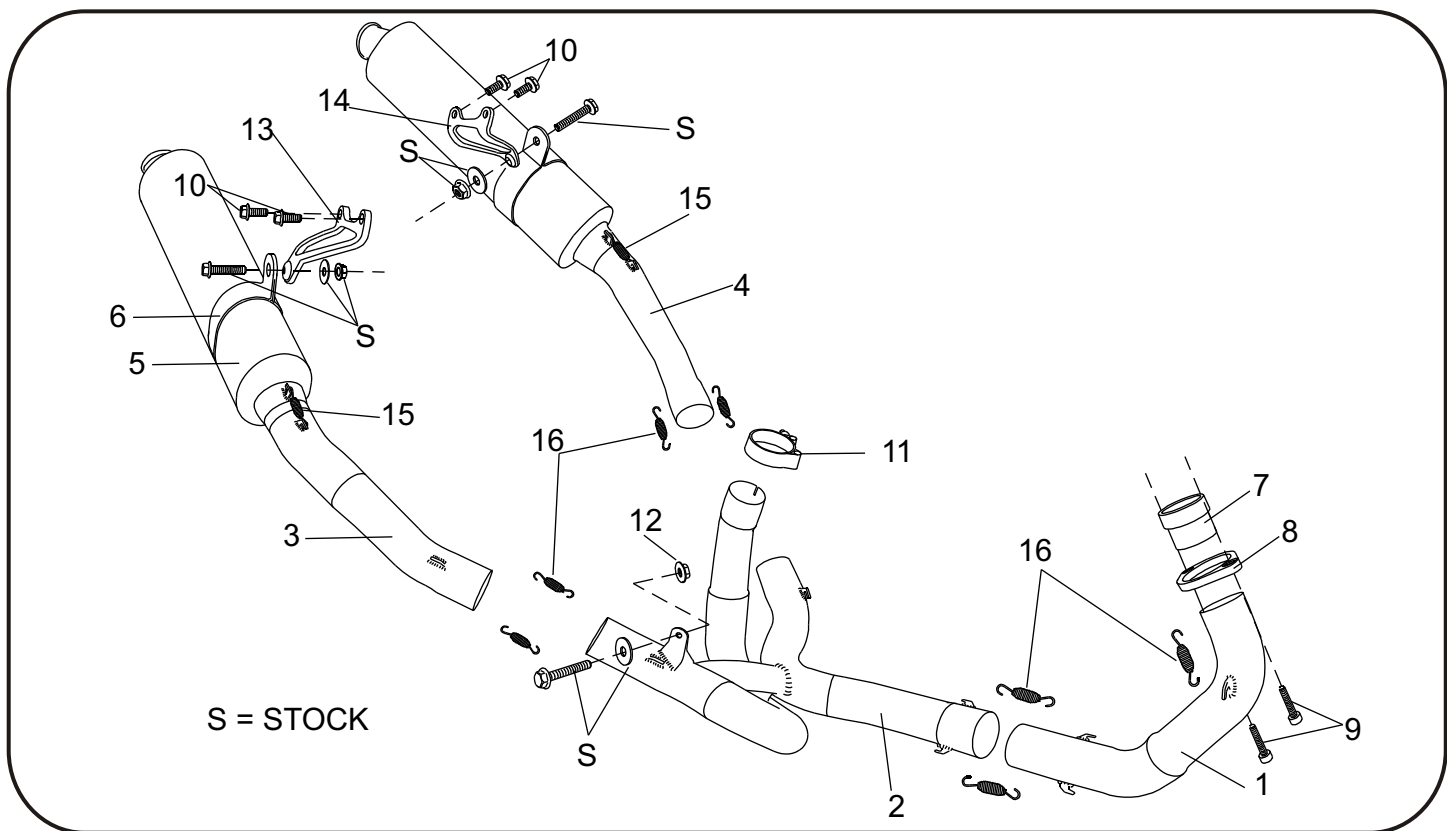

Parts Diagram

NO.	DESCRIPTION	QTY	PART #
1	Stainless Steel Header (Front)	1	TL106RRHF
2	Stainless Steel Header (Rear)	1	TL106RRHB
3	Stainless Steel Tailpipe (Right)	1	TL106RTR
4	Stainless Steel Tailpipe (Left)	1	TL106RTL
5	RS-3 Oval Muffer Assembly	2	**
6	Stainless Steel Muffer Clamp Stainless Steel or Titanium Sleeve uses Carbon Fiber Sleeve uses	2	COS450S8ASX COS450S8AS
7	Stainless Steel Manifold	1	TL107SDM
8	Steel Flange	1	TL116SDR
9	8mm Drilled Allen Bolt	2	8X25SP

NO.	DESCRIPTION	QTY	PART #
10	8 X 20mm Flange Head Bolt	4	M8X20H
11	2" Stainless Steel Exhaust Clamp	1	200-60
12	8mm Flange Nut	1	8MMNUT
13	Aluminum High Mount Bracket (Right)	1	TL107ABR
14	Aluminum High Mount Bracket (Left)	1	TL107ABL
15	2.3" Exhaust Spring	4	RACE-SPS
16	3" Exhaust Springs	8	RACE-SPL
**	Muffer Clamp Heat Insulator	2	HT SHLDTRS
**	Spring Puller Tool	1	ST-100
**	Yoshimura Vinyl Sticker	4	17028

NOTE: IN THE STATE OF CALIFORNIA, IT IS ILLEGAL TO MODIFY THE EMISSION CONTROL SYSTEM, WHICH INCLUDES THE CARBURETORS OF ANY VEHICLE.

Caution: Exhaust system can be extremely hot. Let motorcycle cool down before beginning installation.

Note: Read through all instructions before beginning installation.

Installation Steps:

- 1 Remove stock mufflers and stock exhaust system. (Unbolt exhaust flange on front cylinder, loosen exhaust clamp at rear cylinder and unbolt chassis mount bolts on both sides.)
- 2 Replace old exhaust port gasket with new exhaust port gasket. (not supplied - Suzuki part no. 14181-31D00)
- 3 Install Yoshimura manifold and flange to front cylinder exhaust port with supplied bolts. Torque bolt to 2.5 kg-m (18 lb-ft).
- 4 Slip exhaust clamp over Yoshimura rear header exhaust port tube.
- 5 Install rear header by slipping exhaust port tube into stock header tube. (Do not tighten exhaust clamp at this time.)
- 6 Install Yoshimura front header.
- 7 Install 3" exhaust springs on header. (Hook one end of the spring through drilled hole on header bolt and pull the other end with spring puller tool onto header's spring hook.)
- 8 Install 3" exhaust springs between front and rear header.
- 9 Install right side stock chassis mount bolt and washer. Torque bolt to 2.5 kg-m (18 lb-ft).
- 10 Tighten exhaust clamp to 1.25 kg-m (9 lb-ft).
- 11 Remove left and right passenger footpeg brackets.
- 12 Install left and right Yoshimura high mount muffler brackets using supplied bolts.
- 13 Install left and right tailpipes with mufflers onto header.
- 14 Apply heat insulator to inside of muffler clamps and slide clamps onto mufflers. (See Fig. 1)

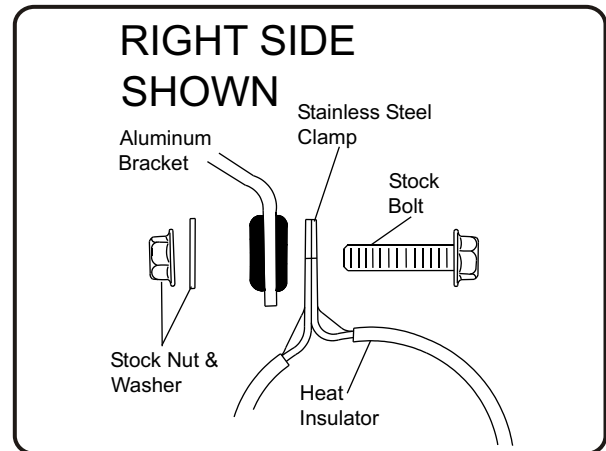

Fig. 5

- 15 Mount muffler clamps to supplied high mount muffler brackets using stock bolts, washers and nuts. (See Fig. 1) Torque bolts to 2.5 kg-m (18 lb-ft).
- 16 Install 3" exhaust springs between tail-pipes and header.
- 17 It is recommended that the entire exhaust system be wiped down with rubbing alcohol to remove oil and fingerprints. This will help prevent tarnishing of the finish after the exhaust is heated up.
- 18 Check for proper clearance between new exhaust system and motorcycle. (i.e. oil pan, swing-arm, etc.) If any problem is found, please carefully follow through the installation steps again. If problem still persists, please call Yoshimura tech. dept. at (800)634-9166 / in CA (909)628-4722
- 19 **NOTE:** If using aftermarket lower cowling check carefully for clearance between cowling and exhaust **BEFORE** running motorcycle.

Note: After starting motorcycle, it is normal for new exhaust system to smoke until oil residue burns off.