



YOSHIMURA

RESEARCH&DEVELOPMENT OF AMERICA, INC.

5420 DANIELS STREET SUITE A, CHINO, CA 91710 · (800)634-9166 · (909)628-4722 · FACSIMILE (909)591-2198

www.yoshimura-rd.com

TRC-INS-K | YOSHIMURA TRC AND R-22 INSERT KIT

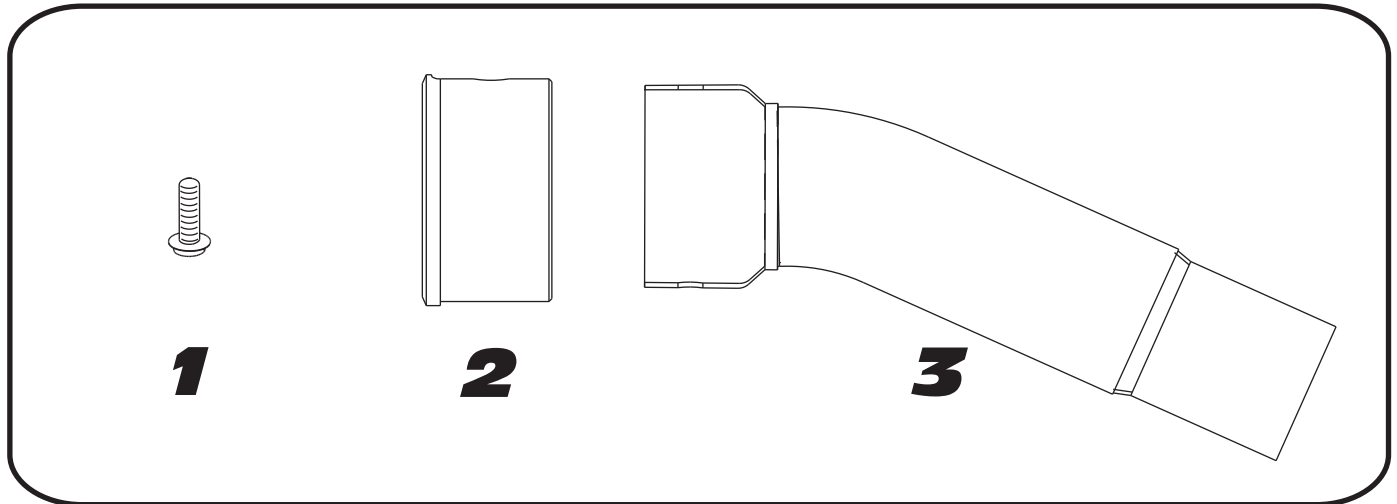

Parts Diagram

NO.	DESCRIPTION	QTY	PART #
1	6mmX12mm Button Head Cap Screw	1	M6X12BHS
2	Low Volume Insert Ring 1.5"	1	TRC-RING-1500
3	TRC Low Volume Insert	1	TRC-INS

Caution: Muffler can be extremely hot. Let muffler cool down before installing sound inserts.

Note: Read through all instructions before beginning disassembly.

Tools Needed:

4mm Allen Key

Installation Steps:

1. Place aluminum ring over insert. Make sure to align the hole on the insert with the hole on the ring.
2. Place insert inside the outlet of Yoshimura muffler.
3. Secure insert using supplied button head cap screw from the outside. Torque to 8 lb-ft.

NOTE: It is recommended that a low strength "Loc-tite" is used on the button head cap screw.