



YOSHIMURA

RESEARCH&DEVELOPMENT OF AMERICA, INC.

5420 DANIELS STREET SUITE A, CHINO, CA 91710 · (800)634-9166 · (909)628-4722 · FACSIMILE (909)591-2198

www.yoshimura-rd.com

TRS-INS-K

YOSHIMURA TRS INSERT KIT

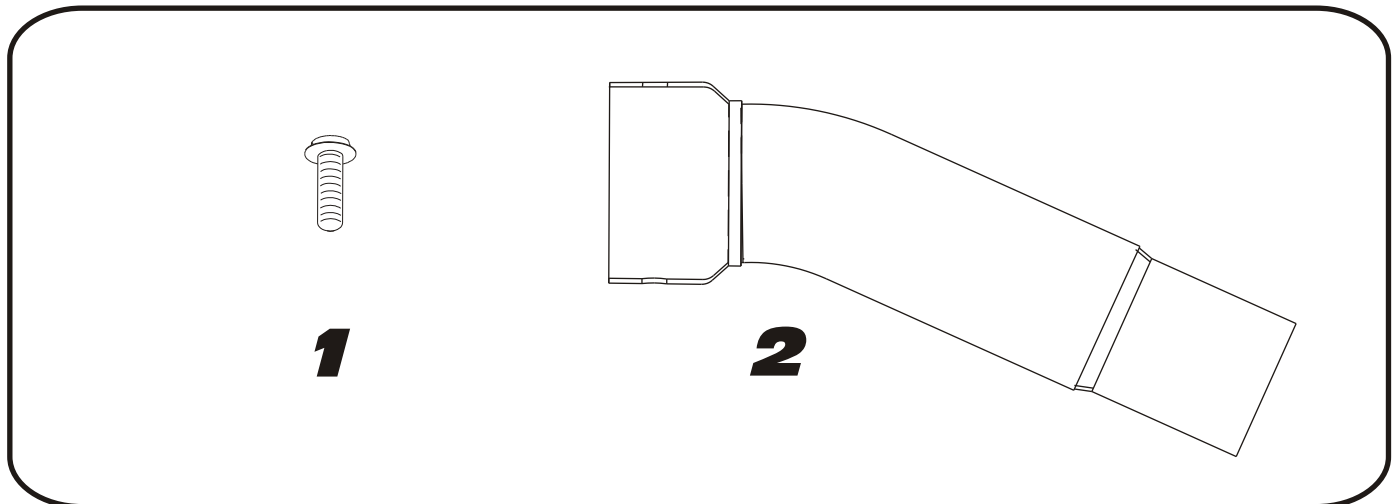

| NO. | DESCRIPTION | QTY | PART # |
|-----|-------------------------------|-----|---------|
| 1 | 6mmX6mm Button Head Cap Screw | 1 | M6X6BHS |
| 2 | TRS Low Volume Insert | 1 | TRS-INS |
| ** | Yoshimura Stickers | 2 | 17020C |

Parts Diagram

Caution: Muffler can be extremely hot. Let muffler cool down before installing sound inserts.

Note: Read through all instructions before beginning disassembly.

Tools Needed:

4mm Allen Key

Installation Steps:

1. Place insert inside the outlet of Yoshimura muffler.
2. Secure insert using supplied button head cap screw. Torque to 8 lb-ft.

NOTE: It is recommended that a low strength "Loc-tite" is used on the button head cap screw.