



YOSHIMURA

RESEARCH & DEVELOPMENT OF AMERICA, INC.

5420 DANIELS STREET STE A, CHINO CA. 91786 · (800)634-9166 · (909)628-4722 · FACSIMILE (909)591-2198

www.yoshimura-rd.com

TRI-OVAL PERFORMANCE EXHAUST SYSTEM

KAWASAKI
2000-05
ZX-12R

ZX126RRD-TRI

STAINLESS STEEL RACE ONLY DUPLEX SYSTEM

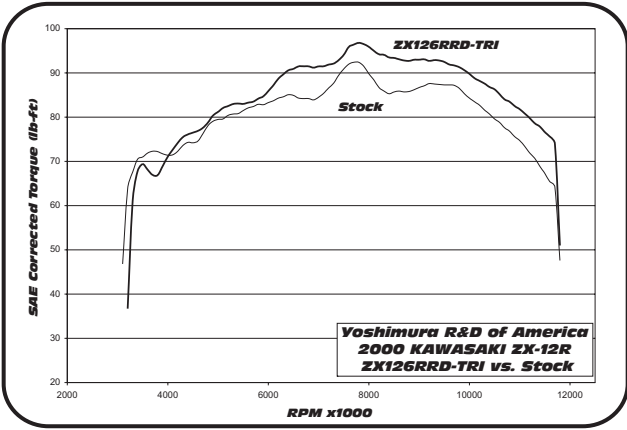
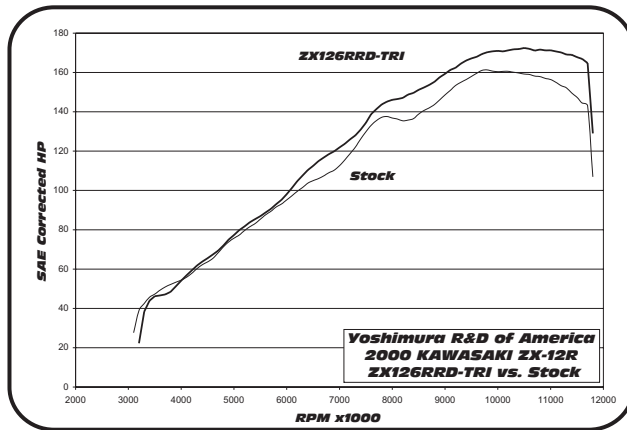

Note: Dyno graphs are for comparison use only. Actual results may vary depending on operating and motorcycle condition.



NOTE: IN THE STATE OF CALIFORNIA, IT IS ILLEGAL TO MODIFY THE EMISSION CONTROL SYSTEM, WHICH INCLUDES THE CARBURETORS OF ANY VEHICLE.

Caution: Exhaust system can be extremely hot. Let motorcycle cool down before beginning installation.

Note: Read through all instructions before beginning installation.

Tools Needed:

10mm, 12mm and 14mm sockets
3/8" ratchet and extension
14mm wrench
4mm Allen wrench
Philip screwdriver
Torque wrench

Installation Steps:

- 1 Remove left, right and cowling.
(See Fig.1 for fastener locations)
- 2 Remove radiator mount bracket and tilt radiator forward slightly. (see Fig. 2)
- 3 Remove stock exhaust system and exhaust port gaskets.
- 4 Install new exhaust port gaskets on Yoshimura Header.
(not supplied - Kawasaki part no. 11009-1908)
- 5 Install Yoshimura header using stock header nuts.
Torque header nuts to 1.4kg-m (10.2 lb-ft).

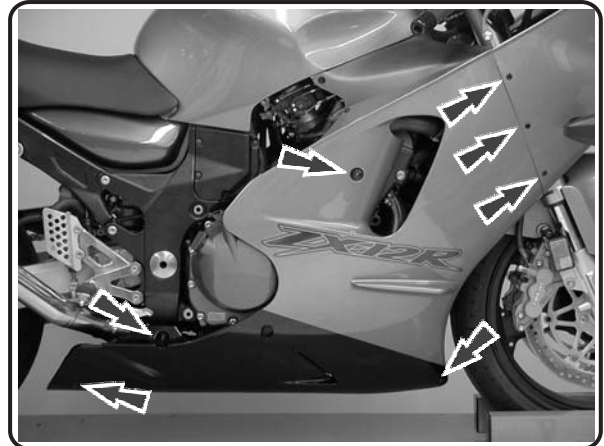
**Fig. 1****Fig. 2**

- 6 *Install Yoshimura tailpipe with muffler onto header and attach springs from tailpipe to collector.*
- 7 *Slide clamp onto muffler.
(Note direction of clamp in Fig. 3)*
- 8 *Mount clamp to outside of stock muffler bracket using stock bolt with stock washer and nut. Torque bolt to 2.5 kg-m (18 lb-ft).*
- 9 *It is recommended that the entire exhaust system be wiped down with rubbing alcohol to remove oil and fingerprints. This will help prevent tarnishing of the finish after the exhaust is heated up.*
- 10 *Re-install radiator bracket..*
- 11 *Before starting motorcycle, check for proper clearance between new exhaust system and motorcycle. (i.e. radiator, oil pan, swing-arm, etc.) If any problem is found, please carefully follow through the installation steps again. If problem still persists, please call Yoshimura tech. dept. at (800)634-9166 / in CA (909)628-4722*
- 12 *Re-install cowlings.*
- 13 *Check for proper clearance between new exhaust system and cowling.*

NOTE: *After starting motorcycle, it is normal for new exhaust system and muffler to emit smoke until oil residue burns off.*

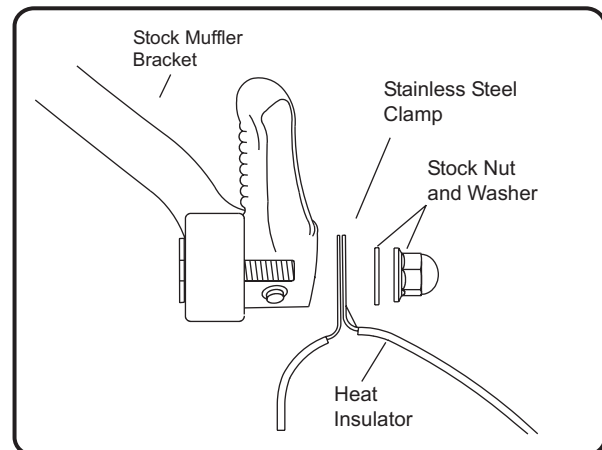
**Fig. 3****Fig. 4**

#ZX126RRD-TRI

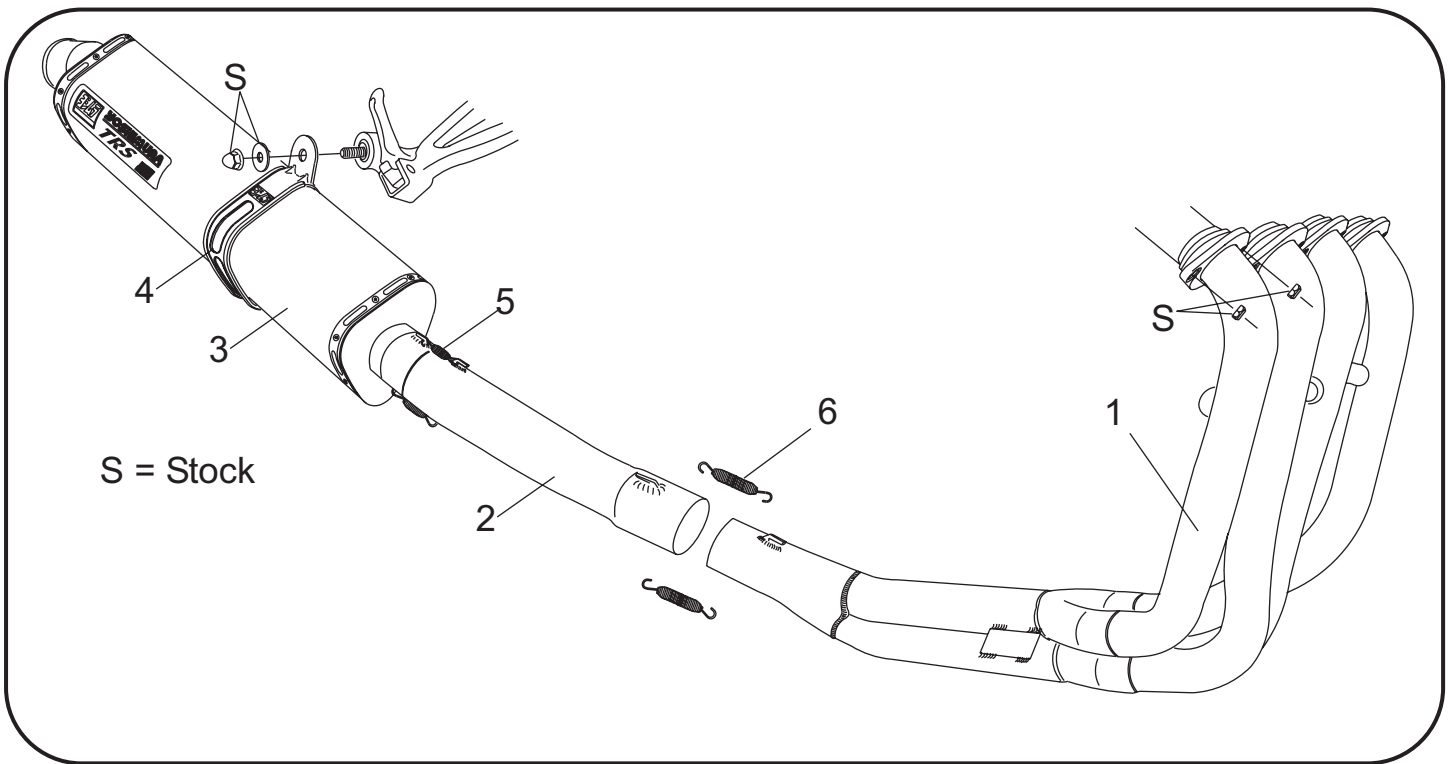

Parts Diagram

NO.	DESCRIPTION	QTY	PART #
1	Yoshimura Header Stainless Steel Race Only Duplex	1	ZX126RRHD
2	Yoshimura Tailpipe Stainless Steel Race Only	1	ZX126RT
3	Tri-Oval Muffler Assembly	1	**
4	Stainless Tri-Oval Muffler Clamp Titanium Sleeve use Carbon Fiber Sleeve use	1	CTS101X CTS101
5	Stainless Steel Spring 2.5"	2	RACE-SPS
6	Stainless Steel Spring 3.5"	2	RACE-SPL
**	Muffler Clamp Heat Insulator	1	HT SHLDTRS
**	Spring Puller Tool	1	ST-100
**	Duplex Sticker	2	DLABEL
**	Yoshimura Vinyl Sticker	2	17028-BLK