



YOSHIMURA

RESEARCH & DEVELOPMENT OF AMERICA, INC.

5420 DANIELS STREET STE A, CHINO CA. 91786 · (800)634-9166 · (909)628-4722 · FACSIMILE (909)591-2198

www.yoshimura-rd.com

RS-3 PERFORMANCE EXHAUST SYSTEM

KAWASAKI
2000-05
ZX-12R

ZX12950

RACE ONLY 5" OVAL SS BOLT-ON SYSTEM

ZX12950

RACE ONLY 5" OVAL Ti BOLT-ON SYSTEM

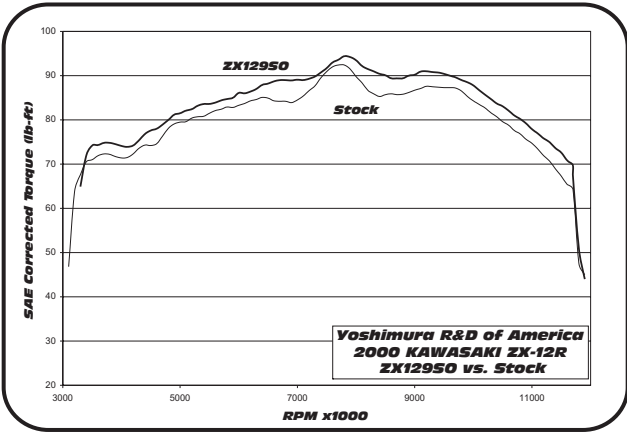
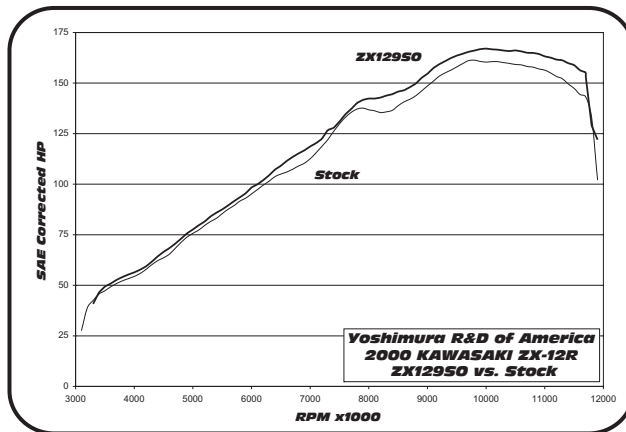

Note: Dyno graphs are for comparison use only. Actual results may vary depending on operating and motorcycle condition.



THIS PRODUCT IS DESIGNED FOR USE IN CLOSED COURSE RACING AND IS NOT INTENDED FOR HIGHWAY USE.



NOTE: IN THE STATE OF CALIFORNIA, IT IS ILLEGAL TO MODIFY THE EMISSION CONTROL SYSTEM. WHICH INCLUDES THE CARBURETORS OF ANY VEHICLE.

Caution: Exhaust system can be extremely hot. Let motorcycle cool down before beginning installation.

Note: Read through all instructions before beginning installation.

Tools Needed:

12mm socket
3/8" ratchet and extension
12mm and 14mm wrench
6mm Allen wrench
Torque wrench

Installation Steps:

- 1 Remove stock muffler assembly. (See Fig.1 &2)
- 2 Install new muffler gasket. (Not supplied)
- 3 Install Yoshimura muffler using supplied bolts. Torque bolts to 2.3 kg-m (16.5 lb-ft).
- 4 Apply heat insulator to inside of muffler clamp and slide clamp onto muffler. (Note direction of clamp in Fig. 4)
- 5 Mount clamp to stock muffler bracket using stock bolt and washer. (See Fig. 3&4) Torque bolt to 2.5 kg-m (18 lb-ft)
- 6 Reinstall stock muffler front cover using stock bolts (See Fig 5).
- 6 Before starting the motorcycle, check for proper clearance between new muffler and motorcycle. (i.e. swing-arm, passenger foot-peg, rear wheel, etc.) If any problem is found, please carefully follow through the installation steps again. If problem still persists, please call Yoshimura tech. Dept. at (800)634-9166 / in CA (909)628-4722

NOTE: After starting motorcycle, it is normal for new muffler to emit smoke until oil residue burns off.



Fig. 1

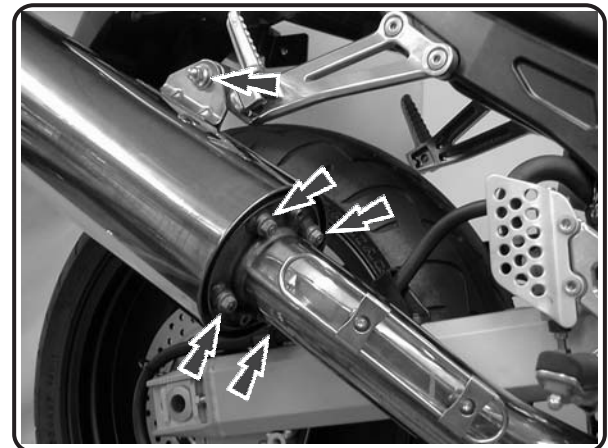

Fig. 2

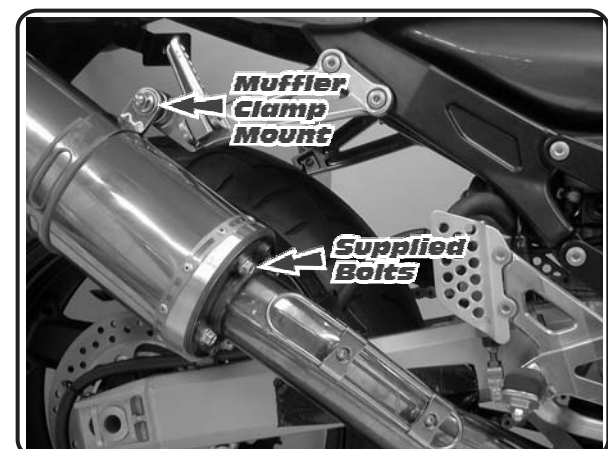

Fig. 3

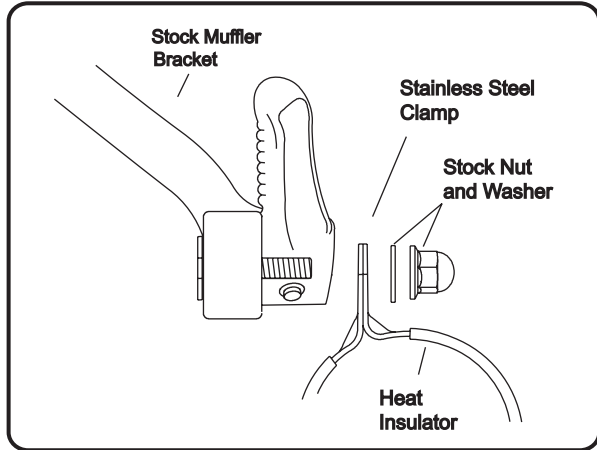
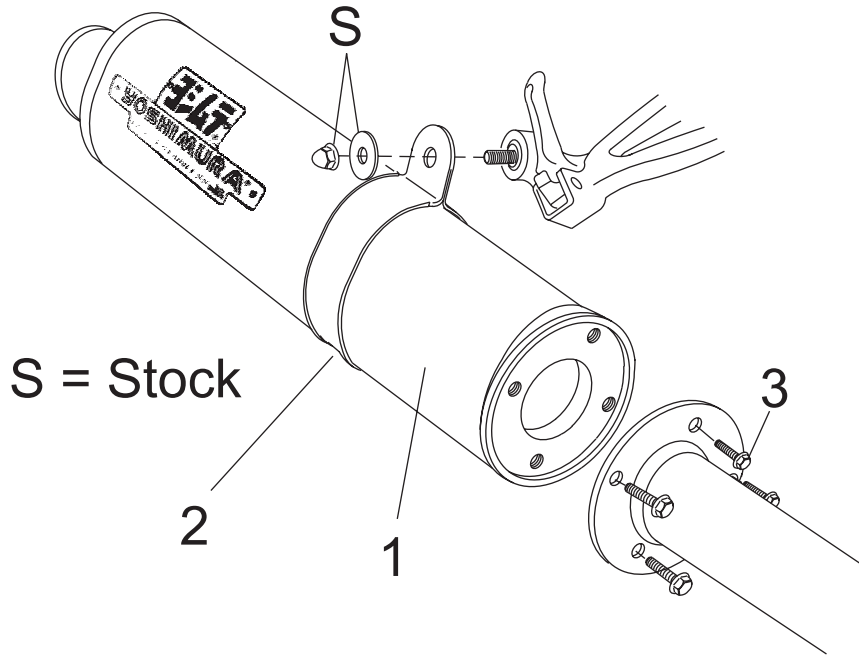

Fig. 4



Fig. 5

#ZX129SO/ZX129SO-TI



Parts Diagram

NO.	DESCRIPTION	QTY	PART #
1	RS-3 5" Race Muffler Assembly	1	**
2	Stainless Steel Muffler Clamp	1	CO500S10ALX
3	8mm X 25mm Flange Head Bolt	4	M8X25H
**	Muffler Clamp Heat Insulator	1	HT SHLD5
**	Yoshimura Vinyl Sticker	2	17028-BLK

Nuts and Bolts Guide (Actual Size):

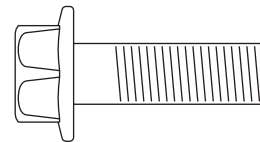

8mm x 25mm
Flange Hex Bolt