



YOSHIMURA

RESEARCH&DEVELOPMENT OF AMERICA, INC.

5420 DANIELS STREET STE A, CHINO CA., 91710 · (800) 634-9166 · (909) 628-4722 · FAX (909) 591-2198

www.yoshimura-rd.com

FENDER ELIMINATOR KIT

070BG149500
Kawasaki Z900RS

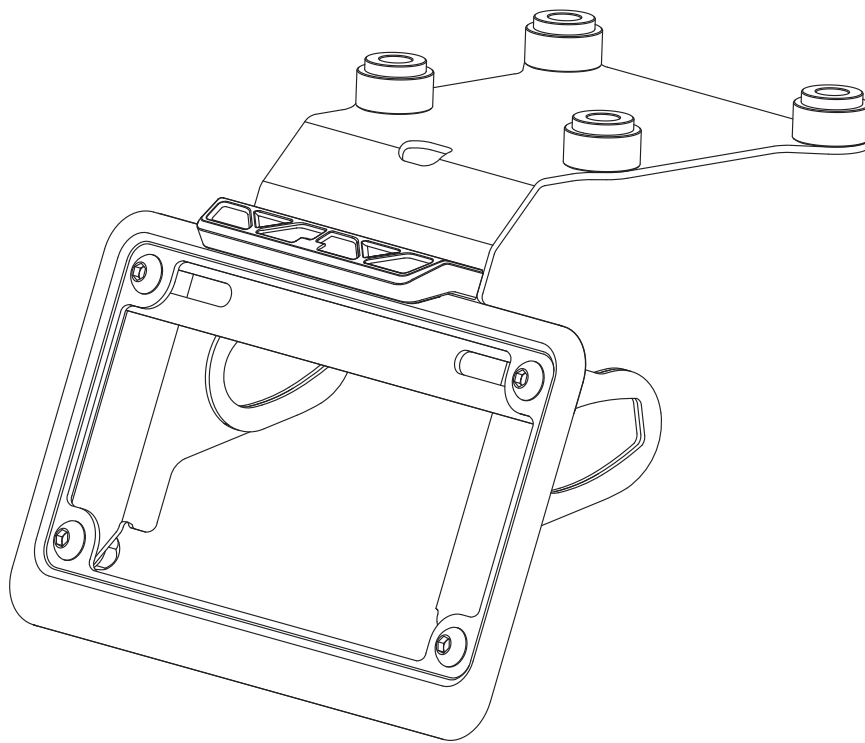

THIS PRODUCT IS NOT DOT APPROVED.

Yoshimura R&D of America, Inc. is not liable or responsible for any resulting event caused by the installation of this product. Check with local laws and regulations for compliance prior to installation and use. This product is not intended for use on public highways.



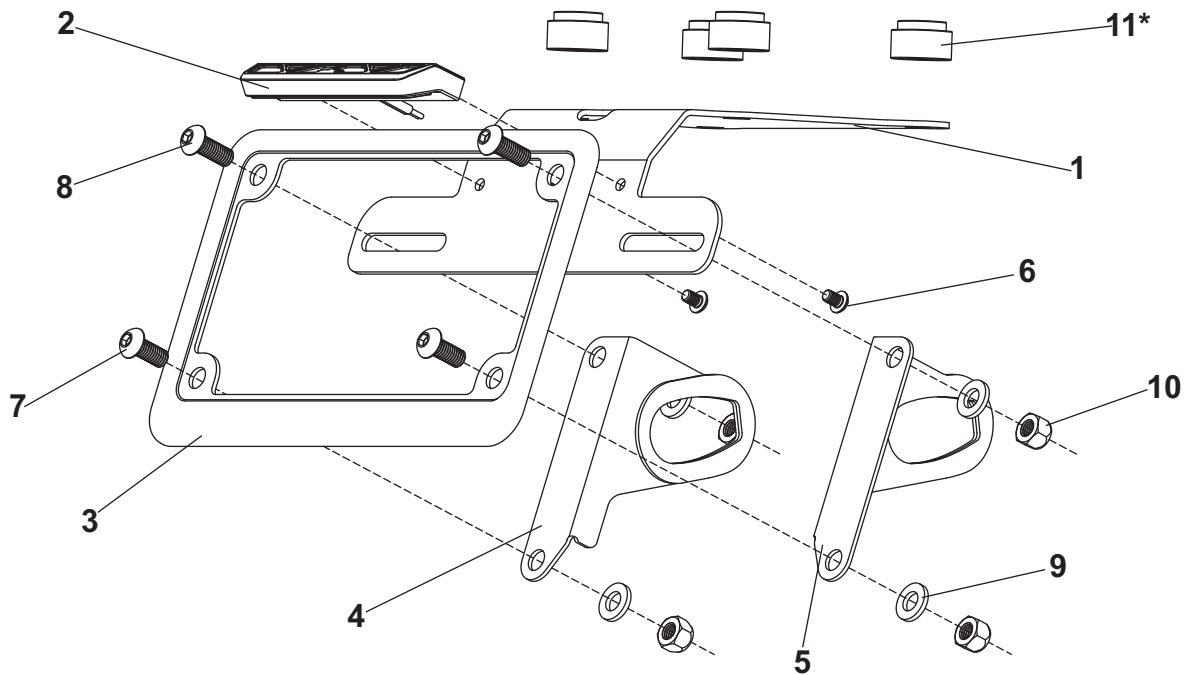

No.	Item	Description	Qty.
1	14950-FEBKT	Fender Eliminator Bracket	1
2	070BG-LH-K1	LED License Plate Light	1
3	070BG-LPF	License Plate Frame	1
4	14200-TSL	Left Turn Signal Bracket	1
5	14200-TSR	Right Turn Signal Bracket	1
6	M4X6BHS	4mm X 6mm Button Head Screw	2
7	M6X14BHS	6mm X 14mm Button Head Screw	2
8	M6X16BHS	6mm X 16mm Button Head Screw	2
9	6MMWASHER	6mm Washer	4
10	6MMLN	6mm Nylon Lock Nut	4
11*	14950-FESPCR	Fender Eliminator Spacer	4
**	17029	Yoshimura Sticker Kit	1
**	BN-SSS-22-18	Butt Connectors	2
Optional Accessories			
	072BGLTSFK	Yoshimura LED Front Turn Signal Kit	
	072BGLTSR	Yoshimura LED Rear Turn Signal Kit w/ Relay	
	070BGUNVTBKT	Yoshimura Universal Turn Signal Bracket	

* Fender eliminator spacer is to be used if side reflector bracket is not installed.

** Not shown on diagram.

*** The Yoshimura Universal Turn Signal Bracket Kit is to be used with aftermarket stud-mounted turn signals and is sold separately.

Removal

1. Remove rider seat.
2. Remove the rear tail cover.
3. Locate and disconnect the license plate light and turn signal connectors.
4. While securely supporting the stock fender assembly, remove the four bolts securing the fender assembly to the frame. Carefully remove the stock fender assembly making sure not to damage the connectors in the process.

Note: The lower "U" shape fender bracket will be re-used when installing the Yoshimura fender eliminator.

5. Disassemble the stock fender assembly and remove the left and right turn signals.

Note¹: The stock turn signal hardware will be re-used when re-installing onto Yoshimura turn signal brackets.

Note²: The stock tail light / upper fender shroud will not be re-used.

6. Cut the stock license plate light connector from the stock fender assembly. Be sure to cut at least a 6" section of wire from the connector.

Installation

1. Install (No. 2) 070BG-LH-K1, Yoshimura license plate light onto (No. 1) 14950-FEBKT, Yoshimura fender eliminator bracket using (No. 6) M4X6BHS, 4mm button head screws provided in the kit.

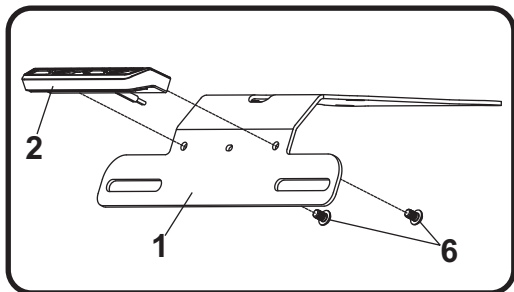

2. Using the stock hardware, install left and right turn signals onto (No. 4,5) 14200-TSL/R, left and right turn signal brackets.
3. Assemble and install (No. 3) 070BG-LPF, license plate frame and (No. 4,5) 14200-TSL/R, turn signal brackets to (No. 1) 14950-FEBKT, fender eliminator bracket using the hardware supplied in the kit as shown.

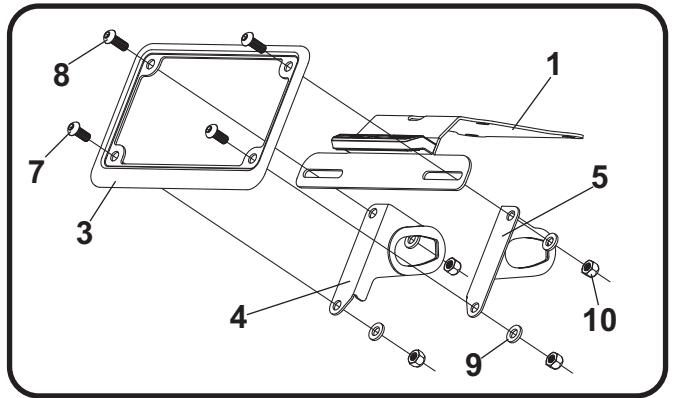

4. Route license plate light and turn signal wires through the hole in bracket and under the seat. Secure assembled fender eliminator kit to frame using the stock fender bolts and the stock lower "U" shape fender bracket. Torque to factory specification.

Note¹: If the side reflector bracket plate is to be re-used, the (No. 11) 14950-FESPCR, fender eliminator spacer is not required.

Note²: If the side reflector bracket will not be used, install (No. 11) 14950-FESPCR, fender eliminator spacer between the frame and (No. 1) 14950-FEBKT, fender bracket as shown.

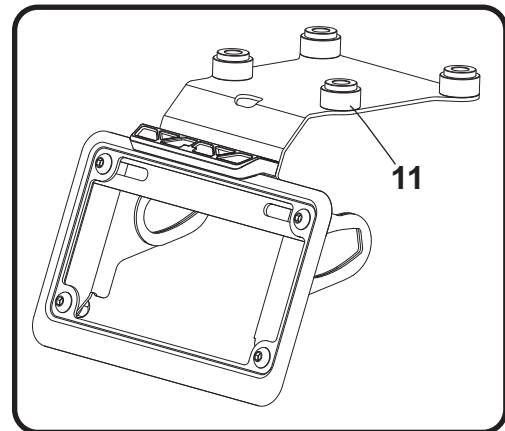

5. Because both of the stock license plate light wires are black, determine the positive and negative wires by re-connecting the license plate light connector. Using the BN-SSS-22-18 butt connectors provided in the kit, connect the Yoshimura license plate light wires to the stock license plate light wires as follows:

Brown/Yellow -to- Red
Black/Yellow -to- Black

- a) Strip the stock fender light wire ends 1/4" - 1/2" and insert into *BN-SSS-22-18*, butt connectors provided in the kit.
- b) Center the spliced wire ends in the middle and using a heatgun or lighter, apply heat evenly on the outer edges of the butt connector to shrink and hold wires in place.
- c) Making sure that the stripped ends are centered, heat the center of the butt connector evenly until the solder begins to liquify.
- d) Allow to cool completely and tug both ends of the wires to verify that connection is secured.

Scan for link to butt connector instruction video.



6. Re-connect license plate light and turn signal connectors.
7. Re-install the rear tail cover and re-install rider seat.
8. Check for proper function of license plate light, turn signals, brake light, and that all brackets and components are secure prior to riding.