



# YOSHIMURA

RESEARCH&DEVELOPMENT OF AMERICA, INC.

5420 DANIELS STREET STE A, CHINO CA., 91710 · (800) 634-9166 · (909) 628-4722 · FAX (909) 591-2198

[www.yoshimura-rd.com](http://www.yoshimura-rd.com)

## FRONT TURN SIGNAL ADAPTER PLATES

### **Honda Grom 073BG121220**

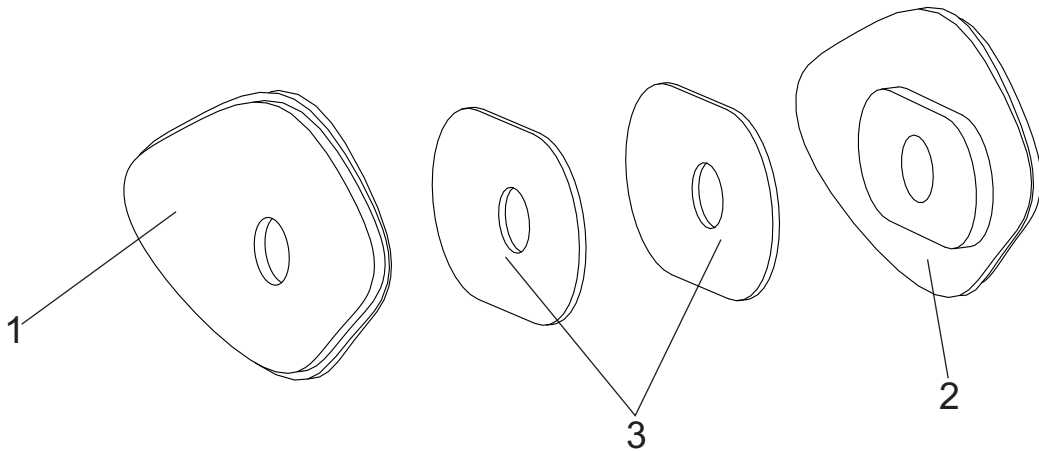

No.	Item	Description	Qty.
1	073BG121220	Right Front Turn Signal Plate	1
2	073BG121220	Left Front Turn Signal Plate	1
3	073HA121210-B	Turn Signal Backing Plate	2
<b>Optional Accessories</b>			
	072BGLTSFK	Yoshimura LED Front Turn Signal Kit w/ Relay	
	072BGLTSFK-S	Yoshimura Sequential LED Front Turn Signal Kit	
	073BG-HON-2	Yoshimura Plug-and-Play Turn Signal Wire Adapter	

**IMPORTANT:** Installation of this product requires the use of aftermarket M8 mounted turn signals.  
Not compatible with stock turn signals.

## Removal

1. Remove the four bolts securing headlight assembly to frame and carefully pull out headlight assembly.
2. Locate and disconnect left and right turn signal connectors.
3. Remove meter cover by unscrewing the two bolts on the underside and gently pull down. Locate and unscrew the cap nut holding the turn signal in place.
4. Disassemble and remove left and right turn signals from turn signal holder.

### Left Turn Signal Plate

Front of Bike

Rear of Bike

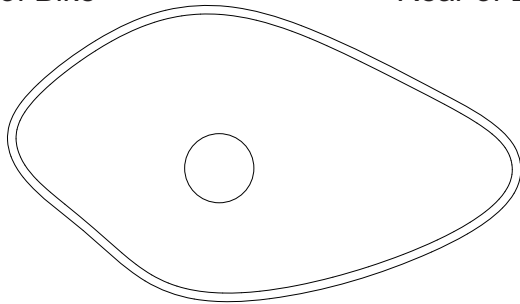

### Right Turn Signal Plate

Rear of Bike

Front of Bike

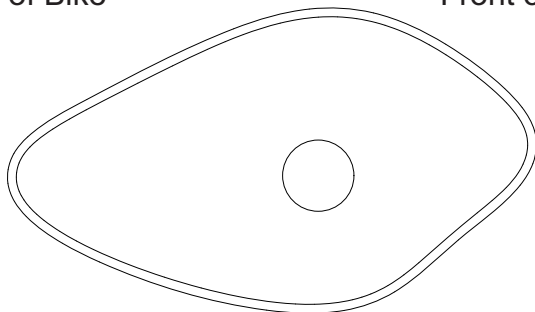

## Installation

1. Install aftermarket turn signal and front turn signal plate (073BG121220) onto front side of turn signal bracket. Install (No. 3) 073HA121210-B, turn signal backing plate on backside of turn signal holder and secure using turn signal nut.



2. Repeat steps for opposite side.
3. Re-install the meter cover by lining up the cover with the back of the meter. Make sure cover is resting on the front side of 073BG121220 to ensure best fit. Re-install back cover on meter display using opposite steps of removal.



4. Re-connect turn signal connectors and re-install headlight assembly using the four stock bolts.
5. Check for proper function of headlight, turn signals, and that all components are secure prior to riding.





5420 DANIELS STREET STE A, CHINO CALIF. 91710 - (800) 634-9166 - (909) 628-4722 - FAX (909) 591-2198

**[www.yoshimura-rd.com](http://www.yoshimura-rd.com)**

1. Remove the stock turn signals.
2. Cut the stock turn signal wires on the harness side 2" behind the stock connector.
3. Strip wire ends  $\frac{1}{4}$ " –  $\frac{1}{2}$ " and determine positive (+) and negative (-) wires by temporarily connecting to Yoshimura turn signal.
4. Crimp the loose bullet connectors to harness wires accordingly.
5. Re-install and re-connect turn signal and check for proper function.

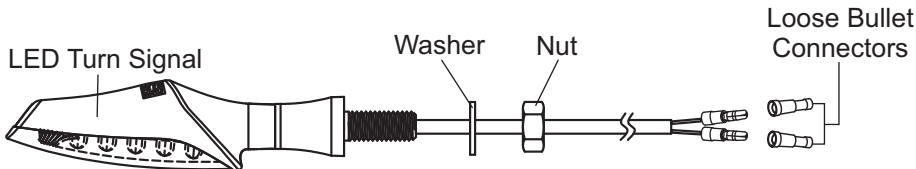



# YOSHIMURA

RESEARCH&DEVELOPMENT OF AMERICA, INC.

5420 DANIELS STREET STE A, CHINO CALIF. 91710 · (800)634-9166 · (909)628-4722 · FACSIMILE (909)591-2198

[www.yoshimura-rd.com](http://www.yoshimura-rd.com)

## ***Universal Turn Signal Bracket Kit***

### ***070BGUNVTBKT***

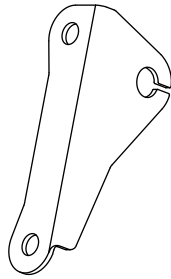
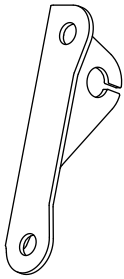

#### **Up & Out**

Turn signal mounted high and wide.

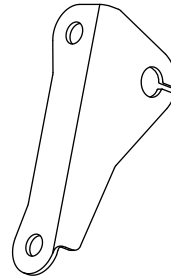

#### **Up & In**

Turn signal mounted high and narrow.

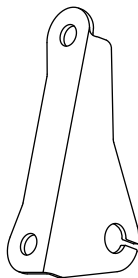
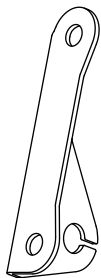

#### **Down & Out**

Turn signal mounted low and wide.

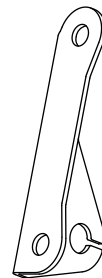
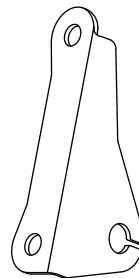

#### **Down & In**

Turn signal mounted low and narrow.

The Yoshimura Universal Turn Signal Brackets are to be used with aftermarket turn signals and can be installed using four different configurations. To prevent damage to turn signals, verify that the exhaust gases are not directed toward the turn signals. Yoshimura R&D of America, Inc. is not liable or responsible for any resulting event caused by the installation of this product. Check with local laws and regulations for compliance prior to installation and use.