



# YOSHIMURA

RESEARCH&DEVELOPMENT OF AMERICA, INC.

5420 DANIELS STREET STE A, CHINO CALIF. 91710 · (800) 634-9166 · (909) 628-4722 · FAX (909) 591-2198

[www.yoshimura-rd.com](http://www.yoshimura-rd.com)

## ***Universal Turn Signal Bracket Kit***

### ***070BGUNVTBKT***

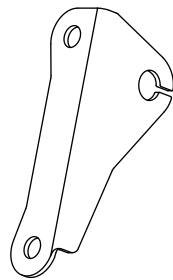
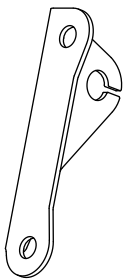

#### **Up & Out**

Turn signal mounted high and wide.

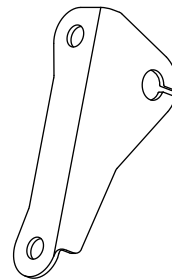

#### **Up & In**

Turn signal mounted high and narrow.

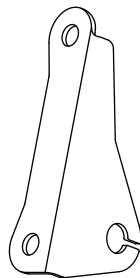
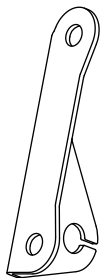

#### **Down & Out**

Turn signal mounted low and wide.

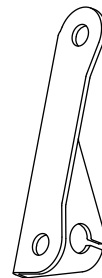
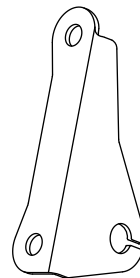

#### **Down & In**

Turn signal mounted low and narrow.

The Yoshimura Universal Turn Signal Brackets are to be used with aftermarket turn signals and can be installed using four different configurations. To prevent damage to turn signals, verify that the exhaust gases are not directed toward the turn signals. Yoshimura R&D of America, Inc. is not liable or responsible for any resulting event caused by the installation of this product. Check with local laws and regulations for compliance prior to installation and use.



RESEARCH&DEVELOPMENT OF AMERICA, INC.

5420 DANIELS STREET STEA, CHINO CALIF. 91710 (800) 634-9166 (909) 628-4722 FAX (909) 591-2188

[www.yoshimura-rd.com](http://www.yoshimura-rd.com)

### Butt Connector Installation:

1. Strip wire ends 1/4" - 1/2" and insert into BN-SSS-22-18, butt connectors.
2. Center the spliced wire ends in the middle and using a heatgun or lighter, apply heat evenly on the outer edges of the butt connector to shrink and hold wires in place.
3. Making sure that the stripped ends are centered, heat the center of the butt connector evenly until the solder begins to liquify.
4. Allow to cool completely and tug both ends of the wires to verify that connection is secured.  
Scan for link to butt connector instruction video.



RESEARCH&DEVELOPMENT OF AMERICA, INC.

5420 DANIELS STREET STEA, CHINO CALIF. 91710 (800) 634-9166 (909) 628-4722 FAX (909) 591-2188

[www.yoshimura-rd.com](http://www.yoshimura-rd.com)

1. Remove the stock turn signals.
2. Cut the stock turn signal wires on the harness side 2" behind the stock connector.
3. Strip wire ends 1/4" - 1/2" and determine positive (+) and negative (-) wires by temporarily connecting to Yoshimura turn signal.
4. Crimp the loose bullet connectors to harness wires accordingly.
5. Re-install and re-connect turn signal and check for proper function.

