



YOSHIMURA

RESEARCH&DEVELOPMENT OF AMERICA,

5420 DANIELS STREET STE A, CHINO CA., 91710 · (800) 634-9166 · (909) 628-4722 · FAX (909) 591-2198

www.yoshimura-rd.com

TURN SIGNAL ADAPTER PLATES

Suzuki GSX-8S 073BG117200

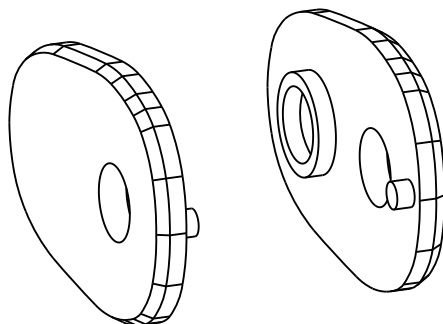

No.	Item	Description	Qty.
1	073BG117200-B	Front Turn Signal Plate	2
<i>Optional Recommended Accessories</i>			
	072BGLTSFK	Yoshimura LED Front Turn Signal Kit	
	072BGLTSFK-S	Yoshimura Sequential LED Front Turn Signal Kit	
	072BGLTSR	Yoshimura LED Turn Signal Kit w/ Relay	
	072BGLTSR-S	Yoshimura Sequential LED Turn Signal Kit w/ Relay	
	073BG-KTM	Yoshimura Plug-and-Play Turn Signal Wire Adapter	

IMPORTANT: Installation of this product requires the use of aftermarket M8 mounted turn signals.
Not compatible with stock turn signals.

Removal

1. Locate and disconnect both the turn signals and running lights located on the headlight cowl.
2. Remove headlight cowl. (2 black screws, 2 silver screws, 2 push pins, 2 flat push pins.)

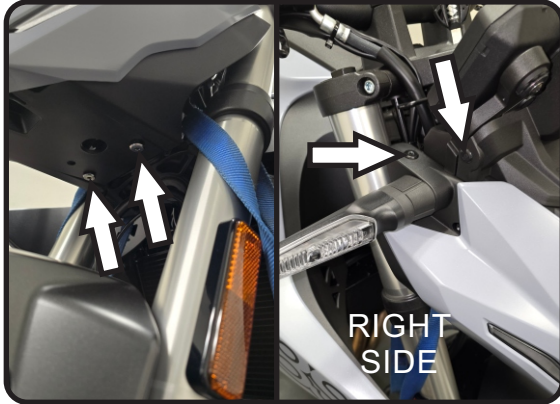

3. Remove turn signals from headlight cowl.

Installation

1. Install *073BG117200-B*, turn signal plate onto turn signal holder and secure using turn signal washer and nut.

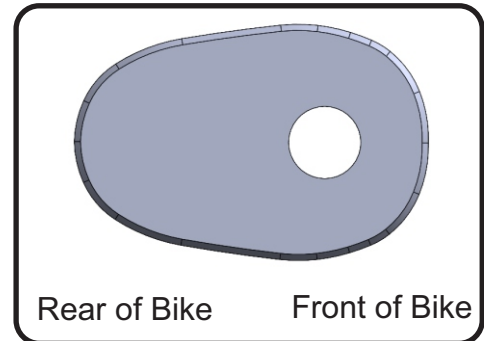

RIGHT SIDE EXAMPLE SHOWN

2. Repeat steps for the opposite side.
3. Reinstall the headlight cowl using reverse steps of removal.

Note: 073BG-KTM turn signal adapter wires are available for purchase separately for direct plug-and-play alternative with Yoshimura LED turn signals.

4. Check for proper function of turn signals and that all components are secure prior to riding. Adjust turn signal rotation as needed and tighten turn signal nut.