



YOSHIMURA

RESEARCH&DEVELOPMENT OF AMERICA, INC.

5420 DANIELS STREET STE A, CHINO CA., 91710 · (800) 634-9166 · (909) 628-4722 · FAX (909) 591-2198

www.yoshimura-rd.com

TURN SIGNAL ADAPTER PLATES

2021 Honda Trail 125 073BG121601

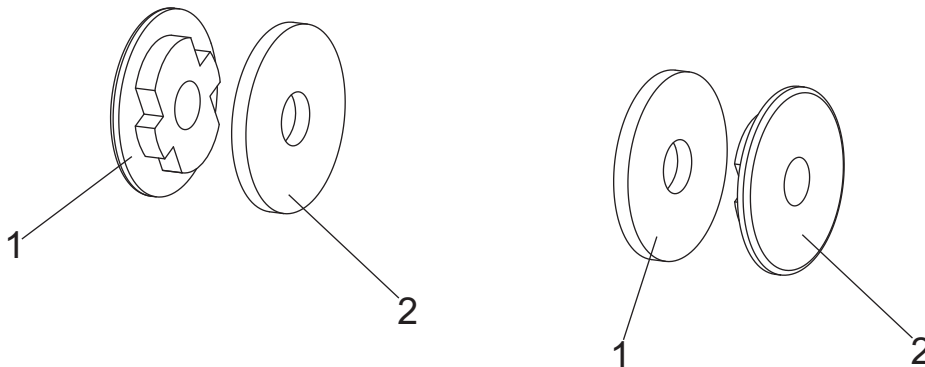

No.	Item	Description	Qty.
1	073BG121601	Turn Signal Adapter Plate	2
2	8MMWASHERXL	8mm Washer, XL	2
Optional Accessories			
	072BGLTSFK	Yoshimura LED Turn Signal Kit	
	072BGLTSFK-S	Yoshimura Sequential LED Turn Signal Kit	
	072BGLTSR	Yoshimura LED Turn Signal Kit w/ Relay	
	072BGLTSR-S	Yoshimura Sequential LED Turn Signal Kit w/ Relay	
	073BG-HON	Yoshimura Plug-and-Play Turn Signal Wire Adapter	
	KK000106	Diode Kit	

** Not shown on diagram.

IMPORTANT: Installation of this product requires the use of aftermarket M8 mounted turn signals.
Not compatible with stock turn signals.

Removal

1. Remove the upper taillight cover screw and carefully remove the taillight cover by gently lifting and unclipping the corners.
2. Locate and disconnect left and right turn signal connectors.
3. Remove the plastic push rivet securing turn signal and carefully remove turn signal from the lower taillight cover.

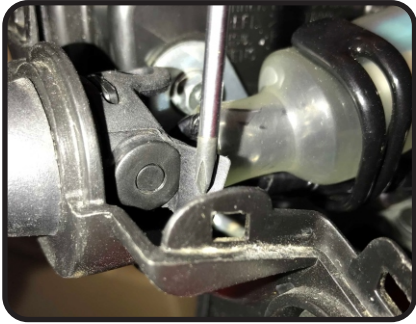

4. Repeat step 3 for opposite side.

Installation

1. Install aftermarket turn signal, turn signal adapter plate, 8MMWASHERXL, and turn signal nut to the lower taillight cover as shown.

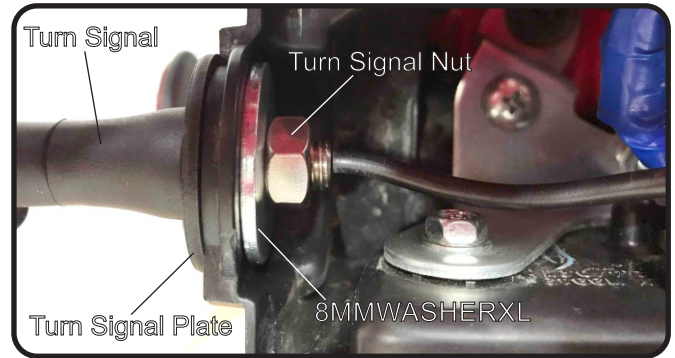

2. Repeat step 1 for opposite side.
3. Re-connect turn signal connectors.

Note¹: 073BG-HON turn signal adapter wires are available for purchase separately for direct plug-and-play alternative with Yoshimura LED turn signals.

Note²: A diode and relay will be required for proper function of turn signals and is sold separately.

4. Re-install upper taillight cover using opposite steps of removal.
5. Check for proper function of turn signals and that all components are secure prior to riding.

