



YOSHIMURA

RESEARCH&DEVELOPMENT OF AMERICA,

5420 DANIELS STREET STE A, CHINO CA., 91710 · (800) 634-9166 · (909) 628-4722 · FAX (909) 591-2198

www.yoshimura-rd.com

MICRO TURN SIGNAL ADAPTER PLATES

Suzuki GSX-8S 074BG117201

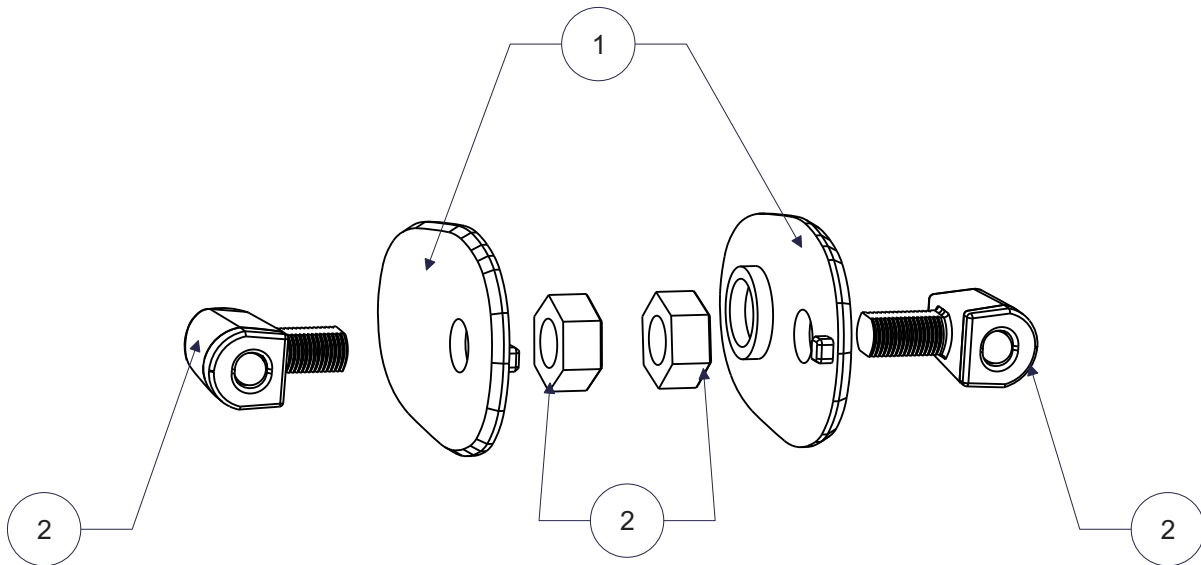

No.	Item	Description	Qty.
1	074BG117201-B	Front Turn Signal Plate	2
2	072BGMICRTSR	YRD Micro Combo LED Turn Signal Kit	1

Removal

1. Locate and disconnect both the turn signals and running lights located on the headlight cowl.
2. Remove headlight cowl. (2 black screws, 2 silver screws, 2 push pins, 2 flat push pins.)

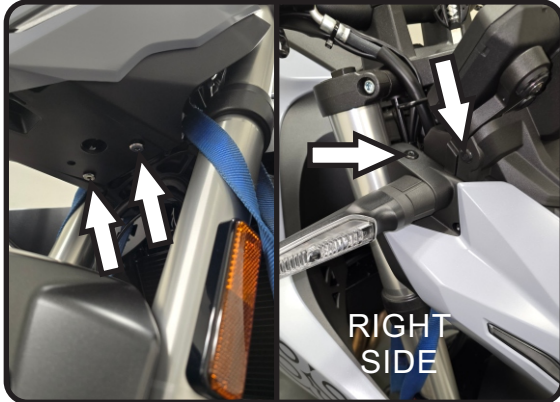

3. Remove turn signals from headlight cowl.
4. Cut the stock turn signal wires 4" from the male connector of the stock turn signal wire, not the harness.

Installation

1. Place the micro turn signal in *074BG117201-B*, front turn signal plate and orient facing the front of the bike. Insert *074BG117201-B*, turn signal plate into the turn signal holder and secure using plastic hex nut.

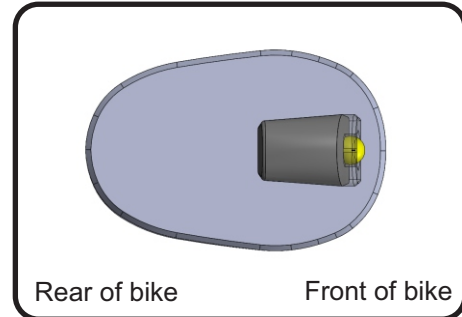

RIGHT SIDE EXAMPLE SHOWN

2. Using the solder shrink connectors supplied in the micro turn signal kit, connect turn signal wires to micro light wires as follows:

Right (Black Connector):

Black and White - Black
Green - Blue

Left (Red Connector):

Black and White - Black
Black - Blue

- a) Strip the stock turn signal wire ends 1/4" - 1/2" and insert into *BN-SSS-22-18*, solder shrink connectors provided in the kit.
- b) Center the spliced wire ends in the middle and using a heat gun or lighter, apply heat evenly on the outer edges of the solder shrink connector to shrink and hold wires in place.
- c) Making sure that the stripped ends are centered, heat the center of the solder shrink connector evenly until the solder begins to liquify.
- d) Allow to cool completely and tug both ends of the wires to verify that connection is secured.

Scan the QR code below for link to solder shrink connector instruction video.



Scan QR code on the micro turn signal packaging for wiring diagram.

Note¹: The white running light wire and red brake light wire on the micro signals will not be used. Bundle back up and tuck away.

Note²: A red front light is prohibited in most states. Check with local laws and regulations prior to installation.

3. Reinstall the headlight cowl using reverse steps of removal.
4. Re-connect turn signals and running light connectors.
5. Check for proper function of turn signals and that all components are secure prior to riding.