



# YOSHIMURA

RESEARCH&DEVELOPMENT OF AMERICA, INC.

5420 DANIELS STREET STE A, CHINO CA., 91710 · (800) 634-9166 · (909) 628-4722 · FAX (909) 591-2198

[www.yoshimura-rd.com](http://www.yoshimura-rd.com)

## MICRO TURN SIGNAL ADAPTER PLATES

### Yamaha WR 125R 074BG131250

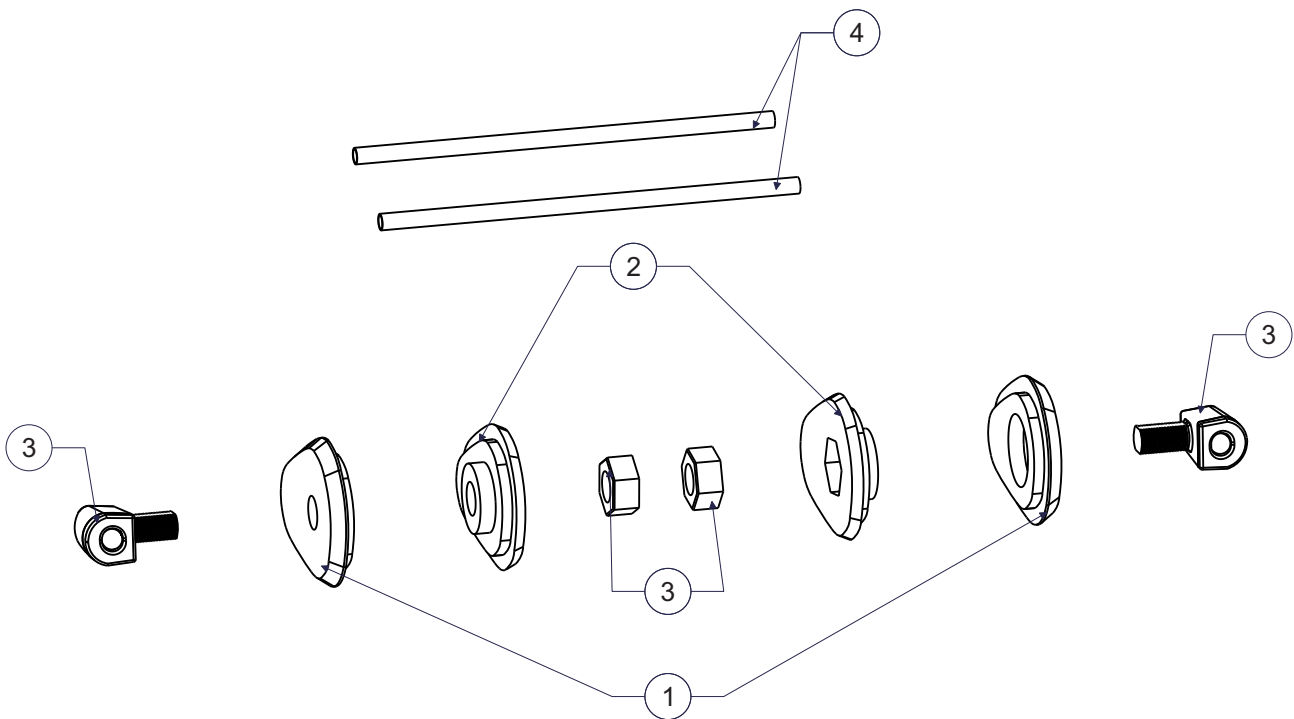

No.	Item	Description	Qty.
1	074BG131250-OUT	Turn Signal Plate	2
2	074BG131250-IN	Metal Inner Plate	2
3	072BGMICRTSR	YRD Micro Combo LED Turn Signal Kit	1
4	125-325	Heat Shrink Tube	2

## Removal

1. Remove the headlight cowl (4 bolts, 2 on each side).



Note: Must disconnect the daytime running light wire to fully remove the headlight cowl as shown below.

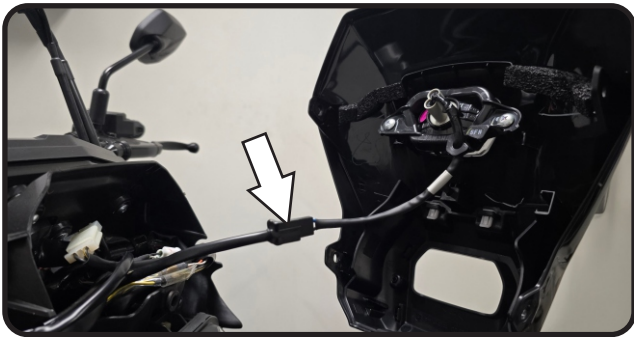

2. Locate and disconnect the turn signal connectors.
3. Remove the turn signals from the turn signal holder.

## Installation

1. Feed the micro turn signal wires through 125-325, heat shrink until it reaches the turn signal stem.
2. Using a heat gun or lighter, apply heat evenly to 125-325, heat shrink until it contracts.
3. Place the micro turn signal in the hole of the outer turn signal plate and slot into the turn signal holder.
4. Place the inner turn signal plate on the inside of the turn signal holder and secure the turn signal with the plastic nut.

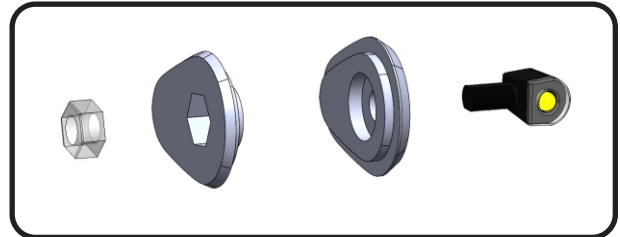
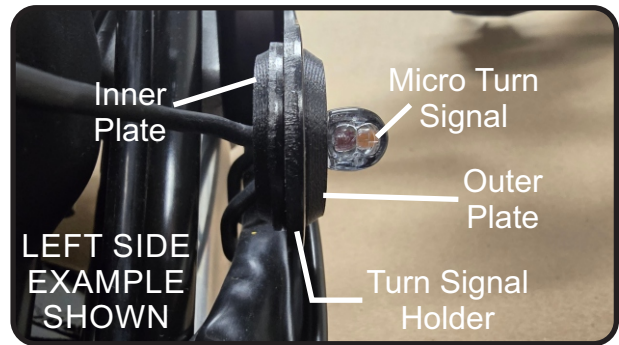

### LEFT SIDE EXAMPLE SHOWN

Note: Proper positioning of the micro turn signal in the adapter plate is dependent on the orientation of the plastic hex nut. If the turn signal is not facing forwards, rotate the plastic hex nut in the adapter plate pocket and re-install until the turn signal is facing forward.

5. Using the solder shrink connectors supplied in the micro turn signal kit, connect turn signal wires to micro light wires as follows:

#### Right (Black Connector):

Black - Black (Micro LED)  
Green - Blue (Micro LED)

#### Left (Gray Connector):

Black - Black (Micro LED)  
Brown - Blue (Micro LED)

- a) Strip the stock turn signal wire ends 1/4" - 1/2" and insert into *BN-SSS-22-18*, solder shrink connectors provided in the kit.
- b) Center the spliced wire ends in the middle and using a heat gun or lighter, apply heat evenly on the outer edges of the solder shrink connector to shrink and hold wires in place.
- c) Making sure that the stripped ends are centered, heat the center of the solder shrink connector evenly until the solder begins to liquify.
- d) Allow to cool completely and tug both ends of the wires to verify that connection is secured.

Scan for link to solder shrink connector instruction video.



Scan QR code on micro turn signal packaging for wiring diagram.

Note<sup>1</sup>: The white running light wire and red brake light wire on the micro signals will not be used. Bundle back up and tuck away.

Note<sup>2</sup>: A red front light is prohibited in most states. Check with local laws and regulations prior to installation.

6. Re-connect turn signal connectors and daytime running light.
7. Re-install the headlight cowl.

**IMPORTANT NOTE:**

**\*\**RLYG2***, flasher relay is recommended for proper turn signal flash and is sold separately. Please see the appendix below for turn signal relay installation.

**\*\* [Turn Signal Relay Installation](#) \*\***