



YOSHIMURA

RESEARCH&DEVELOPMENT OF AMERICA, INC.

5420 DANIELS STREET STE A, CHINO CA., 91710 · (800) 634-9166 · (909) 628-4722 · FAX (909) 591-2198

www.yoshimura-rd.com

MICRO TURN SIGNAL ADAPTER PLATES

Yamaha MT-03 074BG133300

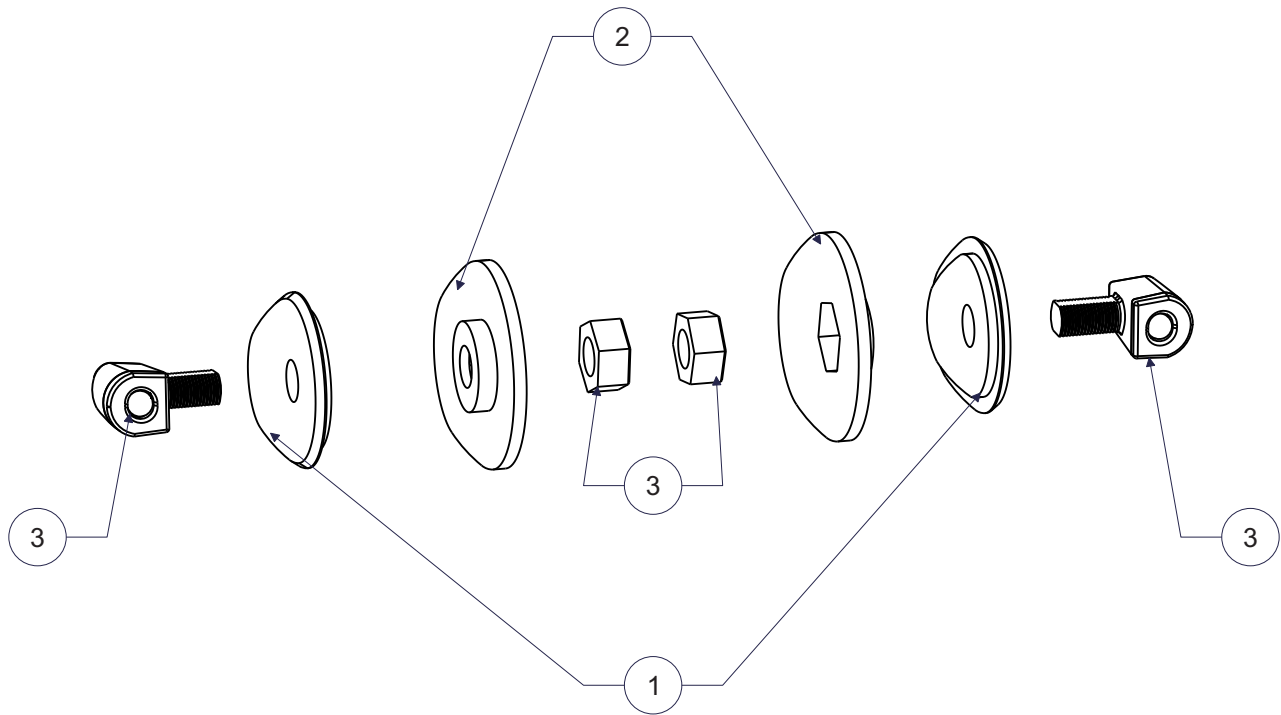

No.	Item	Description	Qty.
1	074BG133300-Out	Outside Front Turn Signal Plate	2
2	074BG133300-In	Inside Front Turn Signal Plate	2
3	072BGMICRTSR	YRD Micro Combo LED Trn Sgn Kit	1

Removal

1. Remove the meter cover.
2. Disconnect and remove the meter display assembly (3 screws).
3. Locate and disconnect turn signal connectors and remove turn signals from turn signal holders.
4. Cut the turn signal wires 4" from the turn signal connector, not the wiring harness.

Installation

1. Place the micro turn signal in the hole of the outer turn signal plate and slot into the turn signal holder.
2. Place the inner turn signal plate on the inside of the turn signal holder and secure the turn signal with the plastic nut.

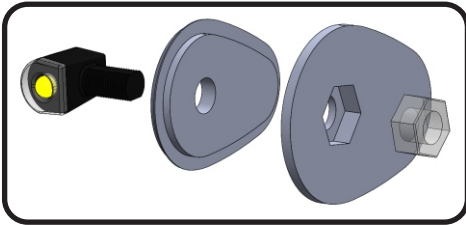

RIGHT SIDE EXAMPLE SHOWN

Note: Proper positioning of the micro turn signal in the adapter plate is dependent on the orientation of the plastic nut. If the turn signal is not facing forwards, rotate the plastic nut in the inner adapter plate pocket and try again until the turn signal is facing forward.

Using the solder shrink connectors supplied in the micro turn signal kit, connect turn signal wires to micro light wires as follows:

Black (Stock signal wire) - Black
Brown (Stock signal wire) - Blue

- a) Strip the stock turn signal wire ends 1/4" - 1/2" and insert into *BN-SSS-22-18*, solder shrink connectors provided in the kit.
- b) Center the spliced wire ends in the middle and using a heat gun or lighter, apply heat evenly on the outer edges of the solder shrink connector to shrink and hold wires in place.

c) Making sure that the stripped ends are centered, heat the center of the solder shrink connector evenly until the solder begins to liquify.

d) Allow to cool completely and tug both ends of the wires to verify that connection is secured.

Scan the QR code below for link to solder shrink connector instruction video.

Note: Daytime Running Light functionality will be lost with the micro turn signals.



Scan QR code on the micro turn signal packaging for the wiring diagram.

Note¹: The white running light wire and red brake light wire on the micro signals will not be used. Bundle back up and tuck away.

Note²: A red front light is prohibited in most states. Check with local laws and regulations prior to installation.

3. Re-connect the turn signal connector to the wiring harness.
4. Repeat steps for the opposite side.
5. Reinstall the meter display assembly and meter cover using the reverse steps of removal.
6. Check for proper function of turn signals and that all components are secure prior to riding.