



# YOSHIMURA

RESEARCH&DEVELOPMENT OF AMERICA, INC.

5420 DANIELS STREET STE A, CHINO CA., 91710 · (800) 634-9166 · (909) 628-4722 · FAX (909) 591-2198

[www.yoshimura-rd.com](http://www.yoshimura-rd.com)

## MICRO TURN SIGNAL ADAPTER PLATES

### *Kawasaki KLE 500* **074BG145000**

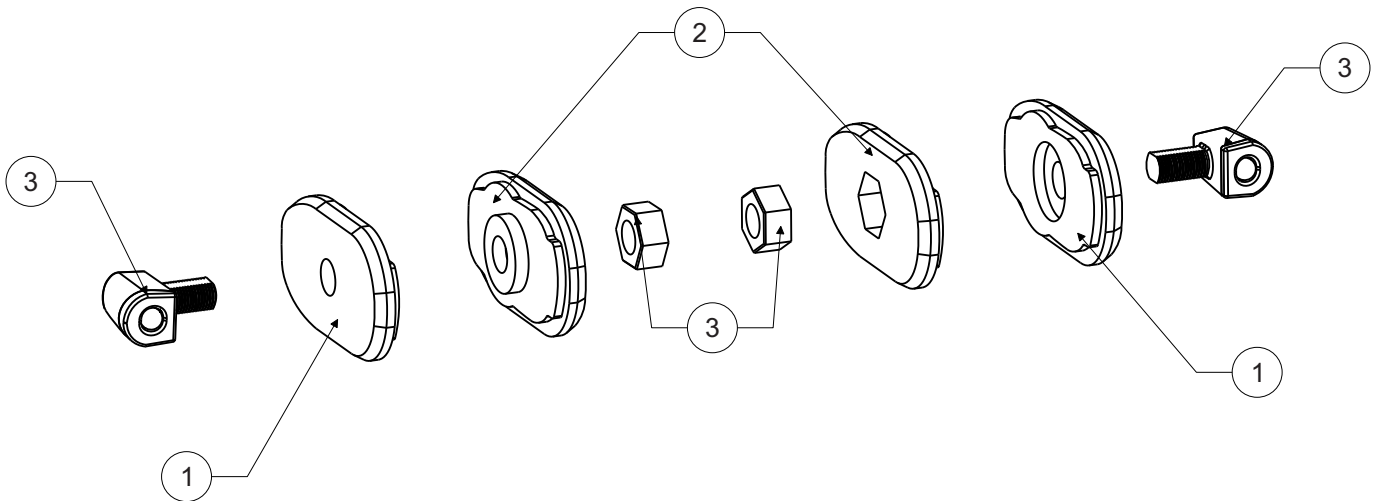

No.	Item	Description	Qty.
1	074BG145000-OUT	Turn Signal Plate	2
2	074BG145000-IN	Turn Signal Inner Plate	2
3	072BGMICRTSR	YRD Micro Combo LED Turn Signal Kit	1

## Removal

1. Remove the center and side windscreens indicated below.

Note: Micro LED turn signals shown installed.



2. Remove the left and right tank fairings.
3. Remove the left and right side fairings.
4. Locate and disconnect the turn signal connectors.
5. Remove the headlight cowl.
6. Remove the stock turn signals from the turn signal holders.
7. Cut the turn signal wires 4" from the turn signal connector, not the wiring harness.

## Installation

1. Insert *072BGMICRTSR*, micro turn signal into *074BG145000-OUT*, turn signal outer plate and slot into the cowling's turn signal holder. Install *074BG145000-IN*, inner plate on the inside of the turn signal holder and secure the assembly with the plastic hex nut.

Note: Proper positioning of the micro turn signal in the adapter plate is dependent on the orientation of the plastic hex nut. If the turn signal is not facing forwards, rotate the plastic hex nut in the adapter plate pocket and re-install until turn signal is facing forward.

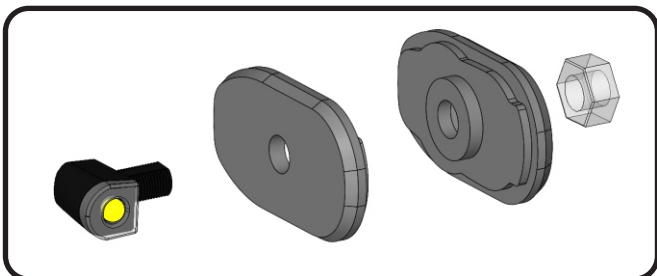

RIGHT SIDE EXAMPLE SHOWN

2. Repeat steps for the opposite side.
3. Using the solder shrink connectors supplied in the micro turn signal kit, connect turn signal wires to micro light wires as follows:

### Right (Blue Connector):

Black and Yellow - Black (Micro LED)  
Gray - Blue (Micro LED)

### Left (Black Connector):

Black and Yellow - Black (Micro LED)  
Green - Blue (Micro LED)

- a) Strip the stock turn signal wire ends 1/4" - 1/2" and insert into *BN-SSS-22-18*, solder shrink connectors provided in the kit.
- b) Center the spliced wire ends in the middle and using a heat gun or lighter, apply heat evenly on the outer edges of the solder shrink connector to shrink and hold wires in place.
- c) Making sure that the stripped ends are centered, heat the center of the solder shrink connector evenly until the solder begins to liquify.
- d) Allow to cool completely and tug both ends of the wires to verify that connection is secured.

Scan for link to solder shrink connector instruction video.



Scan QR code on micro turn signal packaging for wiring diagram.

Note<sup>1</sup>: The white running light wire and red brake light wire on the micro signals will not be used. Bundle back up and tuck away.

Note<sup>2</sup>: A red front light is prohibited in most states. Check with local laws and regulations prior to installation.

4. Reinstall the upper headlight cowling with turn signals installed and connect turn signal connectors.

5. Check for proper function of turn signals and that all components are secure prior to riding. Adjust turn signal rotation as needed and tighten turn signal nut.

**IMPORTANT NOTE:**

\*\* *RLYG2*, flasher relay is recommended for proper turn signal flash and is sold separately. Please see the appendix below for turn signal relay installation.

\*\* [Turn Signal Relay Installation](#) \*\*