



YOSHIMURA

RESEARCH&DEVELOPMENT OF AMERICA, INC.

5420 DANIELS STREET STE A, CHINO CA., 91710 · (800) 634-9166 · (909) 628-4722 · FAX (909) 591-2198

www.yoshimura-rd.com

FENDER ELIMINATOR KIT

075BG117200
Suzuki GSX-8S

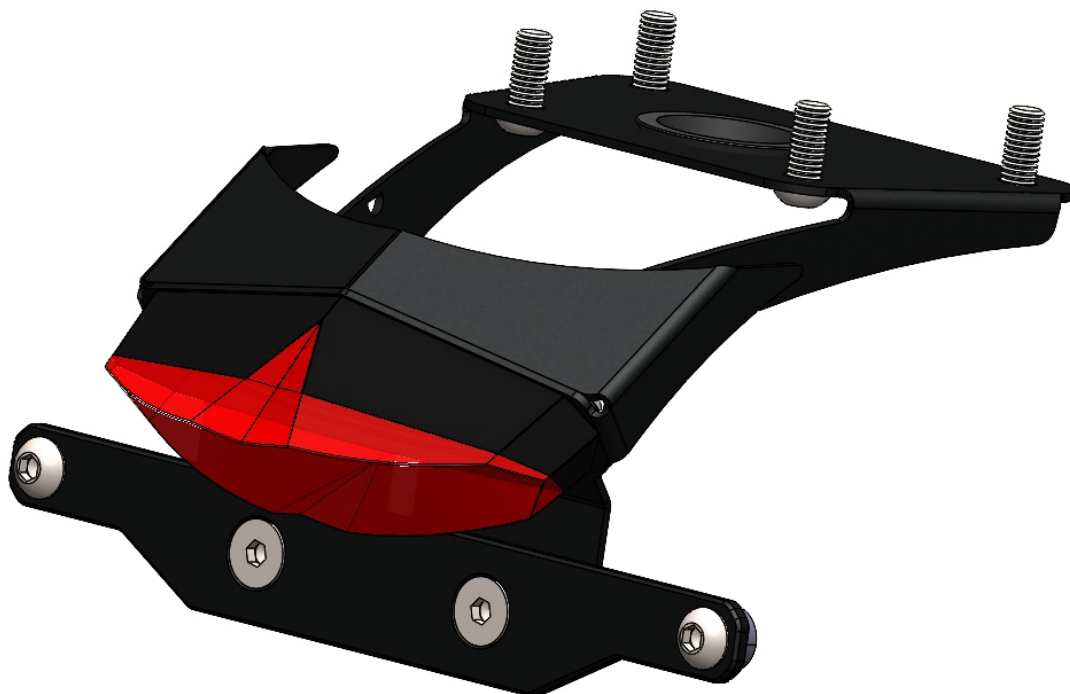

THIS PRODUCT IS NOT DOT APPROVED.

Yoshimura R&D of America, Inc. is not liable or responsible for any resulting event caused by the installation of this product. Check with local laws and regulations for compliance prior to installation and use. This product is not intended for use on public highways.



x1



11720-FEBKT1
Fender Eliminator Bracket

x1

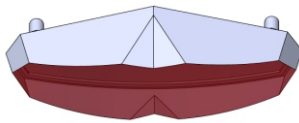

HB025024-E
Tail Light

x1



FE-LP-BKT
License Plate Bracket

x1

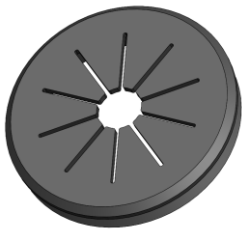

H-2158T
Wire Debris Cover

x2



M6X12FS
6mm x 12mm
Flat Head Allen Screw

x4



M6X10BHS
6mm x 10mm
Button Head Screw

x4



M6X14BHS
6mm x 14mm
Button Head Screw

Assembly Diagram

x2

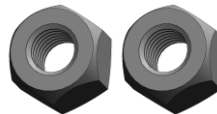

6MMLN-SS
6mm Nylon Lock Nut

x2



6MMWASHER-SS
6mm Stainless Washer

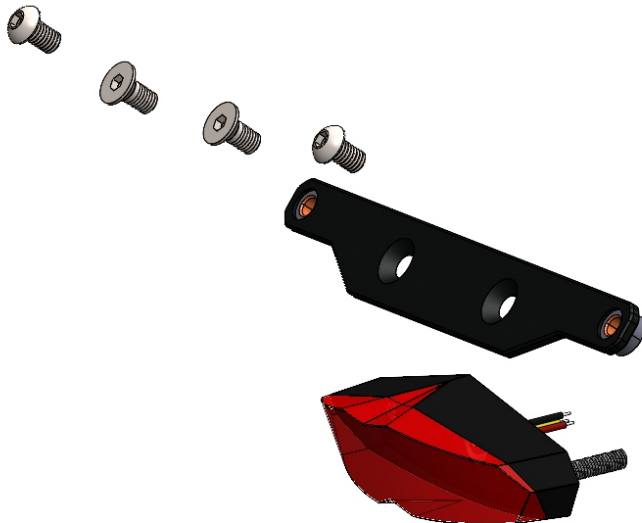

Button head screws, washers, and lock nuts are for the bottom two license plate holes.

IMPORTANT NOTE:

This kit does not include turn signal brackets to install OEM or aftermarket turn signals.

Ensure you have all necessary components prior to beginning installation.

Removal

1. Remove passenger seat.
2. Locate and disconnect license plate light and turn signal connectors.
3. While securely supporting the stock fender assembly, remove the four bolts securing the fender assembly to the frame. Carefully remove the stock fender assembly making sure not to damage the connectors in the process.
4. Disassemble the stock fender assembly and remove the left and right turn signals.

Installation

1. Install *FE-LP-BKT*, license plate bracket onto *11720-FEBKT1*, fender bracket using *M6X12FS*, flat head allen screws.

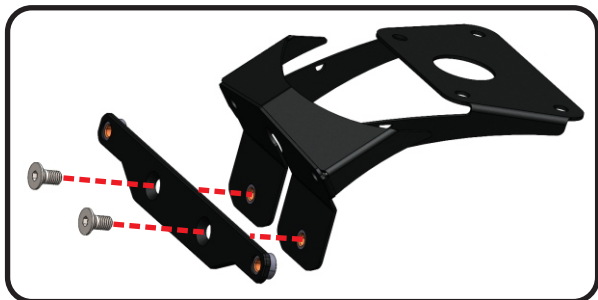

2. Install *HB025024-E*, tail light to *11720-FEBKT1*, fender bracket using the tail light nuts.

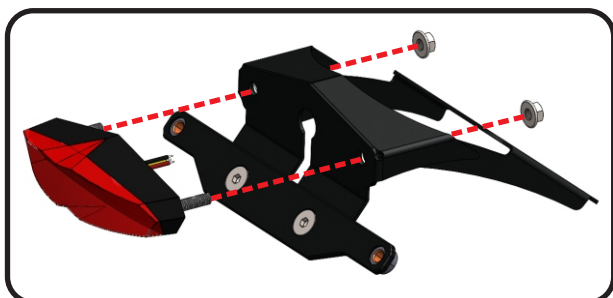

3. Install *H-2158T*, wire cover into *11720-FEBKT1*, fender bracket.

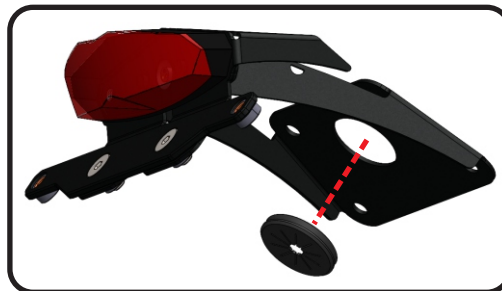

4. Install assembled fender eliminator by routing license plate light and turn signal wires through *H-2158T*, wire cover on fender eliminator bracket and through under-tail. Secure fender bracket to frame using *M6X14BHS*, button head screws. Torque to factory specification.

Note: *M6X10BHS*, button head screws, will be used to secure the license plate to *FE-LP-BKT*, license plate bracket. *6MMLN-SS*, nylon lock nuts and *6MMWASHER-SS*, washers are for the bottom license plate holes.

5. Route wires in stock location and re-connect license plate light and turn signal connectors.
6. Re-install passenger seat.
7. Check for proper function of license plate light, turn signals, brake light, and that all brackets and components are secure prior to riding.